

RAINWATER GARDEN AND ROCK INFILTRATION SUMP PLAN VIEW

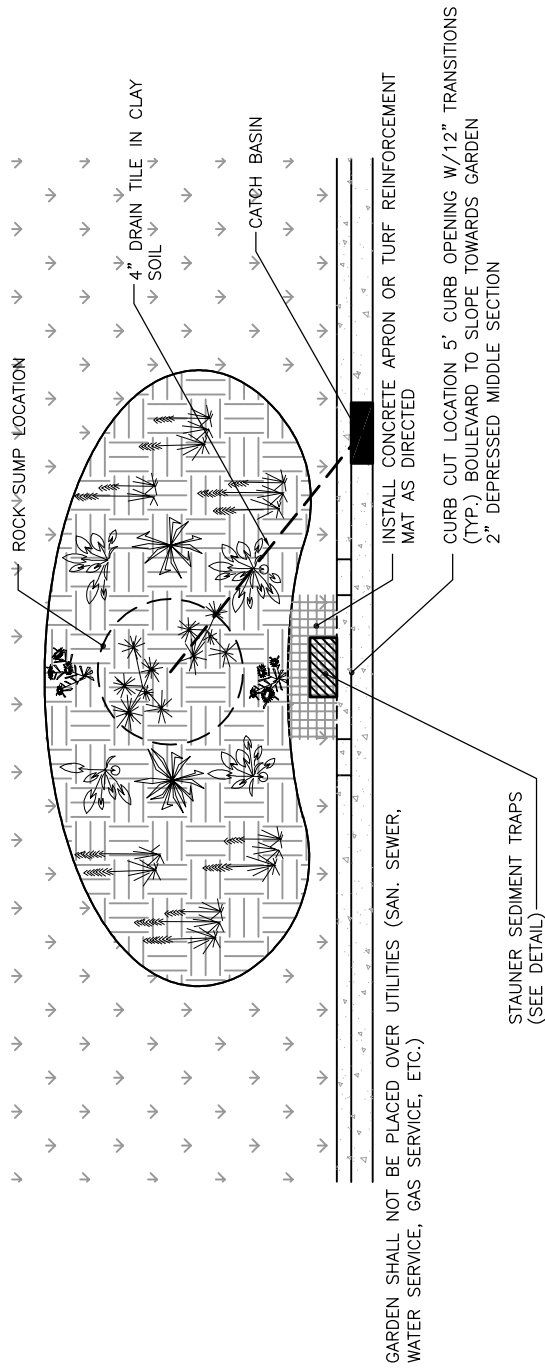

GARDEN SHALL NOT BE PLACED OVER UTILITIES (SAN. SEWER, WATER SERVICE, GAS SERVICE, ETC.)

STAINER SEDIMENT TRAPS
(SEE DETAIL)

CURB CUT LOCATION 5' CURB OPENING W/12" TRANSITIONS (TYP.) BOULEVARD TO SLOPE TOWARDS GARDEN 2" DEPRESSED MIDDLE SECTION

INSTALL CONCRETE APRON OR TURF REINFORCEMENT MAT AS DIRECTED

RAINWATER GARDEN AND ROCK INFILTRATION SUMP DETAIL

NOTE: C&G BACKFILL IN 2.5' INCREMENTS FOR SODDING PURPOSES TO MATCH R/W AND GARDEN WIDTHS.

TYPICAL RAINWATER GARDEN SIZES		
8' X 16'	10' X 20'	12' X 24'

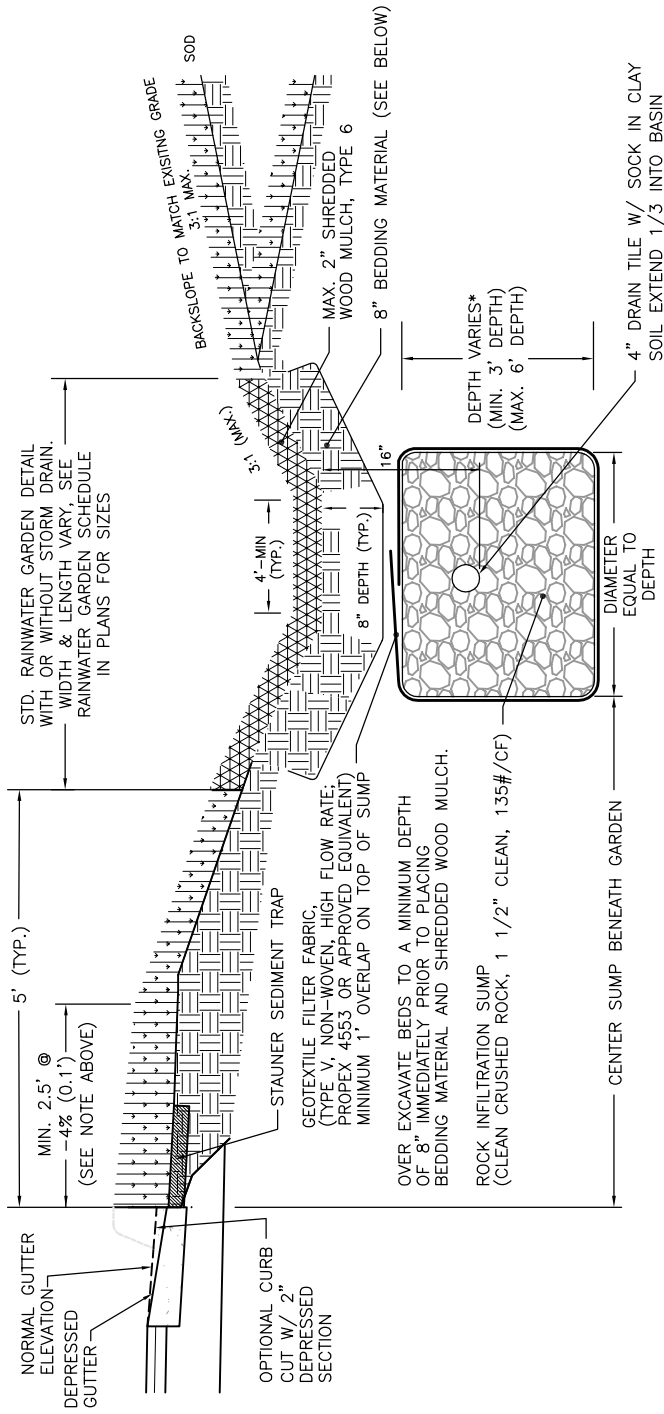

RAINWATER GARDEN PREPARATION

EXCAVATE GARDEN AREA TO ACCOMMODATE PLACEMENT OF 8" OF BEDDING MATERIAL.
EXCAVATE & INSTALL ROCK INFILTRATION SUMP w/GEOTEXTILE FILTER FABRIC.
FILTER FABRIC SHALL COMPLETELY ENVELOPE ROCK SUMP.
SCARIFY GARDEN AREA PRIOR TO PLACEMENT OF BEDDING MATERIAL.
PLACE A MINIMUM 8" OF BEDDING MATERIAL.
PLACE MAX. 2" SHREDDED WOOD MULCH, (MULCHING MATERIAL TYPE 6.)

*HIGH PERMEABILITY SOILS (SAND) - 3' DEPTH
LOW PERMEABILITY SOILS (CLAY) - 6' DEPTH
BEDDING MATERIAL FOR GARDEN
AREAS SHALL BE APPROXIMATELY
50% SALVAGED IN SITU TOPSOIL
50% CLEAN ORGANIC COMPOST (GRADE 2)
IMPORTED TOPSOIL BORROW MAY NOT BE USED IN GARDEN AREAS.

SOURCE: DETAIL PROVIDED BY CITY OF MAPLEWOOD—MINNESOTA ENGINEERING DEPARTMENT.

Wenck
 © Wenck Associates, Inc.
 Consulting Engineers
 1800 PIONEER CREEK CENTER
 MAPLE PLAIN, MN 55359
 Web Site: www.wenck.com
 763-479-4200
 763-479-4242

CLIENT

SHINGLE CREEK/WEST
MISSISSIPPI WATERSHED
COMMISSION

PROJECT

RAIN GARDEN

SHEET
TITLE

REV DWN APP REV DATE

A CVE EAM 02-11-09

DWN BY CHK'D

CVE EAM

APP'D

EAM

DWG DATE FEB. 2009

SCALE NOT TO SCALE

PROJECT NO.

SHEET NO.

FIGURE 1

REV NO.

A