

3235 Fernbrook Lane N • Plymouth, MN 55447
Tel: 763.553.1144 • Fax: 763.553.9326
Email: judie@jass.biz • Website: www.shinglecreek.org

September 7, 2023

Commissioners
Shingle Creek and West Mississippi
Watershed Management Commissions
Hennepin County, Minnesota

*The agenda and meeting packets are available on the
Commission's web site.*

<http://www.shinglecreek.org/minutes--meeting-packets.html> and <http://www.shinglecreek.org/tac-meetings.html>

Dear Commissioners:

Regular meetings of the Shingle Creek and West Mississippi Watershed Management Commissions will be held Thursday, September 14, 2023, at Plymouth Community Center, 14800 34th Avenue North, Plymouth, MN. Lunch will be served at 12:00 noon and the meetings will convene concurrently at 12:45.

The Commissions will suspend their regular meetings at 12:45 p.m. for the purpose of conducting a public hearing on seven improvement projects, five in the Shingle Creek watershed and two in the West Mississippi watershed

The regular meeting will resume immediately after the public hearings conclude.

The Technical Advisory Committee (TAC) **WILL NOT MEET** this month.

Please make your meal choice from all of the items below and email me at judie@jass.biz to confirm your attendance and your meal selection by **noon, Tuesday, September 12, 2023**. Thank you.

Regards,

Judie A. Anderson, Administrator

cc: Alternate Commissioners Member Cites Troy Gilchrist TAC Members
Stantec Consulting Services BWSR MPCA HCEE

Z:\Shingle Creek\Meetings\Meetings 2023\09_Notice_Regular Meeting and Public Hearing.docx

Order your deli sandwich box lunch. Sandwiches come with lettuce, tomato and mayo. As an alternative you may specify your sandwich with **wheat bread or as an **unwich** (lettuce wrapped).**

- | | |
|---|-------------------------|
| 1 Pepe – Ham and cheese | 2 Big John – Roast beef |
| 3 Totally Tuna – Tuna salad and cucumber | 4 Turkey Tom – Turkey |
| 5 Vito – salami, capocollo, cheese, onion, oil and vinegar, oregano-basil (no mayo) | |
| 6 The Veggie – double cheese, avocado spread, cucumber | |
| 14 Bootlegger Club – Roast beef and turkey | |

**Please also indicate: your cookie preference: Chocolate Chip or Oatmeal Raisin
and your beverage preference: (W) Water (C) Coke (DC) Diet Coke (S) Sprite (N) None**

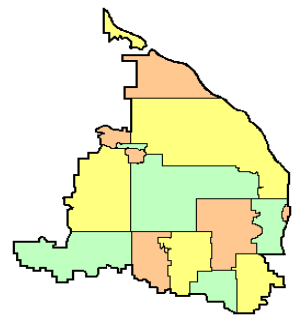

3235 Fernbrook Lane N • Plymouth, MN 55447
Tel: 763.553.1144 • Fax: 763.553.9326
Email: judie@jass.biz • Website: www.shinglecreek.org

A combined regular meeting of the Shingle Creek (SC) and West Mississippi (WM) Watershed Management Commissions will be convened Thursday, September 14, 2023, at 12:45 p.m. Agenda items are available at <http://www.shinglecreek.org/minutes--meeting-packets.html>. *Black typeface denotes SCWM items, blue denotes SC items, green denotes WM items.*

PUBLIC HEARING. The Commissions will suspend their regular meetings at 12:45 p.m. for the purpose of conducting a public hearing on five Shingle Creek and two West Mississippi improvement projects.

A G E N D A

September 14, 2023

1. Call to Order.
 - SCWM a. Roll Call.
 - ✓ SCWM b. Approve Agenda.*
 - ✓ SCWM c. Approve Minutes of Last Meeting.*
 2. Reports.
 - ✓ SC a. Treasurer's Report and Claims** - voice vote.
 - ✓ WM b. Treasurer's Report and Claims** - voice vote.
- Suspend regular meetings.*
- SCWM 3. Public Hearing for 2023 Capital Improvement Projects.
 - SCWM a. Staff Report.*
 - SCWM b. Commission discussion.
 - SCWM c. Open Public Meeting.
 - SCWM 1) Receive Written Comments.
 - SCWM 2) Receive Comments from Public.
 - SCWM d. Close Public Hearing.
 - SCWM e. Commission Discussion.
 - ✓ SC f. Consider Resolution SC2023-02.*
 - ✓ WM g. Consider Resolution WM2023-02.*
 - SC h. Approve Cooperative Agreements.
 - ✓ SC 1) Brookdale Park Natural Channel, Phase 1.*
 - ✓ SC 2) Pike Lake Stabilization Project.*

Resume regular meetings.

- SCWM 4. Open forum.
5. Project Reviews.
 - ✓ SC a. S2023-06 Project Libre, Maple Grove.* (over)

- 6. Water Quality.
 - ✓ SC a. Brookdale Park Shingle Creek Remeander –Public Engagement.*
 - ✓ WM b. Cost Share Project – Mississippi Gateway.
 - 1) Request.*
 - 2) Application.*
- 7. Grant Opportunities.
- 8. Education and Public Outreach.
 - SCWM a. Next WMWA meeting – via zoom. 8:30 a.m., Tuesday, October 10, 2023.
- SCWM 9. Communications.
- SCWM a. Communications Log.*
- b. Staff Report.*
 - 1) Highway 252/94 EIS Review. 2) Meadow Lake.
 - 3) Legal Boundary Update. 4) Eagle Lake SWA.
 - 5) Gaulke Pond SWA. 6) SC Brookdale Park Remeander.
 - 7) SC Trail Bank Stab., Fish Access 8) Miss. Riverbank Stab. Feas. Study
- SCWM 10. Other Business.
 - a. Watershed Tour.*
- SCWM 11. Adjournment.

Z:\Shingle Creek\Meetings\Meetings 2023\09 Agenda Regular meeting and Public Hearing.docx
 * In meeting packet or emailed ** Supplemental email / Available at meeting
 Previously transmitted * Available on website ✓ Item requires action

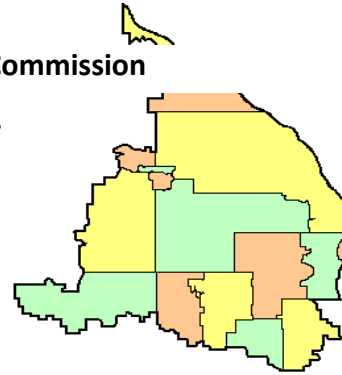

**REGULAR MEETING
MINUTES | August 10, 2023**

(Action by the SCWMC appears in blue, by the WMWMC in green and shared information in black.
*indicates items included in the meeting packet.)

I. A joint meeting of the Shingle Creek Watershed Management Commission and the West Mississippi Watershed Management Commission was called to order by Shingle Creek Chairman Andy Polzin at 12:45 p.m. on Thursday, August 10, 2023, at Plymouth Community Center, 14800 34th Avenue North, Plymouth, MN.

Present for Shingle Creek: Greg Spoden, Brooklyn Park; Randy Bergstrom, Crystal; Karen Jaeger, Maple Grove; Ray Schoch, Minneapolis; Bill Wills, New Hope; John Roach, Osseo; Andy Polzin, Plymouth; Wayne Sicora, Robbinsdale; Diane Spector, Todd Shoemaker, and Dendy Lofton, Stantec; Troy Gilchrist, Kennedy & Graven; and Judie Anderson, JASS. Not represented: Brooklyn Center.

Present for West Mississippi: Melissa Collins, Brooklyn Park; Gerry Butcher, Champlin; Karen Jaeger, Maple Grove; John Roach, Osseo; Diane Spector, Todd Shoemaker, and Dendy Lofton, Stantec; Troy Gilchrist, Kennedy & Graven; and Judie Anderson, JASS. Not represented: Brooklyn Center.

Also present were: James Soltis, Brooklyn Center; Mitch Robinson, Brooklyn Park; Ben Perkey, Crystal; Mark Lahtinen, Maple Grove; Bob Grant and Nick Macklem, New Hope; James Kelly, Osseo; Amy Riegel, Plymouth; and Wendy Scherer, Richard McCoy and Mike Sorenson, Robbinsdale.

Present for Open Forum was Hildania Kristensen, Plymouth.

II. **AGENDAS AND MINUTES.**

Motion by Schoch, second by Jaeger to approve the **Shingle Creek agenda**.* *Motion carried unanimously.*

Motion by Butcher, second by Roach to approve the **West Mississippi agenda**.* *Motion carried unanimously.*

Motion by Spoden, second by Schoch to approve the **minutes of the July 13, 2023, regular meeting**.* *Motion carried unanimously.*

Motion by Roach, second by Jaeger to approve the **minutes of the July 13, 2023, regular meeting**.* *Motion carried unanimously.*

III. **FINANCES AND REPORTS.**

A. Motion by Schoch, second by Jaeger to approve the Shingle Creek **August Treasurer's Report**,* and claims totaling \$53,424.10. Voting aye: Spoden, Orred, Jaeger, Schoch, Wills, Roach, Polzin, and Sicora; voting nay: none; absent: Brooklyn Center.

B. Motion by Butcher, second by Roach to approve the **West Mississippi August Treasurer's Report*** and claims totaling \$16,671.11. Voting aye: Collins, Butcher, Jaeger, and Roach; voting nay: none; absent: Brooklyn Center.

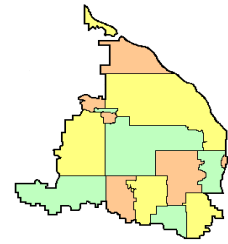

IV. OPEN FORUM.

Ms. Kristensen was present to discuss a number of issues. (1) She wanted to know the status of the adjusted Shingle Creek legal boundary. She was informed that the Commission has completed a review of the boundary and remapped the boundary to follow current topography and drainage paths more accurately. The revised legal boundary is under review with Hennepin County now. (2) She wanted to know the status of her lot combination and requested the Commission to expedite this. Riegel recommended that she reach out to the City of Plymouth Planning Department for that information. (3) Kristensen raised concerns about expansive clay soils and related health issues and stated that the City of Plymouth has failed to address this as required. (4) She also expressed interest in having the Commission do a project at her property. Because the City of Plymouth is already involved in active litigation with Kristensen, the City will not be responding to her directly.

V. OLD BUSINESS.

VI. NEW BUSINESS.

A. Project Review SC2023-07 Project Black Bear, Maple Grove.* Construction of an office building, lab, and extension of existing Revere Lane and 73rd Place on approximately 44.8 acres located northwest of the Highway 169 and I-94/694 Interchange. Following development, the site will be 80 percent impervious with 35.8 acres of impervious surface, an increase of approximately 30.0 acres. A complete project review application was received on July 26, 2023.

Commission rules require the site to infiltrate 1.1 inches of runoff from new impervious area within 48 hours. The site is located within the Maple Grove Gravel Mining Area. In 2010, the Commission reviewed and approved a plan by the City of Maple Grove to obtain infiltration credits for this new development by constructing biofiltration basins adjacent to four existing regional stormwater ponds. Stormwater from areas that developed prior to the infiltration rule is directed to these basins. The Commission agreed that these new infiltration basins are adequate to provide regional infiltration for the 553 acres of “undeveloped area” (SC2010-04). The subject project is located within the “undeveloped area” and, therefore, meets Commission volume control treatment requirements. To obtain sustainability credits, the applicant proposes to infiltrate runoff from new impervious area directed to the southwestern pond.

To comply with the Commission’s water quality treatment requirement, the site must provide treatment so there is no net increase in TP or TSS from pre- to post-development land cover. Runoff from the site is proposed to be routed through multiple BMPs on site. The northern portion of the site is routed to a NURP pond. The southwestern portion is routed to an irrigation re-use pond that outlets to a pond with an infiltration bench that receives runoff from the rest of the site. The applicant has provided existing load calculations using the MPCA Loading calculator and a MIDS model for proposed conditions. The applicant meets Commission water quality treatment requirements.

Commission rules require that site runoff is limited to predevelopment rates for the 2-, 10-, and 100-year, 24-hour, and 100-year, 10-day critical storm event. Runoff from the site is routed through three stormwater ponds. The site discharge points are southeast to an existing storm pipe that flows to Eagle Lake and then south to the I-94 ditch. Design or model revisions are necessary to understand if rate control is met at the southwest discharge point. The applicant does not meet Commission rate control requirements.

The erosion control plan includes a rock construction entrance, perimeter silt fence/biolog, inlet protection, rip rap at inlets, slope checks, silt fence surrounding detention ponds/infiltration basins, and

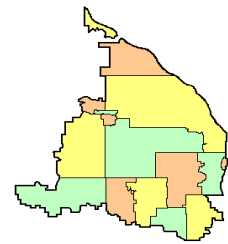

native seed specified on the pond slopes. The erosion control plan meets Commission requirements.

The National Wetlands Inventory identifies one wetland in the center of the site. The City of Maple Grove is the LGU for Wetland Conservation Act administration and applied for a no-loss application for this and other wetlands within the GMA. The Technical Evaluation Panel (TEP) reviewed the application and determined "...based on aerial photo review from 1940-2023 that the GMA undergoes extensive excavation, dewatering, stockpiling, and reclamation processes and that basins in the GMA historically and currently undergo conversion and manipulation and meet the definition of...'nonwetland'." The applicant meets Commission wetland requirements.

There are no Public Waters on-site. The applicant meets Commission Public Waters requirements.

There is no FEMA-regulated floodplain on this site. The low floor elevations of the buildings are at least two feet higher than the high-water elevation of the detention ponds/infiltration basins according to Atlas 14 precipitation. The applicant meets Commission floodplain requirements.

The northwest corner of the site is in a Drinking Water Supply Management Area (DWSMA) but is outside of the Emergency Response Area. The applicant does not propose any infiltration within the DWSMA. The applicant meets Commission drinking water protection requirements.

A public hearing on the project was conducted on May 30, 2023, as part of Planning Commission and City Council review of this project, meeting Commission public notice requirements.

A draft Operations & Maintenance (O&M) agreement between the applicant and the City of Maple Grove was not provided.

Motion by Schoch, second by Jaeger to advise the City of Maple Grove that Project 2023-07 is approved with three conditions:

1. Show that rate control is satisfied at all site discharge locations. Currently, it is not clear if rate control is satisfied at the southwest discharge location. Increase storage or pipe capacity to prevent model errors and show that rate control is satisfied.
2. Provide a complete O&M agreement between the applicant and the City of Maple Grove for all stormwater facilities on the project site.
3. Demonstrate by double ring infiltrometer or witness test that the site can meet the design infiltration rate of 0.8 inches/hour for the infiltration bench.

Motion carried unanimously.

B. 2023 CIP.* The Commissions had previously established maximum proposed levies for the 2023 Capital Improvement Program (CIP). The next step in the process is to call for a public hearing on those projects and programs the Commissions desire to move forward. The final step in the CIP process will be to hold a public hearing on the proposed projects. This should occur at the Commissions' regular September 14, 2023, meeting. At that time the Commissions will formally order the projects and certify levies to Hennepin County. A copy of the legal notice* is included in the meeting packet.

1. Shingle Creek 2023 CIP Projects (2024 levy).

a. Cost Share Fund. This annual project provides cost sharing to retrofit voluntary BMPs on city property. The TAC developed policies and procedures to administer these funds and makes recommendations to the Commission on which projects should be funded. The annual levy is \$100,000,

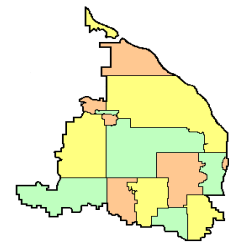

to be matched at least one-to-one by a member city or cities. Applications are open until funds are depleted.

b. Partnership Cost Share Fund. This annual project provides cost sharing to retrofit voluntary BMPs on private property. The TAC developed policies and procedures to administer these funds and makes recommendations to the Commission on which projects should be funded. The annual levy is \$50,000, with no match required. Applications are open year-round until the funds are depleted.

c. Maintenance Fund. This program makes funds available for nonstructural practices such as, but not limited to, rough fish management; invasive aquatic vegetation control; alum treatment touch-up; native aquatic vegetation translocation; and maintenance of Commission- installed projects for which a member City is not specifically responsible.

d. Pike Creek Stabilization. A joint project between the cities of Plymouth and Maple Grove would stabilize eroding streambank along Pike Creek near its discharge point into Pike Lake, and upstream of Hemlock Lane.

e. Brookdale Park Natural Channel Phase 1. This project would remeander about 5,000 feet of Shingle Creek between a drop structure in Brookdale Park and Xerxes Avenue to improve water quality, enhance habitat, and restore natural form and function. In addition, bank stabilization improvements would be made to about 2,000 feet of Shingle Creek between Xerxes Avenue and Palmer Lake. Levy funding will be phased over multiple years; this is phase 1.

2023 Capital Improvement Program

Project	Total Est Cost	City/Private	Grant	Comm Share	Total Levy
Cost share (city projects)	\$200,000	\$100,000	0	\$100,000	\$106,050
Partnership cost share (private projects)	50,000	0	0	50,000	\$53,025
Maintenance fund	50,000	0	0	50,000	\$53,025
Pike Creek Stabilization	395,000	290,000	0	105,000	111,350
Brookdale Park Natural Channel phase 1	625,000	0	0	625,000	662,815
Subtotal	\$1,320,000	\$390,000	\$0	\$930,000	\$986,265
5% additional for legal/admin costs				46,500	
Subtotal				976,500	
TOTAL LEVY (101% for uncollectable)				\$986,265	
Cost share (city projects)	\$100,000	\$50,000	0	\$50,000	\$53,025
Partnership Cost Share	100,000	0	0	100,000	106,050
Subtotal	\$200,000	\$50,000	\$0	\$150,000	\$159,075
5% additional for legal/admin costs				7,500	
Subtotal				157,500	
TOTAL LEVY (101% for uncollectable)				\$159,075	

2. West Mississippi 2023 CIP Projects (2024 levy).

a. Cost Share Fund. This annual project provides cost sharing to retrofit voluntary BMPs on city property. The TAC developed policies and procedures to administer these funds and makes recommendations to the Commission on which projects should be funded. The annual levy is \$50,000, to be matched at least one-to-one by a member city or cities. Applications are open until funds are depleted.

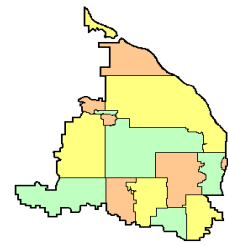

b. Partnership Cost Share Fund. This annual project provides cost sharing to retrofit voluntary BMPs on private property. The TAC developed policies and procedures to administer these funds and makes recommendations to the Commission on which projects should be funded. The annual levy is \$100,000, and funding does not require a match. Applications are open year-round until the funds are depleted.

Motion by Schoch, second by Wills to call for a public hearing as prescribed above. *Motion carried unanimously.*

Motion by Jaeger, second by Collins to call for a public hearing as described above. *Motion carried unanimously.*

C. Closed Project Policy.* At the July meeting, the West Mississippi Commission adopted a Closed Projects Account Policy similar to Shingle Creek's with one exception. The Shingle Creek policy, which was adopted in 2012, included a provision to cap the maximum fund balance at \$100,000, whereas the West Mississippi Commission thought that balance was too low and adopted a target balance cap of \$200,000.

The Shingle Creek Commissioners present agreed that given the increase in the cost of completing projects since 2012, \$200,000 was reasonable and requested that this policy be brought back with such a revision to make it consistent with the West Mississippi policy.

Included in the meeting packet is the proposed revised policy.* It makes two adjustments: it changes the \$100,000 cap to \$200,000 and replaces the word "will not" with "should not" in Section V: "Money ~~will~~ should not be accumulated to an amount in excess of \$200,000 unless a specific use for such funds has been identified." This clarifies that the cap is a guideline, not an absolute limit.

Motion by Schoch, second by Jaeger to adopt the Closed Project Policy as revised. *Motion carried unanimously.*

D. Gaulke Pond.* The Shingle Creek Commission requested Stantec to evaluate opportunities to reduce stormwater runoff volume to Gaulke Pond. As part of this effort, they have reviewed the available data, conducted a field reconnaissance visit, and conducted a desktop-based evaluation of potential sites within the Gaulke Pond subwatershed that could be retrofit to include a volume-reduction best management practice (BMP).

The memorandum* included in the meeting packet summarizes the project background, watershed changes, opportunity locations and BMPs considered, and ranking of potential BMPs. At their meeting earlier today, the Technical Advisory Committee (TAC), based on the ranking, recommended Stantec to proceed with 30% design of Opportunity A2 – the larger of the two infiltration trenches identified on Colorado Avenue.

Motion by Schoch, second by Jaeger to authorize Staff to proceed with Opportunity A2 at an anticipated cost of \$130,326. *Motion carried unanimously.*

VII. EDUCATION AND PUBLIC OUTREACH.

A. The **West Metro Water Alliance (WMWA)** will meet via Zoom at 8:30 a.m., September 12, 2023.

B. The new conservation specialist, **Grace Barcelow**, has been creating a six-month education and outreach plan and amassing appropriate resources.

[Butcher departed 2:28 p.m.]

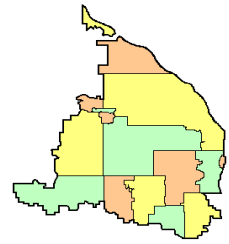

VIII. GRANT OPPORTUNITIES.

Eagle and Pike Lakes are both impaired for nutrients and have a published TMDL (2010). The TMDL specifies that sediment and phosphorus loads from Pike and Eagle lakes need to be reduced by approximately 57% and 22%, respectively. Stantec has determined that internal load treatment is necessary in order to meet those reductions. At the July meeting the Commission directed Staff to draft a **2024 CWF grant application** for internal loading treatments on both lakes. The grant application also includes aquatic invasive species (AIS) management, monitoring, public engagement, and project management.

This project would improve water quality and biotic integrity in Eagle and Pike Lakes in Maple Grove and Plymouth. Two alum treatments are proposed for each lake to seal the sediments and significantly reduce internal phosphorus load. An invasive curly-leaf pondweed will be treated to help restore and enhance the native submerged aquatic vegetation communities. Eagle Lake is a highly popular 290-acre recreational lake with an active lake association and public access. The 58-acre Pike Lake, which is connected to Eagle via a short channel and fringing wetlands, is a natural environment lake, and about two thirds of its shoreline is located within Eagle Lake Regional Park. Proposed measurable outcomes are: 164 and 143 pounds of phosphorus per year removed from Eagle Lake and Pike Lake, respectively.

Stantec has conservatively estimated aluminum sulfate treatment costs on both lakes, in addition to the other management tasks described above. Total project cost is estimated to be \$680,000. The minimum match requirement for the CWF Project and Practices grant fund is 10%, or about \$68,000. Staff recommends that the Commission consider offering a match of \$190,000, the amount set aside in the CIP for the Eagle Lake share of the project. The application text is not complete but will be refined in the coming weeks. Applications are due August 24, 2023.

Eagle Lake would be the largest lake on which the Commission has done an alum application. In addition, alum costs have risen in recent years and are based on the market at the time of contracting. Though project cost is high, the Commission has had great success implementing alum treatments and achieving improved water quality on watershed lakes. BWSR has increasingly been awarding CWF funds to large projects, thus Staff believe this application will be competitive.

Motion by Wills, second by Spoden to complete and submit the application for 2024 Clean Water funding with a \$190,000 local match, as outlined above. *Motion carried unanimously.*

IX. COMMUNICATIONS.

A. July Communications Log.* No items required action.

An article* in the *Sun Post* entitled, “**Treatment appears to curb Meadow Lakes’ curly-leaf infestation,**” was reprinted for the packet.

B. August Staff Report.*

1. **Highways 252/94 EIS Review.** No updates or meetings of the Highway 252/I-94 working group have taken place since the Commissions’ comments were submitted during the public comment period for the Draft Scoping Decision Document (DSDD) in May. The draft Environmental Impact Statement is currently scheduled to be released for public comment this fall 2023.

2. **Minnesota Stormwater Research Council Tour.** Stantec staff attended a tour of Minnesota Stormwater Research Council sites on July 20, 2023. Current research initiatives include:

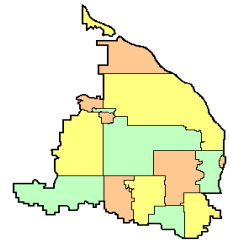

- a. Stormwater reduction and pollutant sourcing from urban trees
- b. Understanding solids loading in Minnesota stormwater
- c. Iron enhanced sand filters performance and maintenance assessment
- d. Evaluation of high-volume stormwater filtration media effectiveness for removal of phosphorus and other pollutants, and
- e. Four sites for urban pond research.

Stantec is the lead investigator for one of the urban pond research studies. Recent studies have documented the prevalence of internal phosphorus loading from stormwater pond sediments. Therefore, this study aims to quantify export of phosphorus from different types of stormwater ponds and offer new pond design guidance to improve performance. The second part of this study is to determine if the harmful algal blooms (HABs) that originate within a stormwater pond can be exported to downstream waterbodies, and if cyanobacteria and cyanotoxins can survive after being discharged from the pond and traveling through the stormwater conveyance systems.

3. County Actions: Maximum Levy. The Public Works Committee of the Hennepin County Board reviewed and recommended that the full County Board approve the maximum levies proposed by each Commission. The County Board approved the maximum levies on August 8, 2023.

4. Legal Boundary Update. Hennepin County expects to use the updated boundaries for taxes payable 2024 and will confirm when the process of updating the taxing boundaries is completed.

5. Eagle Lake Subwatershed Assessment. In-lake sediment evaluations are complete for Eagle and Pike Lakes and suggest a need for alum treatment in these lakes. For watershed load reductions, the set of potential projects prioritized based on water quality impact and cost will be presented in September to select one project to move forward to concept design. Refer to Item VIII. for more information.

6. Gaulke Pond Subwatershed Assessment. Stantec has completed assessment and ranking of potential practices. Refer to Item IV.D. for more information and next steps.

7. Shingle Creek Brookdale Park Remeander. Stantec presented two (2) conceptual plans with concept level costs to the Technical Advisory Committee (TAC) in July for feedback. At that time, the TAC recommended that the City of Brooklyn Park review the concepts and respond with additional comments prior to progressing final recommendations. Stantec met with City staff and discussed revisions based on City feedback and the potential to support City staff with a public engagement process to receive community feedback on the concepts.

8. Shingle Creek Trail Bank Stabilization and Fish Access Improvements. Stantec presented one conceptual plan with concept level costs to the TAC in July for feedback. At that time, the TAC recommended that the City of Brooklyn Park review the concept and respond with comments prior to progressing final recommendations. Stantec met with City staff and discussed revisions based on City feedback and the potential to support City staff with a public engagement process to receive community feedback on the concepts.

X. OTHER BUSINESS.

A. Spoden informed the Commissions of the resignation of Brooklyn Park Commissioner **Alex Albrigtsen Prasch**.

B. Roach informed the Commissions of the death of former Osseo Commissioner **Harold Johnson**.

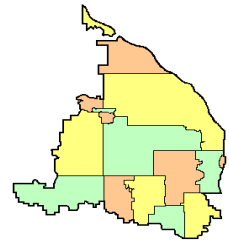

C. Spector informed the Commission that **Katie Kowalczyk**, Minneapolis TAC member, is leaving the City.

There being no further business before the Commissions, the joint meeting was adjourned at 2:37 p.m.

Respectfully submitted,

A handwritten signature in black ink, appearing to read "Judie A. Anderson".

Judie A. Anderson
Recording Secretary

JAA:tim

Z:\Shingle Creek\Meetings\Meetings 2023\August 10, 2023 meeting minutes.docx

To: Shingle Creek/West Mississippi WMO Commissioners

From: Todd Shoemaker, P.E.
Diane Spector

Date: September 6, 2023

Subject: Public Hearing 2023 Capital Projects
Project 2023-01 Shingle Creek City Cost Share BMPs
Project 2023-02 Shingle Creek Partnership Cost Share
Project 2023-03 Shingle Creek Project maintenance Fund
Project 2023-04 West Mississippi Cost Share BMPs
Project 2023-05 West Mississippi Partnership Cost Share

**Recommended
Commission Action**

The County Board has approved both maximum levies. Conduct a public hearing on the proposed projects. Each Commission should approve their respective resolutions ordering the projects and certifying the levies.

The purpose of the public hearing is to consider the proposed projects and their financing and to take comment from the member cities and the public. The recommended order of business is as follows:

1. Staff report on projects and proposed financing
2. Commissioner discussion
3. Each Commission should open a public hearing, which can run concurrently
4. Take comments from member cities
5. Take comments from the public
6. Close the public hearings
7. Commissioner discussion
8. The Shingle Creek Commission should consider the following resolution (a 2/3 majority is required):

A RESOLUTION ORDERING 2023 IMPROVEMENTS,
DESIGNATING MEMBER RESPONSIBLE FOR
CONSTRUCTION, MAKING FINDINGS AND CERTIFYING
COSTS TO HENNEPIN COUNTY PURSUANT TO MINNESOTA
STATUTES, SECTION 103B.251

9. The West Mississippi Commission should consider the following resolution (a 2/3 majority is required):

A RESOLUTION ORDERING 2023 IMPROVEMENTS,
DESIGNATING MEMBER RESPONSIBLE FOR
CONSTRUCTION, MAKING FINDINGS AND CERTIFYING
COSTS TO HENNEPIN COUNTY PURSUANT TO MINNESOTA
STATUTES, SECTION 103B.251

10. Continue with regular meetings

Table 1. Shingle Creek 2023 CIP Projects (2024 levy).

Project	Total Estimated	City/Private	Grant	Commission Share
Cost share (city)	\$200,000	\$100,000	0	\$100,000
Partnership cost share (private)	50,000	0	0	50,000
Maintenance fund	50,000	0	0	50,000
Pike Creek Stabilization	395,000	290,000	0	105,000
Bdale Park Natural Channel phase 1	625,000	0	0	625,000
Subtotal	\$1,320,000	\$390,000	\$0	\$930,000
5% additional for legal/admin				46,500
Subtotal				976,500
TOTAL LEVY (101% for uncollectable)				\$986,265

Table 1b. Levy by project.

Project	Total Levy
Cost share (city projects)	\$106,050
Partnership cost share (private projects)	\$53,025
Maintenance fund	\$53,025
Pike Creek Stabilization	111,350
Bdale Park Natural Channel phase 1	662,815
Total	\$986,265

Table 2. West Mississippi 2023 CIP Projects (2024 levy).

Project	Total Estimated	City/Private	Grant	Commission Share
Cost share (city projects)	\$100,000	\$50,000	0	\$50,000
Partnership Cost Share	100,000	0	0	100,000
Subtotal	\$200,000	\$50,000	\$ 0	\$150,000
5% additional for legal/admin costs				7,500
Subtotal				157,500
TOTAL LEVY (101% for uncollectable)				\$159,075

Table 2b. Levy by project.

Project	Total Levy
Cost share (city projects)	\$53,025
Partnership Cost Share	106,050
Total	\$159,075

Shingle Creek Projects

Cost Share Fund. This annual project provides cost sharing to retrofit voluntary BMPs on city property. The TAC developed policies and procedures to administer these funds and makes recommendations to the Commission on which projects should be funded. The annual levy is \$100,000, to be matched at least one-to-one by a member city or cities. Applications are open until funds are depleted.

Partnership Cost Share Fund. This annual project provides cost sharing to retrofit voluntary BMPs on private property. The TAC developed policies and procedures to administer these funds and makes recommendations to the Commission on which projects should be funded. The annual levy is \$50,000, and funding does not require a match. Applications are open year-round until the funds are depleted.

Maintenance Fund. This program makes funds available for nonstructural practices such as, but not limited to, rough fish management; invasive aquatic vegetation control; alum treatment touch-up; native aquatic vegetation translocation; and maintenance of Commission- installed projects for which a member City has not accepted maintenance

West Mississippi Projects

Cost Share Fund. This annual project provides cost sharing to retrofit voluntary BMPs on city property. The TAC developed policies and procedures to administer these funds and makes recommendations to the Commission on which projects should be funded. The annual levy is \$50,000, to be matched at least one-to-one by a member city or cities. Applications are open until funds are depleted.

Partnership Cost Share Fund. This annual project provides cost sharing to retrofit voluntary BMPs on private property. The TAC developed policies and procedures to administer these funds and makes recommendations to the Commission on which projects should be funded. The annual levy is \$50,000, and funding does not require a match. Applications are open year-round until the funds are depleted.

**SHINGLE CREEK WATERSHED MANAGEMENT COMMISSION
RESOLUTION NO. 2023-002**

**ORDERING 2023 IMPROVEMENTS, DESIGNATING MEMBER
RESPONSIBLE FOR CONSTRUCTION, MAKING FINDINGS,
AND CERTIFYING COSTS TO HENNEPIN COUNTY PURSUANT
TO MINNESOTA STATUTES, SECTION 103B.251**

WHEREAS, on May 11, 2023, the Shingle Creek Watershed Management Commission adopted its *Shingle Creek and West Mississippi Fourth Generation Watershed Management Plan*, which includes a Capital Improvement Program (CIP); and

WHEREAS, the *Fourth Generation Watershed Management Plan* specified a county tax levy under Minn. Stat. § 103B.251 as the source of the Commission's share of funding for capital projects proposed in the Commission's CIP; and

WHEREAS, the CIP includes annual allocations for Shingle Creek Cost Share BMPs, hereby known as "Project 2023-01," and Shingle Creek Partnership BMPs, hereby known as "Project 2023-02," and specified a county tax levy under Minn. Stat. § 103B.251 as the source of the Commission's share of funding; and

WHEREAS, on July 14, 2022, the Commission adopted a Minor Plan Amendment to create a "Project Maintenance Fund," hereby known as "Project 2023-03," and specified a county tax levy under Minn. Stat. § 103B.251 as the source of the Commission's share of funding; and

WHEREAS, the Commission has received Feasibility Studies for projects designated "Project 2023-04 Pike Creek Stabilization" in the cities of Maple Grove and Plymouth, and "Project 2023-05 Brookdale Park Natural Channel Phase 1" in the City of Brooklyn Park; and

WHEREAS, on September 14, 2023, following published and mailed notice in accordance with the Commission's Joint Powers Agreement and Minn. Stat. § 103B.251, the Commission conducted a public hearing on the projects.

NOW, THEREFORE, BE IT RESOLVED by the Board of Commissioners of the Shingle Creek Watershed Management Commission as follows:

1. The 2023 Projects will be conducive to the public health and promote the general welfare and are in compliance with Minn. Stat. § 103B.205 to 103B.255 (the "Act") and with the Commission's management plan as adopted and amended in accordance with the Act.
2. The cost of the projects is estimated to be:

Project	Total Estimated	City/ Private	Commission Share	Total Levy
Cost share (city)	\$200,000	\$100,000	\$100,000	\$106,050
Partnership cost share (private)	50,000	0	50,000	53,025
Maintenance fund	50,000	0	50,000	53,025
Pike Creek Stabilization	395,000	290,000	105,000	111,350,
Brookdale Park Natural Channel Ph 1	625,000		625,000	662,815
Subtotal	\$1,320,000	\$390,000	\$930,000	\$986,265
5% additional for legal/admin costs			46,500	
Subtotal			976,500	
TOTAL LEVY (101% for uncollectable)			\$986,265	

3. On July 11, 2014, the Commission adopted Guidelines and procedures governing the use of the Commission City Cost Share BMPs Program. The Shingle Creek Watershed Management Commission will complete Project 2023-01 in accordance with those Guidelines.
4. On December 10, 2015, the Commission adopted Guidelines and procedures governing the use of the Commission Partnership Cost Share BMPs Program. The Shingle Creek Watershed Management Commission will complete Project 2023-02 in accordance with those Guidelines.
5. On February 10, 2022, the Commission adopted Guidelines and procedures governing the use of the Project Maintenance Fund. The Shingle Creek Watershed Management Commission will complete Project 2023-03 in accordance with those Guidelines.
6. The Commission's \$986,265 share of the cost of the 2023 Projects including administrative costs is hereby certified to Hennepin County in accordance with Minn. Stat. § 103B.251 for payment by the County in accordance with Minn. Stat. § 103B.251, Subd. 6 and the Commission's joint powers agreement. The Commission understands that the County may pay such costs with taxes levied in 2023 and paid in 2024. The Administrator is directed to transmit a certified copy of this resolution to Hennepin County prior to October 1, 2023.

Adopted by the Commissioners of the Shingle Creek Watershed Management Commission, the fourteenth day of September 2023.

R.A. Polzin, Chair

ATTEST:

Judie A. Anderson, Administrator

State of Minnesota

Hennepin County

I, Judie Anderson, do hereby certify that I am the custodian of the minutes of all proceedings had and held by the Board of Commissioners of said Shingle Creek Watershed Management Commission, that I have compared the above resolution with the original passed and adopted by the Board of Commissioners at a meeting thereof held on the fourteenth day of September, 2023, at 12:45 pm., that the above constitutes a true and correct copy thereof, that the same has not been amended or rescinded and is in full force and effect.

In witness whereof, I have hereunto placed my hand and signature this fourteenth day of September 2023.

Print
name: Judie A. Anderson Title: Administrator

Authorized
signature: _____ Date: _____

(NO SEAL)

WEST MISSISSIPPI WATERSHED MANAGEMENT COMMISSION

RESOLUTION NO. 2023-02

**ORDERING 2023 IMPROVEMENTS, MAKING FINDINGS,
AND CERTIFYING COSTS TO HENNEPIN COUNTY
PURSUANT TO MINNESOTA STATUTES, SECTION 103B.251**

WHEREAS, on May 11, 2023 the West Mississippi Watershed Management Commission adopted its *Shingle Creek and West Mississippi Fourth Generation Watershed Management Plan*, which includes a Capital Improvement Program (CIP); and

WHEREAS, the *Fourth Generation Watershed Management Plan* specified a county tax levy under Minn. Stat. § 103B.251 as the source of the Commission's share of funding for capital projects proposed in the Commission's CIP; and

WHEREAS, the CIP includes an annual allocation for West Mississippi Cost Share BMPs, hereby known as "Project 2023-06," and West Mississippi Partnership Cost Share, hereby known as "Project 2023-07," and specified a county tax levy under Minn. Stat. § 103B.251 as the source of the Commission's share of funding; and

WHEREAS, on September 14, 2023, following published and mailed notice in accordance with the Commission's Joint Powers Agreement and Minn. Stat. § 103B.251, the Commission conducted a public hearing on the projects.

NOW, THEREFORE, BE IT RESOLVED by the Board of Commissioners of the West Mississippi Watershed Management Commission as follows:

1. The 2023 Projects will be conducive to the public health and promote the general welfare and are in compliance with Minn. Stat. § 103B.205 to 103B.255 (the "Act") and with the Commission's surface water management plan as adopted and amended in accordance with the Act.
2. The cost of the projects is estimated to be:

Project	Total Estimated	City/ Private	Commission Share	Total Levy
Cost Share (city projects)	\$100,000	\$50,000	\$50,000	\$53,025
Partnership Cost Share (private projects)	100,000		100,000	106,050
Subtotal	\$200,000	\$50,000	\$150,000	
5% additional for legal/admin costs			7,500	
Subtotal			157,500	
TOTAL LEVY (101% for uncollectable)			\$159,075	\$159,075

3. On July 11, 2014 the Commission adopted Guidelines and procedures governing the use of the Commission Fund for Retrofit Projects. The West Mississippi Watershed Management Commission will complete Project 2023-06 in accordance with those Guidelines.

4. On April 8, 2021 the Commission adopted Guidelines and procedures governing the use of the Commission Partnership Cost Share (private projects). The West Mississippi Watershed Management Commission will complete Project 2023-07 in accordance with those Guidelines.
5. The Commission's \$159,075 share of the cost of the 2023 Projects including administrative costs is hereby certified to Hennepin County Hennepin County in accordance with Minn. Stat. § 103B.251 for payment by the County in accordance with Minn. Stat. § 103B.251, Subd. 6 and the Commission's joint powers agreement. The Commission understands that the County may pay such costs with taxes levied in 2023 and paid in 2024. The Administrator is directed to transmit a certified copy of this resolution to Hennepin County prior to October 1, 2023.

Adopted by the Commissioners of the West Mississippi Watershed Management Commission the fourteenth day of September, 2023.

Gerald Butcher, Chair

ATTEST:

Judie A. Anderson, Administrator

State of Minnesota

Hennepin County

I, Judie Anderson, do hereby certify that I am the custodian of the minutes of all proceedings had and held by the Board of Commissioners of said Shingle Creek Watershed Management Commission, that I have compared the above resolution with the original passed and adopted by the Board of Commissioners at a meeting thereof held on the fourteenth day of September, 2023, at 12:45 pm., that the above constitutes a true and correct copy thereof, that the same has not been amended or rescinded and is in full force and effect.

In witness whereof, I have hereunto placed my hand and signature this fourteenth day of September, 2023.

Print name: Judie A. Anderson Title: Administrator
Authorized signature: _____ Date: _____
(NO SEAL)

**COOPERATIVE AGREEMENT
FOR
BROOKDALE PARK NATURAL CHANNEL PHASE 1**

This Agreement is made as of this _____ day of _____ 2023, by and between the Shingle Creek Watershed Management Commission, a joint powers watershed management organization (hereinafter the "Commission"), and the City of Brooklyn Park, a Minnesota municipal corporation (hereinafter the "City").

WITNESSETH:

WHEREAS, the Commission has adopted the Shingle Creek and West Mississippi Fourth Generation Watershed Management Plan (the "Plan"), on May 11, 2023, a watershed management plan within the meaning of Minn. Stat., § 103B.231; and

WHEREAS, the Plan includes a capital improvement program ("CIP") that lists a number of water quality project capital improvements; and

WHEREAS, the water quality projects identified in the CIP include the Brookdale Park Natural Channel Phase 1 project more fully described in Attachment One to this Agreement, which is hereby made a part hereof (the "Project"); and

WHEREAS, the Plan specifies that projects in the CIP will be partially funded by a County tax levy under Minn. Stat., § 103B.251; and

WHEREAS, on September 14, 2023, the Commission adopted a resolution ordering the Project, directing that it be constructed by the City and that the Commission's share of the Project costs be certified to Hennepin County for payment in accordance with Minn. Stat., § 103B.251; and

WHEREAS, it is expected that Hennepin County will levy taxes throughout the watershed for the Project, for collection and settlement in 2024; and

WHEREAS, the City is willing to construct the Project on the terms and conditions hereinafter set forth.

NOW, THEREFORE, ON THE BASIS OF THE PREMISES AND MUTUAL COVENANTS AND AGREEMENTS HEREINAFTER SET FORTH, THE PARTIES AGREE AS FOLLOWS:

1. The Project will consist of improvements in the City as more fully described on Attachment One.
2. The City will design the Project and prepare plans and specifications for construction of the Project. Plans and specifications are subject to approval by the Commission's consulting engineer and the City of Brooklyn Park City Engineer.
3. The City will advertise for bids and award contracts in accordance with the requirements of law. The City will award the contract and supervise and administer the construction of the

Project to assure that it is completed in accordance with plans and specifications. The City will require the contractor to provide all payment and performance bonds required by law. The City will require that the Commission be named as additional insured on all liability policies required by the City of the contractor. The City will require that the contractor defend, indemnify, protect and hold harmless the Commission and the City, their agents, officers, and employees, from all claims or actions arising from performance of the work of the Project conducted by the contractor. The City will supervise the work of the contractor. However, the Commission may observe and review the work of the Project until it is completed.

4. The City will pay the contractor and all other expenses related to the construction of the Project and keep and maintain complete records of such costs incurred.
5. The Commission will use its best efforts to secure payment from the County in accordance with Minn. Stat., § 103B.251 in the amount of Six Hundred Sixty-Two Thousand Eight Hundred Fifteen Dollars (\$662,815). It is understood that tax settlement from the County is not expected to occur until 2024.

Out-of-pocket costs related to the Project, incurred and paid by the Commission for publication of notices, securing County tax levy, preparation of contracts, review of proposed contract documents and administration of this contract shall be repaid from the Commission's Closed Projects Account. Reimbursement to the City will be made on completion of the project and submittal of as-builts. Reimbursement to the City will be made as soon as funds are available provided a request for payment has been received from the City providing such detailed information as may be requested by the Commission to substantiate costs and expenses.

6. Reimbursement to the City will not exceed six hundred twenty-five thousand dollars (\$625,000). All costs of the Project incurred by the City in excess of such reimbursement, including all costs incurred in excess of estimated project costs due to unforeseen conditions or any other cause, shall be borne by the City or secured by the City from other sources.
7. All City books, records, documents, and accounting procedures related to the Project are subject to examination by the Commission.
8. The City will secure all necessary local, state, or federal permits required for the construction of the Project.
9. The project will be constructed on land owned or easements held by the City.
10. The City will have ownership of the associated improvements, and will maintain them in good operating condition in perpetuity or until such time as they are replaced with like improvements.
11. The City will defend, indemnify, protect and hold harmless the Commission and its agents, officers, and employees, from any claims arising out of the design, construction, or maintenance of the Project, including environmental claims. Nothing herein shall be deemed a waiver of the limitations of liability in Minnesota Statutes, Chapter 466.

IN WITNESS WHEREOF, the parties have caused this Agreement to be executed by their duly authorized officers on behalf of the parties as of the day and date first above written.

SHINGLE CREEK WATERSHED
MANAGEMENT COMMISSION

By: _____
Its Chair

And by: _____
Its Secretary

CITY OF BROOKLYN PARK

By: _____
Its Mayor

And by: _____
Its Manager

ATTACHMENT ONE
Plymouth Bass Lake Pond Project

Project Abstract:

This project is the construction of a withdrawal and treatment system to remove Total Phosphorus from Bass Lake.

Overall Project Narrative:

The Bass Lake TMDL calls for a 33 percent reduction in load to Bass Lake to meet state water quality standards, or about 200 pounds TP annually from the watershed.

Plymouth engaged a consultant to review options for load-reduction BMPs in the Bass Lake drainage area. This study identified several pond maintenance and enhancement projects and a lake water withdrawal and treatment system. The City is pursuing both a withdrawal and treatment system and pond maintenance projects. The Commission project consists solely of the withdrawal and treatment system; Plymouth is responsible for undertaking and funding the pond maintenance projects.

The City proposes to locate the facility on the south end of the lake, where Bass Creek discharges into a “lagoon” prior to discharging into Bass Lake. Water would be withdrawn from the lagoon, treated, and returned, with the treatment effluent discharged into sanitary sewer. The estimated cost of the project is \$840,000. The estimated annual TP load reduction is 50-80 pounds per year.

In addition to this Project, the City proposes to undertake various maintenance and expansion projects on key ponds in the drainage area, and to work with the lake association on aquatic vegetation management. Those maintenance and operations projects are not included in the capital project being proposed.

**COOPERATIVE AGREEMENT
FOR
PIKE CREEK STABILIZATION PROJECT**

This Agreement (“**Agreement**”) is made as of this ____ day of _____ 2023 by and between the Shingle Creek Watershed Management Commission, a joint powers watershed management organization, (“**Commission**”); the City of Plymouth, a Minnesota municipal corporation, (“**City 1**”); and the City of Maple Grove, a Minnesota municipal corporation, (“**City 2**”) (together, “**the Cities**”). The Commission and the Cities may hereinafter be referred to individually as a “party” and collectively as the “parties.”

RECITALS

- A. On May 11, 2023, the Commission and the West Mississippi Watershed Management Commission jointly adopted the Shingle Creek and West Mississippi Fourth Generation Watershed Management Plan (“**Plan**”), a watershed management plan within the meaning of Minn. Stat. § 103B.231.
- B. The Plan includes a capital improvement program (“**CIP**”) that lists a number of water quality project capital improvements.
- C. The water quality projects identified in the CIP include the Pike Creek Stabilization Project (“**Project**”), which is more fully described in the attached Attachment One.
- D. The Plan specifies that projects in the CIP will be partially funded by a County tax levy under Minn. Stat. § 103B.251.
- E. On September 14, 2023, the Commission adopted a resolution ordering the Project, directing that it be constructed by the Cities and that the Commission’s share of the Project costs be funded from a levy previously certified to Hennepin County (“**County**”) in accordance with Minn. Stat. § 103B.251.
- F. The Cities are willing to construct the Project in accordance with the terms and conditions of this Agreement.

AGREEMENT

In consideration of the premises and mutual covenants and agreements hereinafter set forth, and intending to be legally bound, the parties agree as follows:

1. The Project will consist of the work required to construct the improvements in the Cities as more fully described in Attachment One. The Cities will design the Project and prepare plans and specifications for construction of the Project. Plans and specifications are subject to approval by the Commission’s consulting engineer and the Cities’ Engineers.

2. The Cities will advertise for bids and award contracts in accordance with the requirements of law. The Cities will award the contract and supervise and administer the construction of the Project to assure that it is completed in accordance with plans and specifications. The Cities will require the contractor to provide all payment and performance bonds required by law. The Cities will require that the Commission be named as additional insured on all liability policies required by the Cities of the contractor. The Cities will require that the contractor defend, indemnify, protect and hold harmless the Commission and the Cities, their agents, officers, and employees, from all claims or actions arising from performance of the work of the Project conducted by the contractor. The Cities will supervise the work of the contractor. However, the Commission may observe and review the work of the Project until it is completed.

3. The Cities will pay the contractor and all other expenses related to the construction of the Project and keep and maintain complete records of such costs incurred.

4. The Commission will use its best efforts to secure payment from the County in accordance with Minn. Stat., § 103B.251 in the amount of One Hundred Eleven Thousand Three Hundred Fifty Dollars (\$111,350). It is understood that tax settlement from the County is not expected to occur until 2024.

Out-of-pocket costs related to the Project, incurred and paid by the Commission for publication of notices, securing County tax levy, preparation of contracts, review of proposed contract documents and administration of this contract shall be repaid from the Commission's Closed Projects Account. Reimbursement to the Cities will be made on completion of the project and submittal of as-builts. Reimbursement to the Cities will be made as soon as funds are available provided a request for payment has been received from the Cities providing such detailed information as may be requested by the Commission to substantiate costs and expenses.

5. Reimbursement to the Cities will not exceed the amount received from the County, up to one hundred five thousand dollars (\$105,000). All costs of the Project incurred by the Cities in excess of such reimbursement, including all costs incurred in excess of estimated project costs due to unforeseen conditions or any other cause, shall be borne by the Cities or secured by the Cities from other sources.

6. All of the Cities' books, records, documents, and accounting procedures related to the Project are subject to examination by the Commission.

7. The Cities will secure all necessary local, state, or federal permits required for the construction of the Project.

8. The project will be constructed on land owned or easements held by the Cities.

9. The Cities will have ownership of the associated improvements, and will maintain them in good operating condition in perpetuity or until such time as they are replaced with like improvements.

10. The Cities will defend, indemnify, protect and hold harmless the Commission and its agents, officers, and employees, from any claims arising out of the design, construction, or maintenance of the Project, including environmental claims. Nothing herein shall be deemed a waiver of the limitations of liability in Minnesota Statutes, Chapter 466.

IN WITNESS WHEREOF, the parties have caused this Agreement to be executed by their duly authorized officers on behalf of the parties as of the day and date first above written.

**SHINGLE CREEK WATERSHED
MANAGEMENT COMMISSION**

By: _____
Its Chair

And by: _____
Its Secretary

CITY OF PLYMOUTH

By: _____
Its Mayor

And by: _____
Its City Manager

CITY OF MAPLE GROVE

By: _____
Its Mayor

And by: _____
Its City Manager

ATTACHMENT ONE
Pike Creek Stabilization Project

(attached hereto)

SHINGLE CREEK WATERSHED MANAGEMENT COMMISSION**PROJECT REVIEW SC2023-006:** Project Libre

Owner: John Williams
Company: Opus Group
Address: 1030 Bren Road West Minnetonka, MN 55343

Engineer: Jacob Mitzel, PE
Company: Samabatek
Address: 12800 Whitewater Drive

Phone: 763-312-6059
Email: Jmitzel@sambatek.com

Purpose: Construction of a mixed-use industrial building and parking on 29.8 acres.

Location: 7201 Kilmer Lane Maple Grove, MN 55369 (Figure 1).

- Exhibits:**
1. Project review application and project review fee of \$3,000, dated 6/29/2023, received 7/6/2023.
 2. Project Libre Watershed Submittal Preliminary Site Plan [C2.0-, C3.01, C3.02, C4.01, C5.01, C5.02, C6.01, C6.02, C9.0-, L0.0-, L1.01, L1.02, A3.01(Figure 2)], dated 8/30/2023, received 8/31/2023.
 3. Project Libre SWMP, by Sambatek, dated 8/30/2023, received 8/31/2023.
 4. MIDS Model, by Sambatek, dated 8/14/2023, received 8/31/2023.
 5. MPCA Simple Estimator, by Sambatek, dated 8/14/2023, received 8/31/2023.
 6. Draft Operation and Maintenance Agreement, by Sambatek, dated 8/25/2023, received 8/31/2023.

- Findings:**
1. The proposed project is the construction of a mixed-use industrial building and associated parking. The site is 29.8 acres. Following development, the site will be 51 percent impervious with 15.1 acres of impervious surface, an increase of 13.3 acres. The 15.1 acres of impervious includes 1.8 acres for future parking expansion and is accounted for in the stormwater management calculations.
 2. The complete project application was received on 7/6/2023. The applicant requested a 60-day review extension on July 27, 2023. To comply with the 60-day review requirement, the Commission must approve or deny this project no later than the 9/14/2023 meeting. Sixty calendar-days expires on 9/25/2023.
 3. Commission rules require the site to infiltrate 1.1 inches of runoff from new impervious area within 48 hours. The site is located within the Maple Grove Gravel Mining Area (GMA, Figure 3). In 2010, the Commission reviewed and approved a plan by the City of Maple Grove to obtain infiltration credits for this new development by constructing biofiltration basins adjacent to four existing regional stormwater ponds. Stormwater from areas that developed prior to the infiltration rule is directed to these basins. The Commission agreed that these new

infiltration basins are adequate to provide regional infiltration for the 553 acres of "undeveloped area" (SC2010-04). The subject project is located within the "undeveloped area" and therefore meets Commission volume control treatment requirements.

4. To comply with the Commission's water quality treatment requirement, the site must provide treatment so there is no net increase in TP or TSS from pre- to post-development land cover. The applicant has provided a water quality model showing no net increase in TP or TSS from existing to proposed conditions (Table 1.). The applicant meets Commission water quality treatment requirements.

Table 1. Pre- and Post-development TP and TSS Loads

Condition	TP Load (lbs.)	TSS Load (lbs.)
Pre-development	7.2	3,600
Post-development	6.3	360

5. Commission rules require that site runoff is limited to predevelopment rates for the 2-, 10-, and 100-year, 24-hour, and 100-year, 10-day critical storm event. Runoff from the site is routed through a series of ponds and an existing wetland. Discharge from the site will occur through an existing 36" pipe at the south side of the site on Kilmer Lane. The applicant meets Commission rate control requirements (Table 2).

Table 2. Runoff from site (cfs).

Drainage Area	2-year event		10-year event		100-year event		100-year, 10-day event	
	Pre-	Post-	Pre-	Post-	Pre-	Post-	Pre-	Post-
Kilmer Lane	12.9	11.3	26.2	22.6	69.2	54.1	13.0	9.0

6. The erosion control plan includes rock construction entrances, perimeter silt fence/biolog, silt fence surrounding detention ponds, inlet protection, rip rap at inlets, slope checks, and native seed specified on the pond slopes. The erosion control plan meets Commission requirements.
7. The National Wetlands Inventory identifies two large wetlands on the site. The western wetland is an incidental wetland, and the eastern wetland is regulated under the Wetland Conservation Act (WCA) and Army Corps of Engineers. The applicant plans to remove the incidental wetland and maintain the regulated wetland. Wetland buffers a minimum of 20 feet in width and averaging 30 feet in width are provided with monuments shown on the plans. Regarding the incidental wetland, the Technical Evaluation Panel (TEP) reviewed the gravel mining area as a whole and determined "...based on aerial photo review from 1940-2023 that the GMA undergoes extensive excavation, dewatering, stockpiling, and reclamation processes and that basins in the GMA historically and currently undergo conversion and manipulation and meet the definition of...'nonwetland'." The applicant meets Commission wetland requirements.
8. There are no Public Waters on this site. The applicant meets Commission Public Waters requirements.

SC2023-006: Project Libre

9. There is no FEMA-regulated floodplain on this site. The low floor elevations of the buildings are at least two feet higher than the high-water elevation of the detention ponds according to Atlas 14 precipitation. The applicant meets Commission floodplain requirements.
10. The site is located in a Drinking Water Supply Management Area (DWSMA) but is outside of the Emergency Response Area. Therefore, infiltration is permitted but is not proposed by the applicant. The applicant meets Commission drinking water protection requirements.
11. A public hearing on the project was conducted on March 27, 2023, as part of Planning Commission and City Council review of this project, meeting Commission public notice requirements.
12. A draft Operations & Maintenance (O&M) agreement between the applicant and the City of Maple Grove has been provided.
13. A Project Review Fee of \$3000 has been received.

Recommendation: Approve subject to the following conditions:

- 1) Amend the Stormwater Best Management Practice Operation & Maintenance Plan for the Contech Stormfilter with Phosphosorb to achieve the 70% TP removal credit:
 - a) Evidence of a contract with a qualified vendor to conduct maintenance.
 - b) Inspect manufactured treatment device monthly during the frost-free season for the first year of operation after construction and determine maintenance schedule based on findings from the first year of operation.
 - c) Maintenance procedures should follow manufacturer's guidelines.
 - d) Expected filter media replacement interval.
 - e) Cost estimate for maintenance and replacement of the filter media.

Stantec Inc.
Engineers for the Commission

Todd Shoemaker, P.E.

9/6/2023

SC2023-006: Project Libre

Figure 1. Site location.



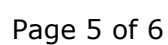
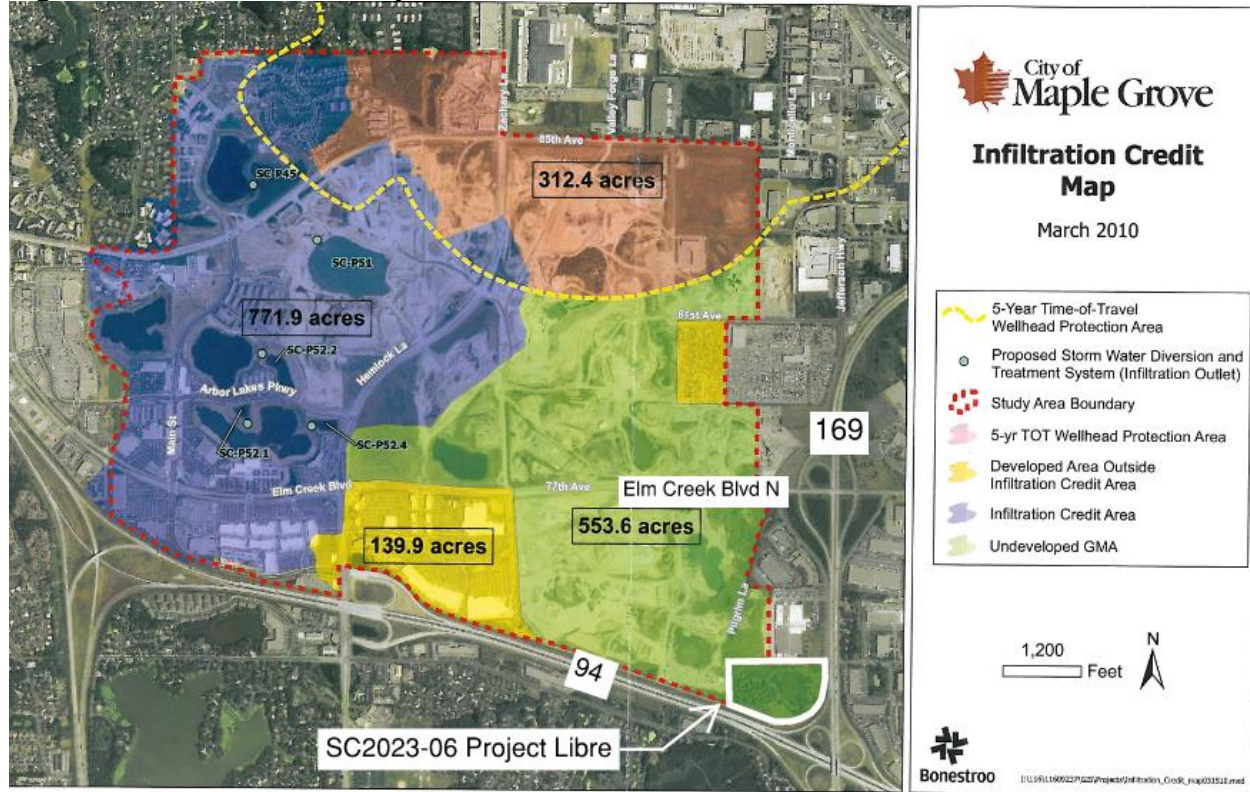

Figure 3. Site in Undeveloped GMA





Stantec Consulting Services Inc.
One Carlson Parkway North, Suite 100
Plymouth MN 55447

September 6, 2023

Shingle Creek Watershed Management Commission

3235 Fernbrook Lane North
Plymouth, MN 55447

Shingle Creek Watershed Management Commissioners:

We appreciate the opportunity to present this additional scope and fee proposal for public engagement services for the Brookdale Park Shingle Creek Remeander project.

Scope of Work

Additional proposed services include public engagement for the project area. The Brooklyn Park (City) community park is approximately 180 acres and contains active recreation and an extensive trail network along the creek that connects schools, natural areas, and regional trails. Resident and community input would be valuable information to determine next steps before proceeding with preliminary plans for the remeandered creek. The task numbering noted below is a continuation of that outlined in our original scope of work.

Task 2.1 – Public Engagement and Concept Revisions

Before selecting a concept alternative to progress into preliminary drawings, we will assist the City of Brooklyn Park with public engagement services to present the initial concepts and solicit and respond to community input and feedback. Scope will include:

- Develop two (2) illustrative renderings of the concepts for public input meeting #1 and revise one (1) illustrative rendering for public meeting #2;
- Prepare presentation materials and present concepts at two (2) public open house/engagement meetings.
 - Meeting #1 – present background, goals, initial concepts and listen and gather community input and,
 - Meeting #2 - present input received and revised concept plan;
- Compile meeting comments and minutes;
- Evaluate one (1) revised concept for water quality, dissolved oxygen, and habitat improvement benefits; and
- Follow-up and coordinate with City of Brooklyn Park staff to provide community input responses, discuss design direction, follow-up communications, and concept revisions. Coordination will be via email, Teams calls, or phone calls.

Meetings: Two (2) public meetings, in-person at City Hall

Reference: Brookdale Park Shingle Creek Remeander Feasibility Study – Public Engagement Additional Services

Deliverables: Two (2) illustrative concept graphic plan renderings with one (1) round of revision, public meeting presentation materials, meeting comments/minutes, and communications.

Fee Estimate

Stantec will execute the scope of work described above for the fee outlined below on a time and materials basis and according to the terms of the original contract for this study. We will not exceed the amount indicated without prior authorization from the SCWMC. Should the Commission approve this proposal, staff recommend the work be funded by the Commission's Closed Projects account. The account balance is currently approximately \$106,000. However, we expect unused levy funds from the Bass Creek and Connections projects to transfer into the Closed Projects account before the end of the year. The Commission levied the full amount for these projects, but total cost to the Commission was less than expected because of grant awards. Upon transfer, the Closed Projects account will likely be in the \$200,000-\$300,000 range.

No.	Description	HOURS	TASK TOTALS		FEE
			LABOR	EXPENSES	
2.1	Public Engagement and Concept Revisions	58	\$9,550	\$ 100	\$9,650

We look forward to discussing this proposal and are happy to review our approach and scope of work with you. Should you have any questions, please don't hesitate to contact me via phone or email.

Best regards,

STANTEC CONSULTING SERVICES INC.

Todd Shoemaker PE, CFM
Senior Water Resources Engineer
Phone: 651-294-4585
Mobile: 612-414-7166
todd.shoemaker@stantec.com

To: West Mississippi WMC TAC/Commissioners

From: Todd Shoemaker PE

Date: September 6, 2023

Subject: Partnership Cost Share Request by Three Rivers Park District for Mississippi Gateway Regional Park

**Recommended
Commission Action**

Approve cost share request.

The Three Rivers Park District submitted a partner cost share request to the West Mississippi WMC for stabilization of the Mississippi River bank associated with the Mississippi Gateway Regional Park project (Figure 1). The Commission reviewed and approved the Mississippi Gateway project at the February 2023 meeting. The project will reduce excessive sediment and nutrient loading from approximately 2,200 linear feet of Mississippi River shoreline by stabilizing five separate areas of bank erosion and one area of gully erosion in an existing drainageway. Stabilizing these highly erosive areas will reduce the sediment and nutrient loading to the Mississippi River. Stabilization practices include grading and re-sloping of banks, vegetated riprap, native plantings, rock deflectors, and toe wood (Figures 2-7). Three Rivers Park District requests \$75,000 for the project. Commission guidelines state the maximum cost share amount is \$50,000.

The project feasibility study initially estimated construction cost for the bank stabilization at approximately \$258,000. Since the completion of the feasibility study, 90% design plans have been completed along with an updated cost estimate, which has risen to \$464,613. Besides the Commission partner cost share, Three Rivers Park District has also pursued funding from the National Park Service and Conservation Partners Legacy Grant. The Park District believes that securing the West Mississippi WMC partner cost share will strengthen the CPL grant application. Construction is currently planned for the winter of 2024/2025 with a substantial completion date of April of 2025.

Sediment loading rates (tons/year) were estimated based on bank height, length, recession rate, and soil bulk density from field and remote measurements. Bank recession rates were estimated using historical satellite imagery. Phosphorus load reduction was based on a phosphorus correction factor using the Board of Water and Soil Resources Water Erosion Pollution Reduction Estimator (Table 1).

Table 1. Water quality benefits of the proposed project.

	Sediment Reduction (ton/yr)	TP Reduction (lb/yr)	Normalized Cost (\$/lb TP)
Bank Stabilization	312	266	\$9 -\$313

Stantec recommends approval of the cost share request subject to the following condition:

1. The City of Brooklyn Park must verify that a public easement (or equivalent) is dedicated and that an Operations and Maintenance Agreement has been executed and recorded prior to release of any funds.

The City will present this application at the September 14, 2023 meeting. With the condition noted above and the concurrence of the TAC, staff recommends approval of this cost share application. If approved, the estimated balance of the West Mississippi WMC Partner Cost Share Fund would be \$130,500 at the end of 2023.

Figure 1. Project Location



Figure 2. Work Area 1 from Design Plans.

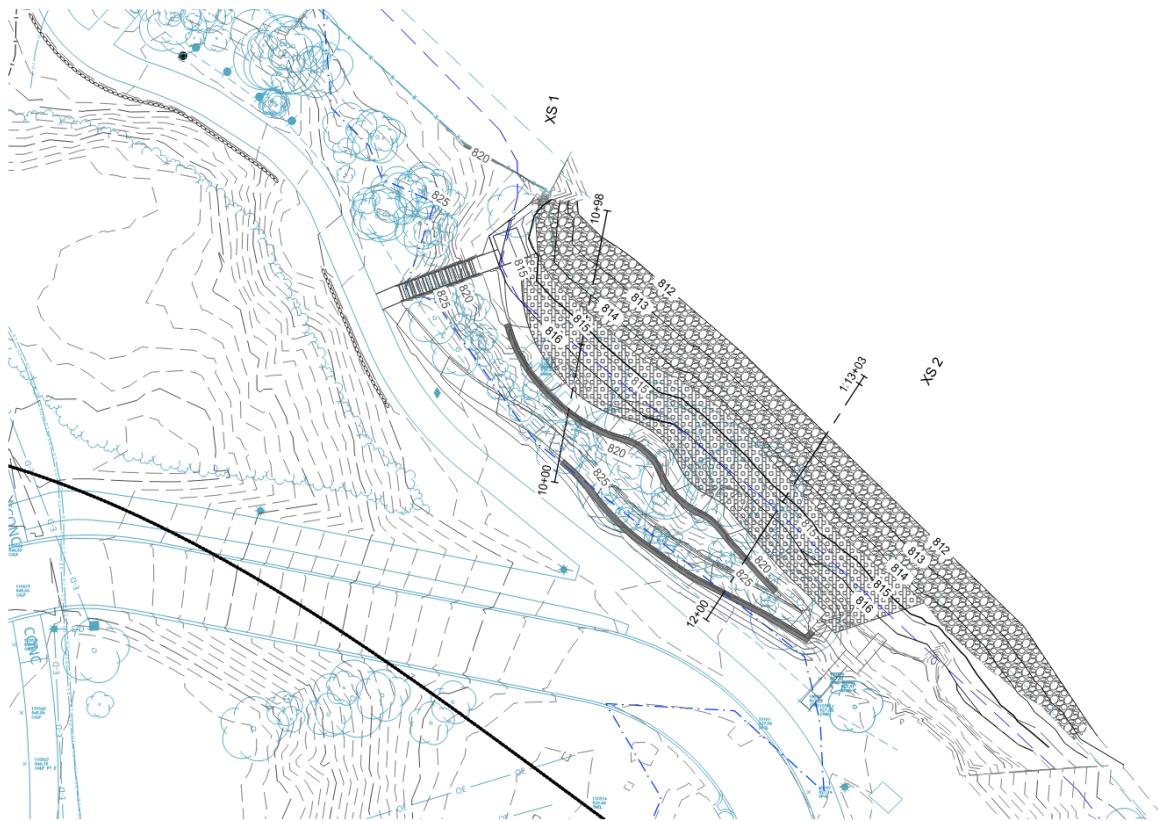

CROSS SECTION 1

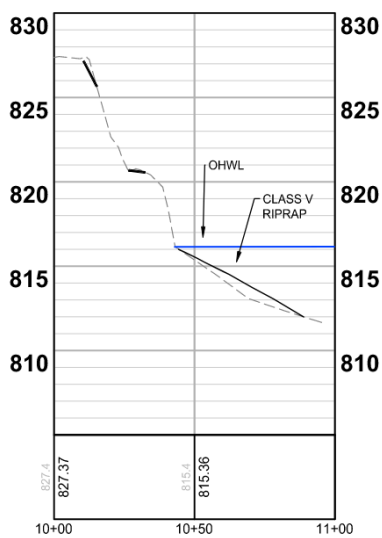

CROSS SECTION 2

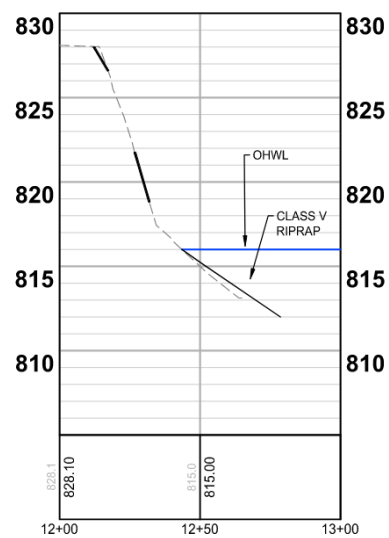
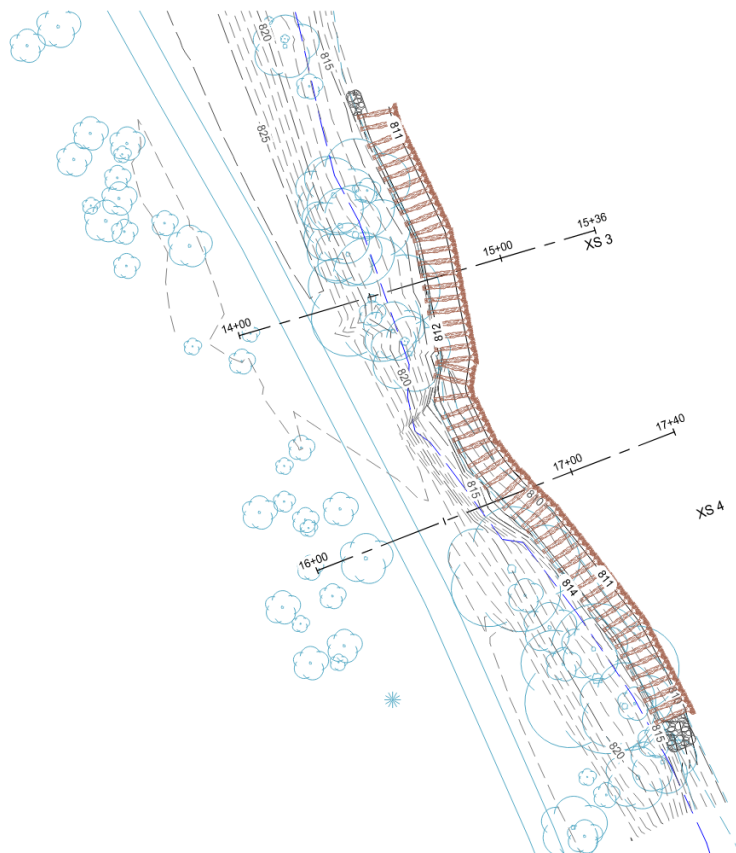
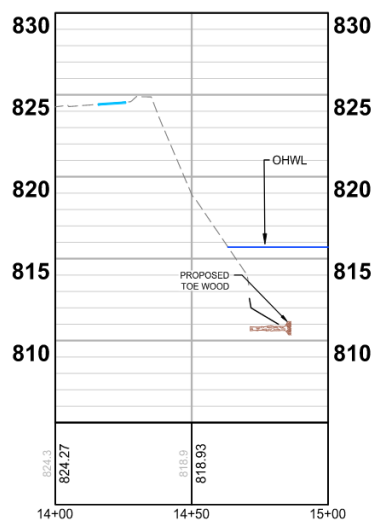

Figure 3. Work Area 2 from Design Plans.



CROSS SECTION 3



CROSS SECTION 4

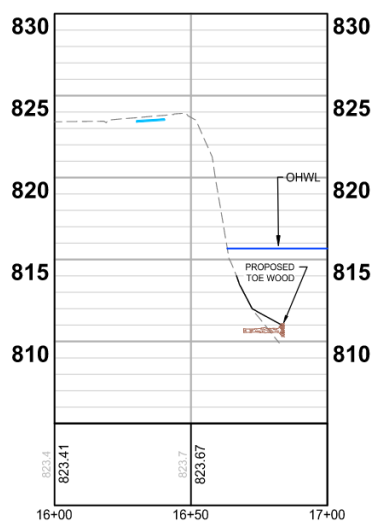
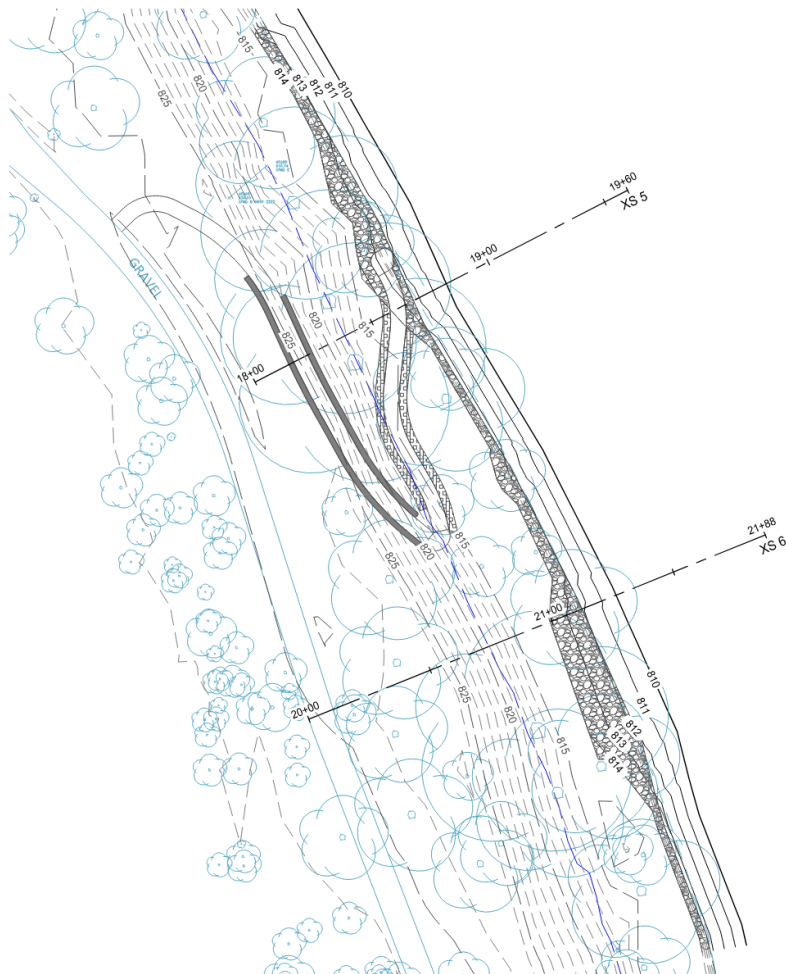
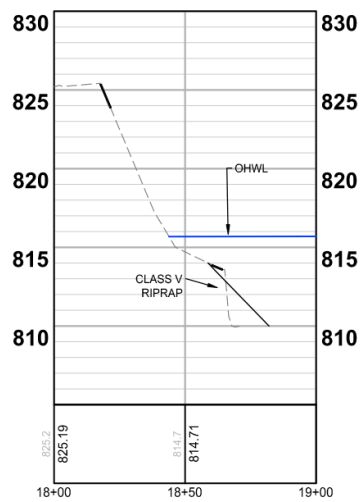

Figure 4. Work Area 3 from Design Plans.



CROSS SECTION 5



CROSS SECTION 6

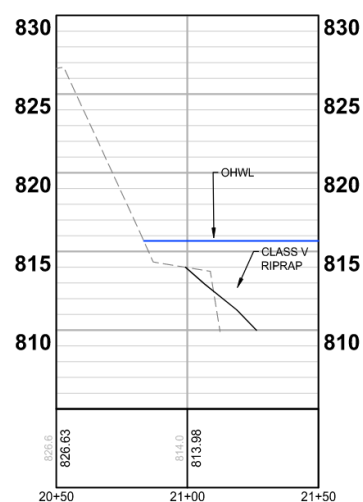

Figure 5. Work Area 4 from Design Plans.

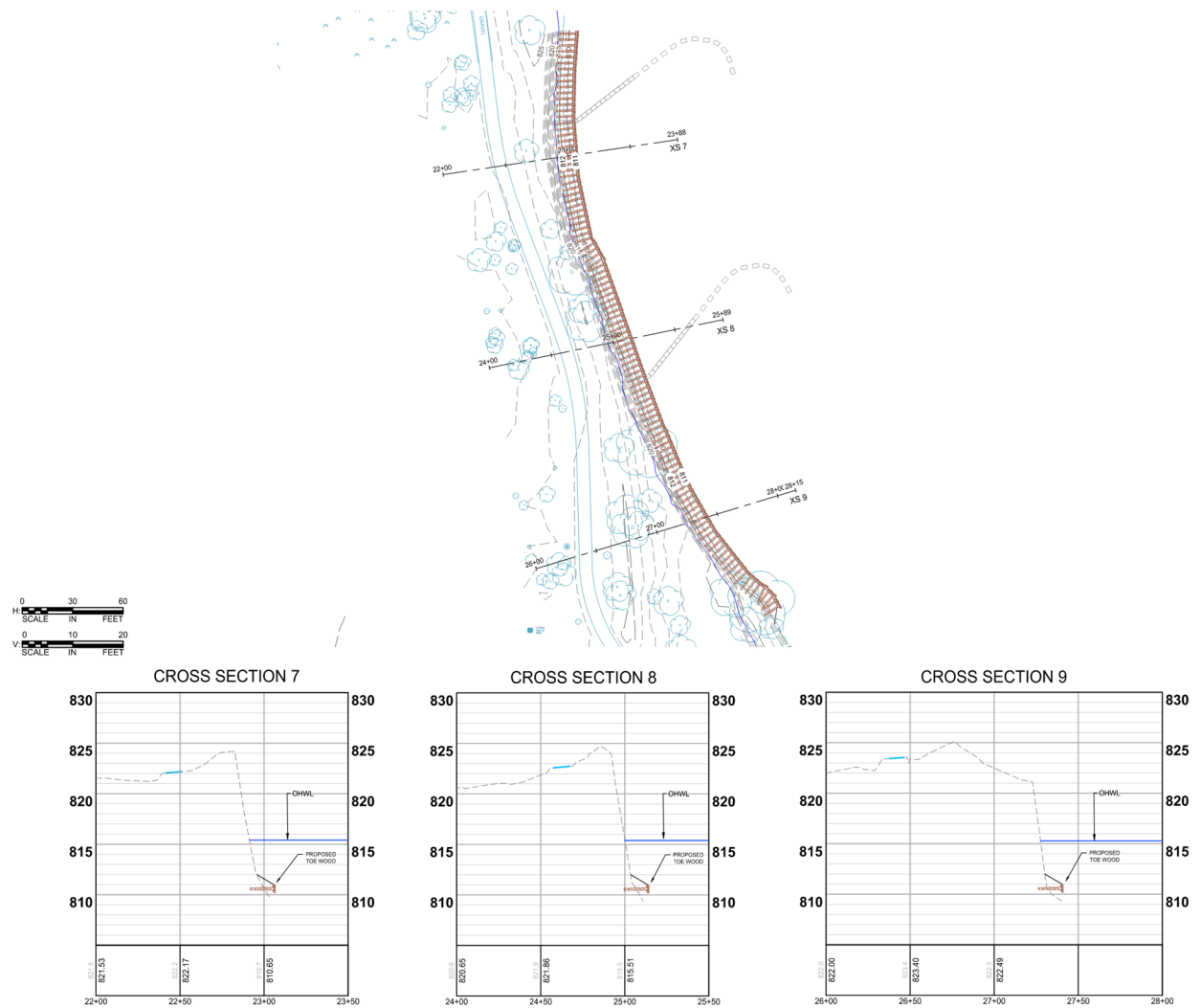

Figure 6. Work Area 5 from Design Plans.

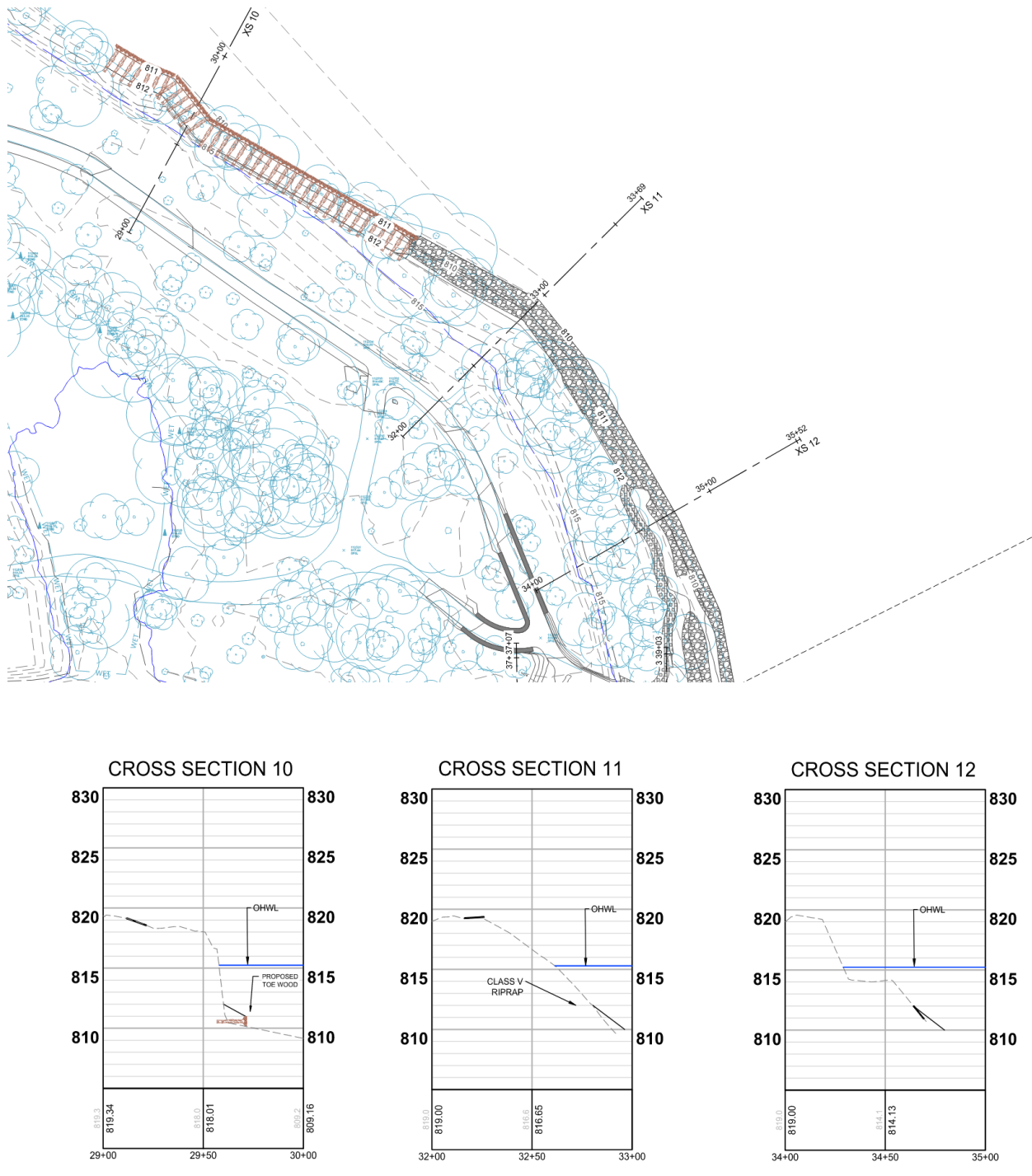
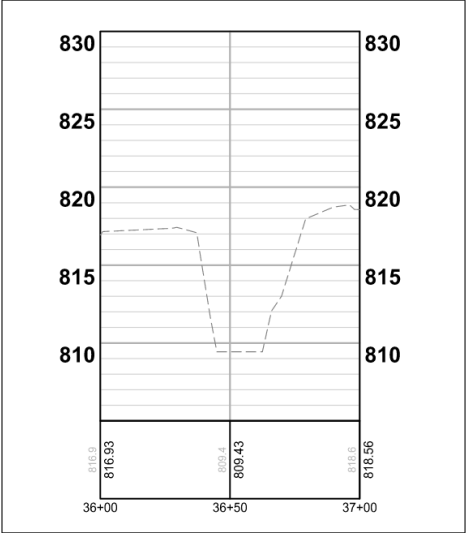

Figure 7. Work Area 6 from Design Plans.



CROSS SECTION 13



CROSS SECTION 14

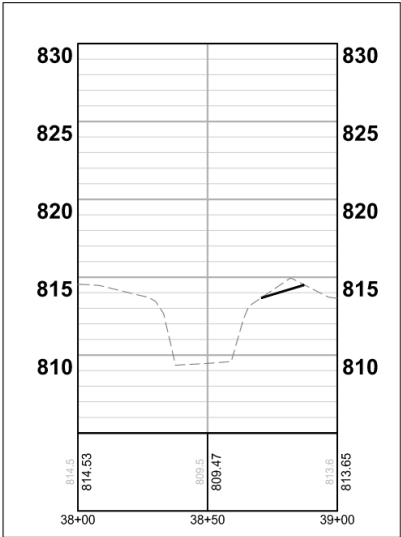



3235 Fernbrook Lane N • Plymouth, MN 55447
Phone (763) 553-1144 • Fax (763) 553-9326

www.shinglecreek.org

**West Mississippi
Watershed Management Commission
Partnership Cost-Share Program Guidelines**

The West Mississippi Watershed Management Commission will from time to time make funds available to its member cities to help fund the cost of Best Management Practices (BMPs) partnership projects with private landowners. The following are the guidelines for the award of cost-share grants from this program:

1. Projects on private property must be for water quality improvement and must be for improvement above and beyond what would be required to meet Commission rules. Only the incremental cost of “upsizing” a BMP above and beyond is eligible.
2. Priority is given to projects in a priority area identified in a subwatershed assessment or TMDL.
3. Consistent with the South Metro Turbidity TMDL, Mississippi River streambank stabilization projects are eligible provided: 1) a streambank assessment using the NRCS direct volume method rates the erosion severity as moderate or more severe; and 2) an annual TSS load reduction can be estimated.
4. Commission funds may reimburse up to 100% of the cost of the qualifying BMP.
5. The minimum cost-share per project is \$10,000 and the maximum is \$50,000.
6. Projects must be reviewed by the Technical Advisory Committee (TAC) and recommended to the Commissions for funding.
7. Cost-share is on a reimbursable basis following completion of project.
8. The TAC has discretion on a case-by-case basis to consider and recommend to the Commission projects that do not meet the letter of these guidelines.
9. Unallocated funds will carry over from year to year and be maintained in a designated fund account. Any balance in said account in excess of \$100,000 will be transferred to the City Cost Share Program Account.
10. The property owner must dedicate a public easement or equivalent sufficient to install and maintain the BMP.
11. The Member City must obtain a recordable maintenance agreement from the property owner that specifies maintenance requirements and schedule; authorizes the City to inspect the BMP and order maintenance and improvement; and authorizes the City to undertake ordered maintenance and improvement not completed by the property owner and assess the cost that work to the property.
12. The standard Commission/Member Cooperative Agreement will be executed prior to project construction.

Adopted August 12, 2021



3235 Fernbrook Lane N • Plymouth, MN 55447
Phone (763) 553-1144 • Fax (763) 553-9326

www.shinglecreek.org

**West Mississippi Watershed Management Commissions
Partnership Cost-Share Program Application**

City:	Brooklyn Park – Three Rivers Park District Mississippi Gateway
Contact Name:	Brian Vlach – Senior Manager of Water Resources
Contact Phone:	763-694-7846
Contact Email:	Brian.Vlach@ThreeRiversParkDistrict.org
Project Name:	Mississippi Gateway Regional Park Shoreland Stabilization
Total Project Cost:	\$557,534 = Construction (\$464,612) + Final Design (\$92,922) A more detailed cost estimate will be provided for the September 14 th West Mississippi Watershed Management Commission meeting
Amount Requested:	\$75,000
Project Location:	10360 West River Road, Brooklyn Park, MN 55444
Owner:	Three Rivers Park District
Address:	3000 Xenium Lane North
City, State, Zip:	Plymouth, MN 55441
Phone:	763-694-7846
Email:	Brian.Vlach@ThreeRiversParkDistrict.org

- 1. Describe the BMP(s) proposed in your project. Describe the current condition and how the BMP(s) will reduce pollutant loading and/or runoff volume. Note the estimated annual load and volume reduction by parameter, if known, and how they were calculated. Attach figures showing project location and BMP details including drainage area to the BMP(s).*

This proposed project is located within the West Mississippi Watershed drainage area at Three Rivers Park District Mississippi Gateway Regional Park in the City of Brooklyn Park. The project will reduce excessive sediment and nutrient loading from approximately 2200 linear feet of Mississippi River shoreline by stabilizing 5 separate areas of bank erosion and one area of gully erosion in an existing drainageway. A feasibility study (2021) was completed to evaluate and document the erosion conditions for each site and propose feasibility-level concepts for addressing each of the existing erosion areas. Since completion of the feasibility study, 90% design plans have been developed for the project and more conservative cost estimate has adjusted for the project. Due to the recent spring flooding in 2023, the project erosion areas identified in the feasibility study will be re-evaluated for implementation of stabilization practices as well as adjusting cost estimates as part of the final design phase of the project.

The feasibility study estimated that the existing erosion from the areas of concern contributes approximately 500 tons of sediment to the Mississippi River each year. Stabilizing these highly erosive areas would significantly reduce the sediment and nutrient loading to the Mississippi River. The feasibility study proposes to stabilize each of these highly erosive areas with a combination of best management practices that include the following: grading and re-sloping of banks, vegetated riprap, native plantings, rock deflectors, and toe wood. The details for the management practices used for each



3235 Fernbrook Lane N • Plymouth, MN 55447
Phone (763) 553-1144 • Fax (763) 553-9326

www.shinglecreek.org

erosive site are provided in the attached feasibility study as well as the 90% design plans that have been completed for the project.

It was estimated that the proposed stabilization practices for the project will reduce sediment loading by 312 tons/year and phosphorus loading by 266 lbs/year. Sediment loading rates (tons/year) were estimated based on bank height, length, recession rate, and soil bulk density from field and remote measurements. Soils throughout this reach of the Mississippi River were mostly sandy loams so an average bulk density of 103 lbs/ft³ was assumed for all banks. Bank recession rates were estimated using historical satellite imagery. Phosphorus load reduction was based on a phosphorus correction factor using the Board of Water and Soil Resources Water Erosion Pollution Reduction Estimator. The details of estimating sediment loss and bank recession rate as well as sediment/phosphorus loading reductions are provided in the feasibility study.

A primary benefit the project addresses is the nutrient and TSS impairments in the Mississippi River. The South Metro Mississippi River TSS TMDL sets a goal of a 20% reduction in TSS from the Upper Mississippi River basin to improve water quality in the river and reduce sedimentation to Lake Pepin. The Lake Pepin Nutrient TMDL sets a goal of reducing non-permitted sources of nutrients to the estimated natural background rate. This project would provide contribution to the overall cumulative load reductions that are identified and need to be accomplished incrementally in the Mississippi River and Lake Pepin TMDLs. The project will also help protect water quality in the river immediately downstream as well as help support nearshore habitat that is negatively impacted by the accumulation of sediment in spawning and emergent vegetation areas. The adjacent upland areas will have native plantings that will further enhance habitat for pollinators and other wildlife. This site is within the Mississippi River Corridor Critical Area in which protecting and preserving the natural, biological, ecological, and other values of the river to benefit the health and welfare of the citizens of the state as a priority.

This project also aligns with the statewide priority of restoring and protecting water resources for public use and public health including drinking water. The site is located within the Drinking Water Supply Management Area, where the impacts to drinking water from contamination can be minimized by preventive management. Streambank erosion is a high priority contaminant in the Minneapolis Source Water Protection Plan. Stabilizing these areas will reduce sediment and nutrient load to the Mississippi River and will help protect the drinking water source.

A secondary benefit of the project is improving water based recreational opportunities for the public on the Mississippi River. The 1.5 miles of natural shoreline of the Mississippi River has become a key feature of the Mississippi Gateway Regional Park. The park receives approximately 472,900 annual visitors with 165,000 of these visits occurring during the summer to take advantage of the amenities the park provides for the public. There are approximately 8,800 summer visits that come to the park specifically for shoreline fishing opportunities, which is an average of about 95 fishing visitors per summer day. This park receives the most fishing visitors in comparison to all the other Three Rivers Parks. The park also has a kayak/canoe rental facility providing access to the Mississippi River. The proposed project includes the construction of 3 to 5 fishing access platforms to improve shoreline fishing opportunities along the Mississippi River. The park also has a Nature Center that provides unique



3235 Fernbrook Lane N • Plymouth, MN 55447
Phone (763) 553-1144 • Fax (763) 553-9326

www.shinglecreek.org

outdoor recreation and nature based educational programs for the public. Additional amenities the park provides is a spectacular view of the Mississippi River that includes picnic areas, scenic overlook areas, and hiking trails.

The Three Rivers Park District and City of Brooklyn Park are partnering to renovate and create a reimagined Mississippi Gateway Regional Park where these park amenities will be improved for the public. The City of Brooklyn Park owns approximately 97 acres on the west side of West River Road, and Three Rivers Park District owns 165 acres along the Mississippi River corridor on the east side of West River Road. The coordinated partnership will provide expanded and improved amenities for the public. This Mississippi Gateway Regional Park has become a popular destination for under-represented communities providing inclusive and equitable access to outdoor recreational programs and activities. Upon completion of the entire park reconstruction, visitation is expected to increase by at least 50 percent for an estimated 725,000 annual visitors. The proposed project will further compliment the major park re-construction/renovation efforts that will better provide local community benefit.

2. If this request is for cost share in “upsizing” a BMP, explain how the upsize cost and benefit were computed.

The project proposes stream bank restoration and stabilization on highly eroded areas on the Mississippi River. This project would not be considered as increasing the size of an existing BMP.

3. Show total project cost and the amount of cost share requested.

The feasibility study estimated construction cost for the project was approximately \$258,000. Since the completion of the feasibility study, 90% design plans have been completed and a more conservative cost estimate for construction of the project has been adjusted in the below table. A more detailed cost estimate will be provided for the West Mississippi Watershed Management Commission meeting on September 14th of 2023.



3235 Fernbrook Lane N • Plymouth, MN 55447
Phone (763) 553-1144 • Fax (763) 553-9326

www.shinglecreek.org

Bank	Proposed Stabilization	Restoration	Construction
	Method	Linear Feet	Costs
Bank-1-Upstream	Vegetated Riprap, grading, wing wall reconstruction, native plantings	250	\$94,548
Bank 2	Vegetated Riprap, grading, native plantings	270	\$44,164
Bank 3	Vegetated riprap, grading, native plantings	400	\$67,580
Bank 4	Toe wood, rock deflectors, grading, native plantings	550	\$64,304
Bank 5 Drainageway	Toe wood, rock deflectors, grading, native plantings	960	\$129,932
Subtotal Construction Costs			\$400,528.00
Contingency 16%			\$64,084.48
Total Shoreline Stabilization Construction Costs			\$464,612.48



3235 Fernbrook Lane N • Plymouth, MN 55447
Phone (763) 553-1144 • Fax (763) 553-9326

www.shinglecreek.org

The estimated construction costs and phosphorus removal for each site was used to conduct a cost-benefit analysis. The cost-benefit analysis in the below table assumes a project life expectancy of 30-years.

Bank	Proposed Stabilization Method	Load Reduction		Phosphorus Removal
		Sediment (tons/year)	Phosphorus (lbs/year)	Cost Benefit (\$/lb)
Bank-1-Upstream	Vegetated Riprap, grading, wing wall reconstruction, native plantings	18.07	15.4	\$211
Bank 2	Vegetated Riprap, grading, native plantings	5.52	4.7	\$313
Bank 3	Vegetated riprap, grading, native plantings	10.42	8.9	\$253
Bank 4	Toe wood, rock deflectors, grading, native plantings	261.45	222.2	\$9
Bank 5 Drainage Way	Toe wood, rock deflectors, grading, native plantings	16.81	14.3	\$303

Based on the conservative cost estimate for construction of the project, a cost-benefit analysis estimated for phosphorus reduction indicated that the implementation of erosion stabilization practices while assuming a 30-year life expectancy of the project would cost \$9 to \$313 per pound of phosphorus removed. Due to the recent spring flooding in 2023, the project erosion areas identified in the feasibility study will be re-evaluated for implementation of stabilization practices as well as adjusting cost estimates as part of the final design phase of the project.

Three Rivers Park District is currently securing funding for the project. The park district has already received a National Park Service Grant of \$150,000 for the project. The Park District is requesting a total of \$75,000 as the partnership cost-share amount from the West Mississippi Watershed Management Commission. The Park District will also be submitting a Conservation Partners Legacy (CPL) Grant application to secure additional funding toward the project. A cost-share partnership and securing additional funding from the West Mississippi Watershed Management Commission will be used to supplement final design and construction costs as well as strengthen the CPL grant application.



3235 Fernbrook Lane N • Plymouth, MN 55447
 Phone (763) 553-1144 • Fax (763) 553-9326

www.shinglecreek.org

4. What is the project schedule, when will work on the BMP(s) commence and when will work be complete?

The below table provides a schedule for the project tasks that will need to be completed for the project. It is anticipated that construction of the project will occur the winter of 2024/2025 with a substantial completion date of April of 2025.

Task	2023					2024												2025			
	Aug	Sept	Oct	Nov	Dec	Jan	Feb	Mar	Apr	May	Jun	Jul	Aug	Sept	Oct	Nov	Dec	Jan	Febr	Mar	Apr
Mississippi Gateway Partnership Cost-Share Application																					
Conservation Partners Legacy Grant Program Application																					
Re-Survey Erosion Areas																					
Final Design Plans & Cost Estimate																					
Permitting																					
Request for Bids																					
Award of Contract																					
Construction																					

The member City must verify that a public easement (or equivalent) is dedicated and that an Operations and Maintenance Agreement has been executed and recorded prior to release of any funds.



SHINGLE CREEK / WEST MISSISSIPPI WATERSHED MANAGEMENT COMMISSION
MONTHLY COMMUNICATION LOG
September 2023

Date	From	To	SC	WM	Description
8/16/23	Katie Kemmitt	Amy Timm, MPCA	X		Request to extend Crystal Lake 319 grant through end of 2023. Request was granted and will allow for final sediment cores and monitoring to be paid through grant funding.
8/21/23	Ali Stone	CAMP volunteers	X		Retrieved lake water quality samples from volunteers to be picked up by Metropolitan Council staff.
8/22/23	Max Hurd, Twin Lake resident	Judie Anderson, Katie Kemmitt	X		Request for Twin Lake aquatic vegetation data and herbicide permitting assistance.
8/23/23	April Londo, DNR	Katie Kemmitt	X	X	Request for Meadow Lake pre and post herbicide treatment vegetation data.
8/31/23	Mat Cox, Kimley-Horn	Todd Shoemaker	X		Pre-submittal meeting for forthcoming project review
9/1/23	Linnea Wier, City of Burnsville	Katie Kemmitt	X		Meeting to discuss lessons learned from Bass Lake vegetation transplants, follow-up email to share results.
9/5/23	Katie Kemmitt, Diane Spector	Steve Christopher, BWSR	X		Request to extend Meadow Lake Clean Water Fund grant through end of 2024.

To: Shingle Creek/West Mississippi WMO Commissioners

From: Todd Shoemaker, PE, CFM
Diane Spector
Katie Kemmitt

Date: September 6, 2023

Subject: September 2023 Staff Report

**Recommended
Commission Action**

For discussion and information.

General Updates*Highways 252/94 EIS Review*

No updates or meetings of the Highway 252/I-94 working group since the Draft Scoping Decision Document (DSDD) comments were submitted during the public comment period in May. MnDOT has not provided any recent updates and the draft Environmental Impact Statement is still scheduled to be released for public comment this fall 2023.

Project Updates*Meadow Lake*

Staff are working with Board of Water and Soil Resources to extend the Meadow Lake Clean Water Fund Projects and Practices grant through the end of 2024, one year longer than originally planned. The grant extension will allow the Commission to spend more grant funds on monitoring and adaptive management.

Legal Boundary Update

Hennepin County reported on September 7, 2023, "We have implemented the unique taxing area changes, and they will be used for both payable 2024 proposed TNT [Truth in Taxation] statements and final tax statements and subsequent years."

Eagle Lake Subwatershed Assessment

In-lake sediment evaluations are complete for Eagle and Pike Lakes and suggest a need for alum treatment in these lakes. The results of a Cedar Island study by the City of Maple Grove are expected to be complete prior to the October meeting to allow a full picture of inputs and impact of upstream lakes on Eagle Lake. For watershed load reductions, the set of potential projects prioritized based on water quality impact and cost will be presented in October to select one project to move forward to concept design if appropriate for the lake's needs.

Gaulke Pond Subwatershed Assessment

Stantec has been working with the City of Crystal to refine the selected BMP, an infiltration trench along Colorado Avenue. Concerns were raised due to the BMP's proximity to the City's drinking water reservoir and Stantec was asked to review the underlying soils' bearing capacity (i.e., the soils' ability to support infiltration and maintain their structural integrity) and if additional geotechnical investigations or structures may be warranted to protect the reservoir. Following these efforts, an update will be provided to the TAC and final plans will be developed for acceptance by the Commission.

Shingle Creek Brookdale Park Remeander

Stantec revised the concept alternatives based on City of Brooklyn Park feedback and met with City staff and community at a public engagement meeting in August 2023. The City is gathering additional input from residents and plans to discuss the concepts and input received at their next City Council work session. Stantec has scheduled a coordination call with the City for September 8th before progressing the project's preliminary design plans.

Shingle Creek Trail Bank Stabilization and Fish Access Improvements

Stantec revised the concept alternatives based on City of Brooklyn Park feedback and met with City staff and community at a public engagement meeting in August 2023. The City is gathering additional input from residents and plans to discuss the concepts and input received at their next City Council work session. Stantec has scheduled a coordination call with the City for September 8th before progressing the project's preliminary design plans.

Mississippi Riverbank Stabilization Feasibility Study

Stantec coordinated and led the study kickoff meeting on Tuesday, September 5. Meeting attendees included Erik Megow, Ed Matthiesen and Todd Shoemaker from Stantec; Brooklyn Center Commissioner David Mulla; Kris Guentzel from Hennepin County; Mitch Robinson from Brooklyn Park; and Nathan Wallerstedt and Nick (last name not recorded) from the Corps of Engineers. Guentzel and Robinson will draft an email to residents requesting interest in additional study. From that list, Megow and Matthiesen will select 5-6 properties to visit in October to begin the evaluation. Corps of Engineers funding is unlikely applicable to this type of project because it does not specifically protect major infrastructure.

To: Shingle Creek/West Mississippi WMO Commissioners
From: Todd Shoemaker, P.E.
Date: September 6, 2023
Subject: September 14 Watershed Tour Agenda

**Recommended
Commission Action**

None, for information.

Immediately following the Commission meeting on September 14, 2023, Commissioners and TAC members are invited to attend a bus tour of the watershed. The tour bus will depart the Plymouth Community Center shortly after adjournment of the Commission meeting (2:00 PM?) and continue to the locations noted below. We expect to return to the Community Center at approximately 4:45 PM. If you are unable to attend the entire tour, you may provide your own transportation and join us at tour stops as your schedule allows.

See you on the bus!

- 2:00 Depart Plymouth Community Center
- 2:25 Arrive Crystal Lake (3769 Crystal Lake Blvd, Robbinsdale; speaker Mike Sorenson; restroom available)
- 2:40 Depart Crystal Lake
- 2:55 Arrive Brookdale Park (4408 75th Ave, Brooklyn Park; Todd Shoemaker)
- 3:10 Depart Brookdale Park
- 3:15 Arrive Brook Gardens (5550 69th Ave N, Brooklyn Park; Laura Scholl)
- 3:30 Depart Brook Gardens
- 3:45 Arrive Bass Creek (6667 Boone Ave, Brooklyn Park; Todd Shoemaker)
- 4:00 Depart Bass Creek
- 4:15 Arrive Meadow Lake (8404 E Meadow Lake Road, New Hope; Nick Macklem)
- 4:30 Depart Meadow Lake
- 4:45 Arrive Plymouth Comm Center.

Z:\Shingle Creek\Meetings\Meetings 2023\M-Watershed Tour Agenda.docx