

## Shingle Creek Watershed Management Commission - 2019 Treasurer's Report

		2019 Budget	February	March	%age YTD	2019 YTD
<b>REVENUE</b>	%age					
Application Fees		22,000	4,400.00		25.00	5,500.00
Assessments		356,900	274,997.88		77.05	274,997.88
Interest and Dividends		3,000	2,145.46		142.19	4,265.64
Education Reimbursement		33,000	15,000.00		45.45	15,000.00
Rain Garden Workshops		6,000	11,772.75		-	-
<i>Transfer to (from) Grants (see following pages)</i>			10,021.28	-		-
<i>Transfer to (from) CIPs</i>						-
<i>Transfer to (from) Closed Projects Account</i>						-
<b>TOTAL REVENUE</b>		<b>420,900</b>	<b>318,337.37</b>	<b>-</b>		<b>299,763.52</b>
<b>EXPENSES</b>			<b>2018 Activity</b>			
<b>ADMINISTRATION</b>						
Administrative Services		71,000	4,430.60	4,495.54	12.57	8,926.14
Engineering Support		17,000	1,479.98	811.70	13.48	2,291.68
Project Reviews/WCA-Incl Blue Line Ext.		1,700	145.08	223.86	21.70	368.94
Hydraulic/hydrologic Modeling Updates						-
<b>ENGINEERING</b>						
Administration		62,000	6,702.64	5,627.36	19.89	12,330.00
Grant Application Writing		10,000	843.46	7,828.90	86.72	8,672.36
Project Reviews/WCA		37,000	4,281.50	8,082.50	33.42	12,364.00
TMDL 5 Year Reviews/CIP Engineering		12,000	77.40	1,836.30	15.95	1,913.70
LEGAL - Legal Services		6,000	622.35	367.60	6.13	367.60
<b>MISCELLANEOUS</b>						
Bookkeeping		7,000	350.34	587.76	13.40	938.10
Audit		6,000			-	-
Insurance & Bonding		3,100			-	-
Meeting Expense		4,700	348.10		15.57	731.61
<b>PROGRAMS</b>						
Citizen Assisted Lake Monitoring (CAMP)		3,800			-	-
Stream Monitoring		37,100	1,595.04	1,322.70	7.86	2,917.74
Monitoring Equipment		3,000				
Volunteer Wetland Monitoring (WHEP)		2,000			-	-
Volunteer Stream Monitoring (River Watch)		2,000			-	-
Intensive Lake TMDL Monitoring		22,500	581.90	82.50	2.95	664.40
Annual Monitoring Report		14,000	3,633.21	8,184.40	84.41	11,817.61
Water Quality Education						
Education Program		15,000	1,336.08	1,057.68	19.29	2,893.76
WMWA Ed/Watershed Prep		18,000		805.52	4.48	805.52
WMWA General Programs		20,000	998.42	440.97	7.20	1,439.39
WMWA Special Projects		6,500	469.23	360.00	12.76	829.23
Rain Garden Workshops		8,000		4,500.00	56.25	4,500.00
Education Grants		500			-	-
Subwatershed BMP Assessment		0			-	-
Third Gen Plan/Amendments		1,000			-	-
Flood Modeling and Mapping		25,000	6,987.40	3,278.70	41.06	10,266.10
Contribution to 4th Generation Plan		5,000			-	-
<i>Transfer to (from) Grants (see following pages)</i>			15,472.59	7,016.69		22,489.28
<i>Transfer to (from) CIPs</i>			50,119.40			-
<i>Transfer to (from) Closed Projects Account</i>						-
<b>TOTAL OPERATING EXPENSE</b>		<b>420,900</b>	<b>100,474.72</b>	<b>56,910.68</b>		<b>107,527.16</b>
<b>CASH SUMMARY</b>						
<b>4M Fund Balance at 12/31/18</b>						<b>1,162,466.36</b>
<b>Plus Revenue Received 2018 to date</b>						<b>322,156.29</b>
<b>Minus Claims Approved to Date</b>						<b>(132,830.07)</b>
<b>Minus Claims Presented Current Month</b>						<b>(56,910.68)</b>
<b>Fund Balance</b>			<b>1,351,792.58</b>			<b>1,294,881.90</b>

## Shingle Creek Watershed Management Commission - 2019 Treasurer's Report

Claims Presented March 14, 2019	General Ledger Acct No	February	March	Total
Kennedy & Graven				367.60
Legal - General	52001		367.60	
JR Commercial Fishing -TL Carp Removal	70723		2,800.00	2,800.00
Lawn Chair Gardener - WMWA Media	57010		360.00	360.00
Metro Blooms - Rain Garden Workshops	57002		4,500.00	4,500.00
Mary Amsden - WMWA Ed Services	57011			-
Mary Amsden - WMWA Ed Reimbursement	57012			
Sharon Meister - WMWA Ed Services	57011		720.00	780.32
Sharon Meister - WMWA Ed Reimbursement	57012		60.32	
Wenck Associates				41,212.05
General Engineering	51001		5,627.36	
Grant Applica/Research	51005		7,828.90	
Project Reviews	51002		8,082.50	
Flood Modeling and Mapping	51015		3,278.70	
Plan Amendment	51007			
Stream Monitoring	56004		1,322.70	
Intensive Lake TMDL Monitoring	56010		82.50	
TMDL 5-Year Reviews	56011		1,836.30	
Education	57008		752.00	
Education - WMWA	57009			
Annual Water Quality Report	58002		8,184.40	
Twin Lake Carp Management Grant	70723		1,376.43	
BioChar Project Grant	70725		993.10	
Minneapolis SWA Grant	70726		1,778.40	
Bass/Pomerleau Alum Trmt Grant	70727			
SRP Reduction Grant	70729		68.76	
Judie Anderson's Secretarial Service				466.17
WMWA General Expense	57009		440.97	
WMWA Educators/WS Prep	57011		25.20	
Judie Anderson's Secretarial Service				6,424.54
Administration	53001		4,495.54	
Project and WCA Review Support	53002		223.86	
Bookkeeping	54002		587.76	
Hydraulic/Hydrologic Modeling Updates	53005			
Education Programs	57008		305.68	
Engineering Support	53004		811.70	
Engineering Support - CIP General	53004			
Engineering Support - Plan Amendment	53007			
Bass/Pomerleau Alum Prelim Design	58027			
Eng Support - Twin Lake Carp Mgt CIP	70809			
<b>Total Claims</b>				<b>56,910.68</b>
				
<b>Judie A Anderson, Deputy Treasurer</b>				

## Shingle Creek Watershed Management Commission - 2019 Treasurer's Report

	Total Grant	February	March	%age YTD	YTD
<b>GRANTS</b>					
Twin Lake Carp Management Grant	100,000				
Revenue		3,206.25			-
Expense		5,188.59	4,176.43		9,365.02
Balance		(1,982.34)	(4,176.43)		(9,365.02)
BioChar Project Grant	154,300				
Revenue		6,815.03			-
Expense		2,130.30	993.10		3,123.40
Balance		4,684.73	(993.10)		(3,123.40)
Becker Park Grant	725,000				
Revenue					-
Expense					-
Balance		-	-		-
Minneapolis Subwatershed Assmt Grant	38,000				
Revenue					-
Expense		7,919.10	1,778.40		9,697.50
Balance		(7,919.10)	(1,778.40)		(9,697.50)
Bass/Pomerleau Lakes Internal Load Reduction	267,040				
Revenue					-
Expense		234.60			234.60
Balance		(234.60)	-		(234.60)
BWSR Watershed Based Funding	103,571				
Revenue					-
Expense					-
Balance		-	-		-
SRP Reduction Project	72,170				
Revenue					-
Expense			68.76		68.76
Balance		-	(68.76)		(68.76)
<b>TOTAL GRANTS</b>					
<b>Revenue</b>		<b>10,021.28</b>	<b>-</b>		<b>-</b>
<b>Expense</b>		<b>15,472.59</b>	<b>7,016.69</b>		<b>22,489.28</b>
<b>Balance</b>		<b>(5,451.31)</b>	<b>(7,016.69)</b>		<b>(22,489.28)</b>
		<b>2018 Activity</b>			

## Kennedy & Graven, Chartered

200 South Sixth Street, Suite 470  
Minneapolis, MN 55402

Shingle Creek Watershed  
Judie Anderson

January 31, 2019

SH220-00001    General

Through January 31, 2019

For All Legal Services As Follows:

			Hours	Amount
1/10/2019	TJG	Prepare for, travel to, and participate in meeting	1.70	341.70
1/22/2019	TJG	Review and respond to email from Ed M regarding contracting procedures	0.10	20.10
<b>Total Services:</b>			<b>\$</b>	<b>361.80</b>

For All Disbursements As Follows:

1/10/2019	Troy Gilchrist; Mileage expense	5.80
<b>Total Disbursements:</b>		<b>\$ 5.80</b>

**Total Services and Disbursements:    \$            367.60**

**Kennedy & Graven, Chartered**

200 South Sixth Street, Suite 470  
Minneapolis, MN 55402

(612) 337-9300

41-1225694

February 28, 2019

Statement No. 147412

Shingle Creek Watershed Management Commission

Judie Anderson

JASS - Watershed Administrators  
3235 Fernbrook Lane  
Plymouth, MN 55447

Through January 31, 2019

SH220-00001      General

367.60

**Total Current Billing:** 367.60

I declare, under penalty of law, that this account, claim or demand is just and correct and that no part of it has been paid.

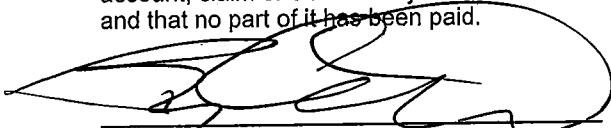
  
\_\_\_\_\_  
Signature of Claimant

**Lawn Chair Gardener**  
5901 Birchwood St.  
Shoreview, MN 55126  
(651) 485-5171  
dawn@lawnchairgardener.com  
www.lawnchairgardener.com



## Invoice

**BILL TO**  
WMWA  
3235 Fernbrook Lane N.  
Plymouth, MN 55447

**INVOICE #** 1154  
**DATE** 03/04/2019  
**DUE DATE** 04/03/2019  
**TERMS** Net 30

---

ACTIVITY	QTY	RATE	AMOUNT
<b>Social Media</b> February 2019: 2 hours/week x 4 weeks	8	40.00	320.00
<b>Social Media</b> Reports	1	40.00	40.00

---

BALANCE DUE

**\$360.00**

# Metro Blooms Invoice

PO Box 17099  
Minneapolis, MN 55417  
651-699-2426  
www.metroblooms.org

3/6/2019

Attn: Amy Juntunen  
West Metro Watershed Alliance



Three Creating Resilient Yard Workshops:

Champlin, April 4, 2019  
Crystal, May 9, 2019  
Plymouth, May 2, 2019

Credit for 3 WMO's BT partnership

Total cost for 2019	\$	10,500.00
	\$	(1,500.00)
Total amount due up front	\$	4,500.00
Total due by April 6, 2019	\$	<u>4,500.00</u>

This invoice represents services provided by Metro Blooms for three workshops in WMWA in 2019. Blue Thumb partner fees have already been received. Balance will be due upon completion of workshops.

Please remit to: Metro Blooms, PO Box 17099, Minneapolis, MN 55417. Questions: (651) 699-2426

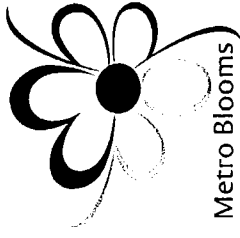

Sharon Meister  
 8540 Cain Rd  
 Corcoran, MN 55340

West Metro Water Alliance  
 3235 Fernbrook Lane  
 Plymouth, MN 55447

Invoice Date: February 28, 2019

**Log of Services**

Date	Description	Hours	Extended (\$40/hr)	Mileage	Extended (0.58/mi)	Supplies/Fees
			-		-	
			-		-	
			-		-	
<b>Total - WMWA Meetings</b>			\$ -		\$ -	\$ -
			-		-	
			-		-	
			-		-	
			-		-	
			-		-	
			-		-	
<b>Total - Program Development/Communication</b>			\$ -		\$ -	\$ -
2/6/2019	Lakeview	4.00	160.00	32.00	18.56	
2/21/2019	Lakeview	4.00	160.00	32.00	18.56	
2/27/2019	Hassan	5.00	200.00	20.00	11.60	
2/28/2019	Hassan	5.00	200.00	20.00	11.60	
			-		-	
			-		-	
			-		-	
			-		-	
			-		-	
			-		-	
			-		-	
			-		-	
			-		-	
			-		-	
<b>Total-Classroom/Community Events</b>			\$ 720.00		\$ 60.32	\$ -
<b>Total:</b>		18.00	\$ 720.00	104.00	\$ 60.32	\$ -

**Invoice Total \$ 780.32**

720.00	57011	WMWA Ed Regular Services
60.32	57012	WMWA Ed Reimbursed Expense
780.32	<b>TOTAL</b>	



**CONTRACTORS INVOICE**

WORK PERFORMED AT:

TO: Wenck  
7500 Olson Memorial Hwy Suite 300  
Golden Valley MN 55427

MIDDLE TWIN  
Jeff Riedemann  
2953 320th Ave. NW  
Cambridge, MN 55008

DATE 3/12/19

YOUR WORK ORDER NO.

OUR BID NO.

**DESCRIPTION OF WORK PERFORMED**

Plow 3 times, pre-line haul  
show up with full crew.

Jeff Riedemann

Tom Long

3/12/19

All Material is guaranteed to be as specified, and the above work was performed in accordance with the drawings and specifications provided for the above work, and was completed in a substantial workmanlike manner for the agreed sum of \_\_\_\_\_

Two thousand eight hundred Dollars (\$ 2800 )

This is a  Partial  Full invoice due and payable by: March Month          Day          Year

in accordance with our  Agreement  Proposal No.          Dated          Month          Day          Year

**Invoice**

March 8, 2019  
 Invoice No: 11901304



Ms. Judie Anderson  
 Shingle Creek Watershed Management Comm.  
 3235 Fernbrook Lane  
 Plymouth, MN 55447

Responsive partner.  
 Exceptional outcomes.

Project Manager Edward Matthiesen

Project B1240-0204 2019 General Engineering

**Professional Services Through February 28, 2019**

**Professional Personnel**

	<b>Hours</b>	<b>Rate</b>	<b>Amount</b>	
Jonett, Lucius	.50	145.00	72.50	
Kaczmarek, Hagen	15.30	120.00	1,836.00	
Matthiesen, Edward	5.60	198.00	1,108.80	
Spector, Diane	13.80	188.00	2,594.40	
Totals	35.20		5,611.70	
<b>Total Labor</b>				<b>5,611.70</b>

**Reimbursable Expenses**

Mileage - Reimbursable			15.66	
<b>Total Reimbursables</b>			<b>15.66</b>	<b>15.66</b>

**Total Invoice Amount \$5,627.36**

	<b>Current</b>	<b>Prior</b>	<b>Total</b>
<b>Billing Summary</b>	<b>5,627.36</b>	<b>6,702.64</b>	<b>12,330.00</b>

**Invoice**

March 8, 2019  
Invoice No: 11901366



Ms. Judie Anderson  
Shingle Creek Watershed Management Comm.  
3235 Fernbrook Lane  
Plymouth, MN 55447

Responsive partner.  
Exceptional outcomes.

Project Manager Diane Spector

Project B1240-0207 2019 Grant Writing  
**Professional Services Through February 28, 2019**

**Professional Personnel**

	<b>Hours</b>	<b>Rate</b>	<b>Amount</b>	
Anderson, Chad	9.50	168.00	1,596.00	
Nalven, Sarah	4.30	108.00	464.40	
Spector, Diane	27.50	188.00	5,170.00	
Stone, Alicia	9.50	63.00	598.50	
Totals	50.80		7,828.90	
<b>Total Labor</b>				<b>7,828.90</b>

**Total Invoice Amount \$7,828.90**

<b>Billing Summary</b>	<b>Current</b>	<b>Prior</b>	<b>Total</b>
	<b>7,828.90</b>	<b>843.46</b>	<b>8,672.36</b>

**Invoice**

March 8, 2019  
 Invoice No: 11901305



Ms. Judie Anderson  
 Shingle Creek Watershed Management Comm.  
 3235 Fernbrook Lane  
 Plymouth, MN 55447

Responsive partner.  
 Exceptional outcomes.

Project Manager Edward Matthiesen

Project B1240-0209 2019 Project Reviews

**Professional Services Through February 28, 2019**

Phase 01 2019 General Project Reviews

2019 General Project Reviews

**Professional Personnel**

	<b>Hours</b>	<b>Rate</b>	<b>Amount</b>	
Matthiesen, Edward	9.20	198.00	1,821.60	
Nalven, Sarah	2.50	108.00	270.00	
Spector, Diane	.80	188.00	150.40	
Totals	12.50		2,242.00	
<b>Total Labor</b>				<b>2,242.00</b>
				<b>Phase Total \$2,242.00</b>

Phase 02 WCA Administration

WCA Administration

**Professional Personnel**

	<b>Hours</b>	<b>Rate</b>	<b>Amount</b>	
Boll, Wesley	.30	158.00	47.40	
Dietrich, Meaghan	5.70	120.00	684.00	
Totals	6.00		731.40	
<b>Total Labor</b>				<b>731.40</b>
				<b>Phase Total \$731.40</b>

Phase 18004 Park 81

Park 81

**Professional Personnel**

	<b>Hours</b>	<b>Rate</b>	<b>Amount</b>	
Weigel, Eileen	.70	145.00	101.50	
Totals	.70		101.50	
<b>Total Labor</b>				<b>101.50</b>
				<b>Phase Total \$101.50</b>

Phase 19001 New Hope City Hall - North

New Hope City Hall - North

**Professional Personnel**

	<b>Hours</b>	<b>Rate</b>	<b>Amount</b>	
Matthiesen, Edward	2.10	198.00	415.80	

Nalven, Sarah	8.40	108.00	907.20	
Totals	10.50		1,323.00	
<b>Total Labor</b>				<b>1,323.00</b>
			<b>Phase Total</b>	<b>\$1,323.00</b>

Phase 19002 Rockford Road and I-494 Interchange  
 Rockford Road and I-494 Interchange

**Professional Personnel**

	Hours	Rate	Amount	
Matthiesen, Edward	.80	198.00	158.40	
Nalven, Sarah	.80	108.00	86.40	
Totals	1.60		244.80	
<b>Total Labor</b>				<b>244.80</b>
			<b>Phase Total</b>	<b>\$244.80</b>

Phase 19003 Windsor Ridge  
 Windsor Ridge

**Professional Personnel**

	Hours	Rate	Amount	
Matthiesen, Edward	2.20	198.00	435.60	
Nalven, Sarah	8.20	108.00	885.60	
Totals	10.40		1,321.20	
<b>Total Labor</b>				<b>1,321.20</b>
			<b>Phase Total</b>	<b>\$1,321.20</b>

Phase 19004 CSAH 81  
 CSAH 81

**Professional Personnel**

	Hours	Rate	Amount	
Matthiesen, Edward	.50	198.00	99.00	
Nalven, Sarah	3.80	108.00	410.40	
Weis, Rena	9.30	108.00	1,004.40	
Totals	13.60		1,513.80	
<b>Total Labor</b>				<b>1,513.80</b>
			<b>Phase Total</b>	<b>\$1,513.80</b>

Phase 19005 Park Center High School  
 Park Center High School

**Professional Personnel**

	Hours	Rate	Amount	
Nalven, Sarah	.20	108.00	21.60	
Weis, Rena	1.20	108.00	129.60	
Totals	1.40		151.20	
<b>Total Labor</b>				<b>151.20</b>
			<b>Phase Total</b>	<b>\$151.20</b>

Phase 19006 Twin Lake North  
 Twin Lake North

**Professional Personnel**

		<b>Hours</b>	<b>Rate</b>	<b>Amount</b>	
Weis, Rena		4.20	108.00	453.60	
	Totals	4.20		453.60	
	<b>Total Labor</b>				<b>453.60</b>
			<b>Phase Total</b>		<b>\$453.60</b>
			<b>Total Invoice Amount</b>		<b>\$8,082.50</b>

	<b>Current</b>	<b>Prior</b>	<b>Total</b>
<b>Billing Summary</b>	<b>8,082.50</b>	<b>4,281.50</b>	<b>12,364.00</b>

**Invoice**

March 8, 2019

Invoice No: 11901264



Ms. Judie Anderson  
 Shingle Creek Watershed Management Comm.  
 3235 Fernbrook Lane  
 Plymouth, MN 55447

Responsive partner.  
 Exceptional outcomes.

Project Manager Eileen Weigel

Project B1240-0201 Shingle Creek HUC 8 Model Update

**Professional Services Through February 28, 2019**

Phase 01 Meetings

Meetings

**Professional Personnel**

	Hours	Rate	Amount	
Cruey, Bryce	1.50	198.00	297.00	
Weigel, Eileen	.40	145.00	58.00	
Totals	1.90		355.00	
<b>Total Labor</b>				<b>355.00</b>
		<b>Phase Total</b>		<b>\$355.00</b>

Phase 02 Data Organization

Data Organization

**Professional Personnel**

	Hours	Rate	Amount	
Weigel, Eileen	.30	145.00	43.50	
Totals	.30		43.50	
<b>Total Labor</b>				<b>43.50</b>
		<b>Phase Total</b>		<b>\$43.50</b>

Phase 03 Hydrologic Analysis

Hydrologic Analysis

**Professional Personnel**

	Hours	Rate	Amount	
Weigel, Eileen	11.00	145.00	1,595.00	
Weis, Rena	11.90	108.00	1,285.20	
Totals	22.90		2,880.20	
<b>Total Labor</b>				<b>2,880.20</b>
		<b>Phase Total</b>		<b>\$2,880.20</b>

**Total Invoice Amount \$3,278.70**

Billing Summary	Current	Prior	Total
	3,278.70	7,925.20	11,203.90

**Invoice**

March 8, 2019  
Invoice No: 11901309



Responsive partner.  
Exceptional outcomes.

Ms. Judie Anderson  
Shingle Creek Watershed Management Comm.  
3235 Fernbrook Lane  
Plymouth, MN 55447

Project Manager Thomas Langer

Project B1240-0210 2019 Stream Monitoring  
**Professional Services Through February 28, 2019**

**Professional Personnel**

	<b>Hours</b>	<b>Rate</b>	<b>Amount</b>	
Langer, Thomas	1.40	130.00	182.00	
Nalven, Sarah	1.80	108.00	194.40	
Wilkinson, Anne	7.30	120.00	876.00	
Totals	10.50		1,252.40	
<b>Total Labor</b>				<b>1,252.40</b>

**Unit Billing**

00-WAI Vehicle Golden Valley  
YSI - 6920 (Temp, DO, Cond, pH)

**70.30**

**Total Invoice Amount \$1,322.70**

	<b>Current</b>	<b>Prior</b>	<b>Total</b>
<b>Billing Summary</b>	<b>1,322.70</b>	<b>1,595.04</b>	<b>2,917.74</b>



**Invoice**

March 8, 2019  
Invoice No: 11901308



Ms. Judie Anderson  
Shingle Creek Watershed Management Comm.  
3235 Fernbrook Lane  
Plymouth, MN 55447

Responsive partner.  
Exceptional outcomes.

Project Manager Thomas Langer

Project B1240-0208 2019 Lake Monitoring

**Professional Services Through February 28, 2019**

**Professional Personnel**

	<b>Hours</b>	<b>Rate</b>	<b>Amount</b>	
Langer, Thomas	.30	130.00	39.00	
Strom, Jeffrey	.30	145.00	43.50	
Totals	.60		82.50	
<b>Total Labor</b>				<b>82.50</b>
				<b>Total Invoice Amount</b>
				<b>\$82.50</b>

	<b>Current</b>	<b>Prior</b>	<b>Total</b>
<b>Billing Summary</b>	<b>82.50</b>	<b>581.90</b>	<b>664.40</b>

**Invoice**

March 8, 2019  
Invoice No: 11901364



Ms. Judie Anderson  
Shingle Creek Watershed Management Comm.  
3235 Fernbrook Lane  
Plymouth, MN 55447

Responsive partner.  
Exceptional outcomes.

Project Manager Diane Spector

Project B1240-0211 2019 TMDL 5 Year Reviews  
**Professional Services Through February 28, 2019**

**Professional Personnel**

	<b>Hours</b>	<b>Rate</b>	<b>Amount</b>	
Kaczmarek, Hagen	.50	120.00	60.00	
Nalven, Sarah	.10	108.00	10.80	
Spector, Diane	.50	188.00	94.00	
Stone, Alicia	9.50	63.00	598.50	
Strom, Jeffrey	7.40	145.00	1,073.00	
Totals	18.00		1,836.30	
<b>Total Labor</b>				<b>1,836.30</b>
		<b>Total Invoice Amount</b>		<b>\$1,836.30</b>

<b>Billing Summary</b>	<b>Current</b>	<b>Prior</b>	<b>Total</b>
	<b>1,836.30</b>	<b>77.40</b>	<b>1,913.70</b>

**Invoice**

March 8, 2019  
Invoice No: 11901363



Ms. Judie Anderson  
Shingle Creek Watershed Management Comm.  
3235 Fernbrook Lane  
Plymouth, MN 55447

Responsive partner.  
Exceptional outcomes.

Project Manager Diane Spector

Project B1240-0203 2019 Education and Outreach

**Professional Services Through February 28, 2019**

Phase 01 General Education

General Education

**Professional Personnel**

	Hours	Rate	Amount	
Spector, Diane	8.00	188.00	1,504.00	
Totals	8.00		1,504.00	
<b>Total Labor</b>				<b>1,504.00</b>
				<b>Phase Total</b>
				<b>\$1,504.00</b>
				<b>Total Invoice Amount</b>
				<b>\$1,504.00</b>

	Current	Prior	Total
<b>Billing Summary</b>	<b>1,504.00</b>	<b>1,955.80</b>	<b>3,459.80</b>

SC 752.00

WM 752.00

**Invoice**

March 8, 2019  
Invoice No: 11901280



Ms. Judie Anderson  
Shingle Creek Watershed Management Comm.  
3235 Fernbrook Lane  
Plymouth, MN 55447

Responsive partner.  
Exceptional outcomes.

Project Manager Jeffrey Strom

Project B1240-0205 2019 Annual WQ Report  
**Professional Services Through February 28, 2019**

**Professional Personnel**

	<b>Hours</b>	<b>Rate</b>	<b>Amount</b>	
Langer, Thomas	27.90	130.00	3,627.00	
Nalven, Sarah	11.50	108.00	1,242.00	
Stone, Alicia	2.00	63.00	126.00	
Strom, Jeffrey	4.60	145.00	667.00	
Weis, Rena	24.50	108.00	2,646.00	
Wilkinson, Anne	28.20	120.00	3,384.00	
Totals	98.70		11,692.00	
<b>Total Labor</b>				<b>11,692.00</b>
		<b>Total Invoice Amount</b>		<b>\$11,692.00</b>

<b>Billing Summary</b>	<b>Current</b>	<b>Prior</b>	<b>Total</b>
	<b>11,692.00</b>	<b>5,190.30</b>	<b>16,882.30</b>

SC 8,184.40  
WM 3,507.60

**Invoice**

March 8, 2019  
Invoice No: 11901362



Ms. Judie Anderson  
Shingle Creek Watershed Management Comm.  
3235 Fernbrook Lane  
Plymouth, MN 55447

Responsive partner.  
Exceptional outcomes.

Project Manager Diane Spector

Project B1240-0187 Minneapolis Subwatershed Assessment

**Professional Services Through February 28, 2019**

Phase 01 Modeling and Report

Modeling and Report

**Professional Personnel**

	<b>Hours</b>	<b>Rate</b>	<b>Amount</b>	
Zhang, Lu	15.20	117.00	1,778.40	
Totals	15.20		1,778.40	
<b>Total Labor</b>				<b>1,778.40</b>
		<b>Phase Total</b>		<b>\$1,778.40</b>
		<b>Total Invoice Amount</b>		<b>\$1,778.40</b>

	<b>Current</b>	<b>Prior</b>	<b>Total</b>
<b>Billing Summary</b>	<b>1,778.40</b>	<b>29,614.40</b>	<b>31,392.80</b>

**Invoice**

March 8, 2019  
 Invoice No: 11901360



Ms. Judie Anderson  
 Shingle Creek Watershed Management Comm.  
 3235 Fernbrook Lane  
 Plymouth, MN 55447

Responsive partner.  
 Exceptional outcomes.

Project Manager Diane Spector

Project B1240-0163 Biochar/Iron Sand Filters

**Professional Services Through February 28, 2019**

Phase 02A Monitoring

Monitoring

**Professional Personnel**

	Hours	Rate	Amount	
Nalven, Sarah	2.70	80.00	216.00	
Spector, Diane	2.80	127.00	355.60	
Totals	5.50		571.60	
<b>Total Labor</b>				<b>571.60</b>

**Reimbursable Expenses**

Tools & Equipment			30.00	
<b>Total Reimbursables</b>			<b>30.00</b>	<b>30.00</b>

**Phase Total \$601.60**

Phase 03 Reporting & Info Sharing

Reporting & Info Sharing

**Professional Personnel**

	Hours	Rate	Amount	
Zhang, Lu	4.10	80.00	328.00	
Totals	4.10		328.00	
<b>Total Labor</b>				<b>328.00</b>

**Phase Total \$328.00**

Phase 04 Semi-annual Reports

Semi-annual Reports

**Professional Personnel**

	Hours	Rate	Amount	
Spector, Diane	.50	127.00	63.50	
Totals	.50		63.50	
<b>Total Labor</b>				<b>63.50</b>

**Phase Total \$63.50**

**Total Invoice Amount \$993.10**

**Invoice**



March 8, 2019  
Invoice No: 11901365

Ms. Judie Anderson  
Shingle Creek Watershed Management Comm.  
3235 Fernbrook Lane  
Plymouth, MN 55447

Responsive partner.  
Exceptional outcomes.

Project Manager Diane Spector

Project B1240-0162 Twin Lake Carp Management

**Professional Services Through February 28, 2019**

Phase 01B Carp Tracking

Carp Tracking

**Professional Personnel**

	Hours	Rate	Amount	
Langer, Thomas	8.10	80.00	648.00	
Weigel, Eileen	.30	90.00	27.00	
Totals	8.40		675.00	
<b>Total Labor</b>				<b>675.00</b>

**Reimbursable Expenses**

Mileage - Reimbursable			5.80	
Tools & Equipment			301.07	
<b>Total Reimbursables</b>			<b>306.87</b>	<b>306.87</b>

**Phase Total \$981.87**

Phase 02A Aeration System

Aeration System

**Professional Personnel**

	Hours	Rate	Amount	
Langer, Thomas	.30	80.00	24.00	
Totals	.30		24.00	
<b>Total Labor</b>				<b>24.00</b>

**Phase Total \$24.00**

Phase 02B Fish Barriers

Fish Barriers

**Unit Billing**

2014 Ford F150 XL Supercab 9.86

**Phase Total \$9.86**

Phase 03 Carp Removal

Carp Removal

**Professional Personnel**

	Hours	Rate	Amount	
Langer, Thomas	2.00	80.00	160.00	
Nalven, Sarah	.30	80.00	24.00	
Totals	2.30		184.00	
<b>Total Labor</b>				<b>184.00</b>

**Reimbursable Expenses**

Mileage - Reimbursable			11.60	
<b>Total Reimbursables</b>			<b>11.60</b>	<b>11.60</b>

**Phase Total \$195.60**

Phase 04B Aquatic Vegetation Survey & Mgmt Plan  
 Aquatic Vegetation Survey & Mgmt Plan

**Professional Personnel**

	Hours	Rate	Amount	
Wilkinson, Anne	7.50		0.00	
Totals	7.50		0.00	
<b>Total Labor</b>				<b>0.00</b>

**Phase Total 0.00**

Phase 05 Community Engagement  
 Community Engagement

**Professional Personnel**

	Hours	Rate	Amount	
Spector, Diane	.80	127.00	101.60	
Totals	.80		101.60	
<b>Total Labor</b>				<b>101.60</b>

**Phase Total \$101.60**

Phase 06 Semi-annual Reports  
 Semi-annual Reports

**Professional Personnel**

	Hours	Rate	Amount	
Spector, Diane	.50	127.00	63.50	
Totals	.50		63.50	
<b>Total Labor</b>				<b>63.50</b>

**Phase Total \$63.50**

**Total Invoice Amount \$1,376.43**



**Invoice**

March 8, 2019  
Invoice No: 11901367



Ms. Judie Anderson  
Shingle Creek Watershed Management Comm.  
3235 Fernbrook Lane  
Plymouth, MN 55447

Responsive partner.  
Exceptional outcomes.

Project Manager Diane Spector

Project B1240-0212 Shingle Creek SRP Reduction Project

**Professional Services Through February 28, 2019**

Phase 06 Semiannual/Annual Reports

Semiannual/Annual Reports

**Professional Personnel**

	Hours	Rate	Amount	
Project Manager				
Spector, Diane	.50	137.52	68.76	
Totals	.50		68.76	
<b>Total Labor</b>				<b>68.76</b>
				<b>Phase Total</b>
				<b>\$68.76</b>
				<b>Total Invoice Amount</b>
				<b>\$68.76</b>

	Current	Prior	Total
<b>Billing Summary</b>	<b>68.76</b>	<b>0.00</b>	<b>68.76</b>



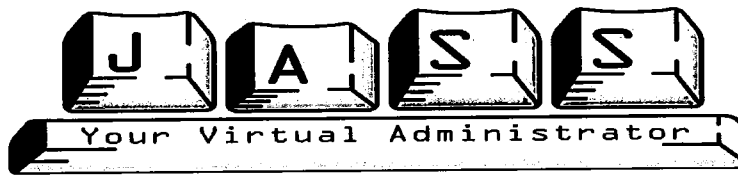

3235 Fernbrook Lane  
Plymouth MN 55447

Shingle Creek / West Mississippi Watershed Management Commissions  
3235 Fernbrook Lane  
Plymouth, MN 55447

March 11, 2019

	Share	G/L	Shingle Creek			West Mississippi			Total Project Area	
			SC	WM		SC	WM	SC	WM	
Administrative		53001	55.00	-	0.50	55.00	27.50			
Administrative	70-30	53001	1.25	55.00	48.13	55.00	20.63			
Administrative		53001	9.25	60.00	555.00	2.17	60.00	130.20		
Administrative	70-30	53001	44.84	60.00	1,883.28	60.00	807.12			
Admin - Offsite	70-30	53001	4.50	70.00	220.50	70.00	94.50			
Office Support	70-30	53001	7.00	200.00	980.00	200.00	420.00			
Data Processing/File Mgmt		53001		55.00	-	55.00	-			
Admin Reimbursables			808.63	1.00	808.63	343.05	1.00	343.05	4,495.535	1,842.995
Bookkeeping	80-20	54022	0.75	55.00	33.00	55.00	8.25			
Bookkeeping	80-20	54022	0.42	60.00	20.16	60.00	5.04			
Bookkeeping		54022	8.41	60.00	504.60	3.41	60.00	204.60		
Audit Prep		54022		55.00	-	55.00	-			
Audit Prep		54022	0.50	60.00	30.00	0.50	60.00	30.00	587.760	247.890
Project / WCA Reviews - Secre		53002		55.00	-	55.00	-			
Project / WCA Reviews - Admin		53002	1.40	60.00	84.00	0.57	60.00	34.20		
Project Reviews - File Mgmt		53002		55.00	-	55.00	-			
Reimbursable Expenses		53002	139.86	1.00	139.86	3.72	1.00	3.72	223.860	37.920
Education - Admin	50-50	57008	1.50	60.00	45.00	60.00	45.00			
Education - Admin - Offsite	50-50	57008		70.00	-	70.00	-			
Education - NPDES	50-50	57008	7.55	60.00	226.50	60.00	226.50			
Website	50-50	57008		60.00	-	60.00	-			
Renew website domain	50-50	57008		1.00	-	50.00	1.00	50.00		
Education Reimbursables	50-50	57008	34.18	1.00	34.18	34.18	1.00	34.18	305.680	355.680
Engineering Support - Admin		53004	2.25	60.00	135.00	60.00	-			
Engineering Support - Offsite		53004		70.00	-	70.00	-			
Engineering Support - Secre	70-30	53004		55.00	-	50.00	-			
Engineering Support - Admin	70-30	53004	10.17	60.00	427.14	60.00	183.06			
Engineering Support - Offsite	70-30	53004		70.00	-	70.00	-			
Engineering Support Reimbursables		53004	249.56	1.00	249.56	106.95	1.00	106.95	811.700	290.010
									6,424.535	2,774.495

**West Mississippi Watershed Management Commission**  
**2019 Treasurer's Report**

	2019 Budget	February	March	%age YTD	2019 YTD
<b>REVENUE</b>					
Application Fees	20,000			11.00	2,200.00
Assessments	153,600	153,600.00		100.00	153,600.00
Interest & Dividend Income	2,000	934.95		90.53	1,810.65
Reserve - Flood Mapping	25,000			0.00	-
Miscellaneous Income					-
<i>Transfer to (from) CIPs (see CIP Tracker page)</i>					-
<i>To (From) Reserve</i>					-
<b>TOTAL REVENUE</b>	<b>200,600</b>	<b>154,534.95</b>	<b>-</b>		<b>157,610.65</b>
<b>EXPENSES</b>					
		<b>2018 Activity</b>			
<b>ADMINISTRATION</b>					
Administrative Services	31,000	2,263.49	1,843.00	13.25	4,106.49
Engineering Support	4,500	338.47	290.01	13.97	628.48
Project Reviews	1,500	48.66	37.92	5.77	86.58
<b>ENGINEERING</b>					
Administration	30,000	2,638.80	1,793.00	14.77	4,431.80
Grant Application Writing	1,500			0.00	-
Project Review	27,000	2,044.40	1,129.60	11.76	3,174.00
<b>LEGAL</b>					
Legal Services	5,000	522.85	347.50	6.95	347.50
<b>MISCELLANEOUS</b>					
Bookkeeping	2,800	320.40	247.89	20.30	568.29
Audit	5,000			0.00	-
Insurance & Bonding	2,800			0.00	-
Meeting Expense	2,500	149.18		12.54	313.54
<b>PROJECTS</b>					
Macroinvertebrate Monitoring	1,000			0.00	-
Volunteer Wetland Monitoring (WHEP)	2,000			0.00	-
Outfall and Stream Monitoring	18,000	549.60	788.10	7.43	1,337.70
Annual Water Quality Report	6,000	1,557.09	3,507.60	84.41	5,064.69
<b>Water Quality Education</b>					
Education	15,000	1,336.08	1,107.68	19.63	2,943.76
Rain Garden Workshops	2,000		1,000.00	50.00	1,000.00
Education Grants	500			0.00	-
WMWA General Programs	5,000	3,000.00		60.00	3,000.00
WMWA Educators/Watershed Prep	4,500	2,000.00		44.44	2,000.00
WMWA Special Projects	2,000			0.00	-
Third Gen Plan/amendments	1,000			0.00	-
Contribution to Construction/Grant Match	5,000			0.00	-
Flood modeling and mapping	25,000			0.00	-
<i>Transfer to (from)CIPs</i>					-
<i>To (from) Reserves</i>					-
<b>TOTAL OPERATING EXPENSE</b>	<b>200,600</b>	<b>16,769.02</b>	<b>12,092.30</b>		<b>29,002.83</b>
<b>CASH SUMMARY</b>					
<b>4M Fund Balance at 12/31/18</b>					<b>479,512.33</b>
<b>Plus Revenue Received to Date</b>					<b>158,154.94</b>
<b>Minus Claims Approved to Date</b>					<b>(33,133.85)</b>
<b>Minus Claims Presented Current Month</b>					<b>(12,092.30)</b>
<b>Fund Balance</b>		<b>604,533.42</b>			<b>592,441.12</b>

**West Mississippi Watershed Management Commission  
2019 Treasurer's Report**

<b>Claims Presented March 14, 2019</b>	General Ledger Acct No	February	March		
					<b>Total</b>
Kennedy & Graven					<b>347.50</b>
Legal - General	52001		347.50		
Shingle Creek - Rain Garden Workshops	57002		1,000.00		<b>1,000.00</b>
Wenck Associates					<b>7,970.30</b>
General Engineering	51001		1,793.00		
Project Reviews	51002		1,129.60		
Project Management Plan	51003				
Grant Applica/Research	51005				
Plan Amendment	51007				
Education Program	57008		752.00		
Intensive BMPs	57011				
Annual Water Quality Report	58002		3,507.60		
Water Monitoring Program	58011		788.10		
Judie Anderson's Secretarial Service					<b>2,774.50</b>
Administration	53001		1,843.00		
Bookkeeping	54002		247.89		
Project and WCA Review Support	53002		37.92		
Education Programs	57008		355.68		
Engineering Support	53004		290.01		
Engineering Support - CIPs	53004				
Engineering Support - Plan Amendment	53007				
<b>Total Claims</b>					<b>12,092.30</b>
					
<b>Judie A Anderson, Deputy Treasurer</b>					

**Kennedy & Graven, Chartered**

200 South Sixth Street, Suite 470  
Minneapolis, MN 55402

West Mississippi Watershed

January 31, 2019

WE405-00001 General

Through January 31, 2019

For All Legal Services As Follows:

			Hours	Amount
1/10/2019	TJG	Prepare for, travel to, and participate in meeting	1.70	341.70
<b>Total Services:</b>			<b>\$</b>	<b>341.70</b>

For All Disbursements As Follows:

1/10/2019	Troy Gilchrist; Mileage expense			5.80
<b>Total Disbursements:</b>			<b>\$</b>	<b>5.80</b>

**Total Services and Disbursements: \$ 347.50**

# Kennedy & Graven, Chartered

200 South Sixth Street, Suite 470  
Minneapolis, MN 55402

(612) 337-9300

41-1225694

February 28, 2019

Statement No. 147420

West Mississippi Watershed Management Commission

JASS - Watershed Administrators  
3235 Fernbrook Lane  
Plymouth, MN 55447

Through January 31, 2019

WE405-00001    General

347.50

**Total Current Billing:** 347.50

I declare, under penalty of law, that this  
account, claim or demand is just and correct  
and that no part of it has been paid.

  
\_\_\_\_\_  
Signature of Claimant

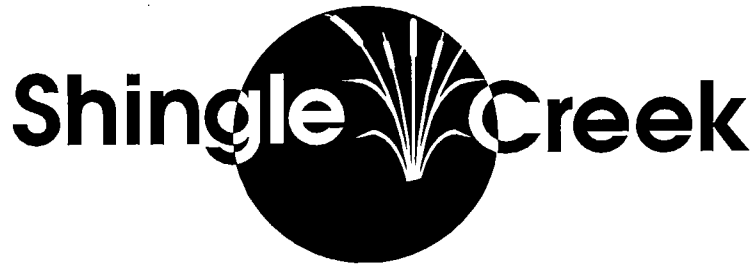

3235 Fernbrook Lane Plymouth, MN 55447

Bassett Creek Watershed Management Commission  
 City of Crystal  
 City of Champlin  
 Elm Creek Watershed Management Commission  
 City of Plymouth  
 Shingle Creek Watershed Management Commission  
 West Mississippi Watershed Management Commission  
 City of Brooklyn Park

6-Mar-19

2019 Invoice - Metro Blooms Raingarden Workshops

	2019 Budget		2019 Actual	
	Workshops	Partner Share	Workshops	Partner Share
<b>Joint watershed sponsorship Metro Blooms Rain Garden Workshops</b>				
<b>Combined Workshops</b>				
Metro Blooms	10,500.00			
Administration and Promotion	1,250.00			
Watershed Credit - Blue Thumb Partnership	(1,500.00)			
Bassett Creek Commission		2,000.00		2,000.00
Elm Creek Commission		2,000.00		2,000.00
Shingle Creek Commission		2,000.00		2,000.00
West Mississippi Commission		2,000.00		2,000.00
<b>2019 Workshops</b>				
City of Crystal - May 9 - in partnership w/Golden Valley, New Hope, Robbinsdale		750.00		750.00
City of Champlin - April 4		750.00		750.00
City of Plymouth - May 2		750.00		750.00
	10,250.00	10,250.00	-	10,250.00
<b>First Half Due Now</b>				1,000.00

Please make your check payable to the Shingle Creek Watershed Management Commission.

Thank you.



**Invoice**

March 8, 2019  
Invoice No: 11901306



Responsive partner.  
Exceptional outcomes.

Ms. Judie Anderson  
West Mississippi Watershed Mgmt. Comm.  
3235 Fernbrook Lane  
Plymouth, MN 55447

Project Manager Edward Matthiesen

Project B1241-0073 2019 General Engineering  
**Professional Services Through February 28, 2019**

**Professional Personnel**

	<b>Hours</b>	<b>Rate</b>	<b>Amount</b>	
Matthiesen, Edward	.70	198.00	138.60	
Spector, Diane	8.80	188.00	1,654.40	
Totals	9.50		1,793.00	
<b>Total Labor</b>				<b>1,793.00</b>
				<b>Total Invoice Amount</b>
				<b>\$1,793.00</b>

	<b>Current</b>	<b>Prior</b>	<b>Total</b>
<b>Billing Summary</b>	<b>1,793.00</b>	<b>2,638.80</b>	<b>4,431.80</b>

**Invoice**

March 8, 2019  
 Invoice No: 11901307



Ms. Judie Anderson  
 West Mississippi Watershed Mgmt. Comm.  
 3235 Fernbrook Lane  
 Plymouth, MN 55447

Responsive partner.  
 Exceptional outcomes.

Project Manager Edward Matthiesen

Project B1241-0076 2019 Project Reviews

**Professional Services Through February 28, 2019**

Phase 01 2019 General Project Reviews

2019 General Project Reviews

**Professional Personnel**

	<b>Hours</b>	<b>Rate</b>	<b>Amount</b>	
Matthiesen, Edward	3.30	198.00	653.40	
Nalven, Sarah	.30	108.00	32.40	
Spector, Diane	.50	188.00	94.00	
Totals	4.10		779.80	
<b>Total Labor</b>				<b>779.80</b>
				<b>Phase Total \$779.80</b>

Phase 02 2019 WCA Administration

2019 WCA Administration

**Professional Personnel**

	<b>Hours</b>	<b>Rate</b>	<b>Amount</b>	
Dietrich, Meaghan	.50	120.00	60.00	
Totals	.50		60.00	
<b>Total Labor</b>				<b>60.00</b>
				<b>Phase Total \$60.00</b>

Phase 19001 Oak Village

Oak Village

**Professional Personnel**

	<b>Hours</b>	<b>Rate</b>	<b>Amount</b>	
Matthiesen, Edward	.10	198.00	19.80	
Nalven, Sarah	.90	108.00	97.20	
Totals	1.00		117.00	
<b>Total Labor</b>				<b>117.00</b>
				<b>Phase Total \$117.00</b>

Phase 19002 Emery Village Reserve 3rd Addition

Emery Village Reserve 3rd Addition

**Professional Personnel**

	<b>Hours</b>	<b>Rate</b>	<b>Amount</b>	
Nalven, Sarah	.60	108.00	64.80	

INVOICES ARE DUE UPON PRESENTATION. Subject to 1-1/2% 18% Annum interest/finance charge. Please reference the invoice number when sending payment. Federal Tax ID #41-1520095 -Wenck Associates, Inc.-1800 Pioneer Creek Center PO Box 249- Maple Plain, MN 55359-0249 Toll Free:800-472-2232 Main:763-479-4200 E-mail:accounting@wenck.com Web www.wenck.com

Project	B1241-0076	2019 Project Reviews	Invoice	11901307
Weis, Rena		1.00	108.00	108.00
	Totals	1.60		172.80
	<b>Total Labor</b>			<b>172.80</b>
			<b>Phase Total</b>	<b>\$172.80</b>
			<b>Total Invoice Amount</b>	<b>\$1,129.60</b>

	Current	Prior	Total
<b>Billing Summary</b>	<b>1,129.60</b>	<b>2,044.40</b>	<b>3,174.00</b>

**Invoice**

March 8, 2019  
Invoice No: 11901310



Ms. Judie Anderson  
West Mississippi Watershed Mgmt. Comm.  
3235 Fernbrook Lane  
Plymouth, MN 55447

Responsive partner.  
Exceptional outcomes.

Project Manager Thomas Langer

Project B1241-0077 2019 Stream and Outlet Monitoring

**Professional Services Through February 28, 2019**

**Professional Personnel**

	<b>Hours</b>	<b>Rate</b>	<b>Amount</b>	
Langer, Thomas	.80	130.00	104.00	
Nalven, Sarah	6.20	108.00	669.60	
Strom, Jeffrey	.10	145.00	14.50	
Totals	7.10		788.10	
<b>Total Labor</b>				<b>788.10</b>
		<b>Total Invoice Amount</b>		<b>\$788.10</b>

<b>Billing Summary</b>	<b>Current</b>	<b>Prior</b>	<b>Total</b>
	<b>788.10</b>	<b>549.60</b>	<b>1,337.70</b>

**Invoice**

March 8, 2019  
Invoice No: 11901280



Ms. Judie Anderson  
Shingle Creek Watershed Management Comm.  
3235 Fernbrook Lane  
Plymouth, MN 55447

Responsive partner.  
Exceptional outcomes.

Project Manager Jeffrey Strom

Project B1240-0205 2019 Annual WQ Report

**Professional Services Through February 28, 2019**

**Professional Personnel**

	<b>Hours</b>	<b>Rate</b>	<b>Amount</b>	
Langer, Thomas	27.90	130.00	3,627.00	
Nalven, Sarah	11.50	108.00	1,242.00	
Stone, Alicia	2.00	63.00	126.00	
Strom, Jeffrey	4.60	145.00	667.00	
Wels, Rena	24.50	108.00	2,646.00	
Wilkinson, Anne	28.20	120.00	3,384.00	
Totals	98.70		11,692.00	
<b>Total Labor</b>				<b>11,692.00</b>

**Total Invoice Amount \$11,692.00**

	<b>Current</b>	<b>Prior</b>	<b>Total</b>
<b>Billing Summary</b>	<b>11,692.00</b>	<b>5,190.30</b>	<b>16,882.30</b>

SC 8,184.40  
WM 3,507.60

**Invoice**

March 8, 2019  
Invoice No: 11901363



Ms. Judie Anderson  
Shingle Creek Watershed Management Comm.  
3235 Fernbrook Lane  
Plymouth, MN 55447

Responsive partner.  
Exceptional outcomes.

Project Manager Diane Spector

Project B1240-0203 2019 Education and Outreach  
**Professional Services Through February 28, 2019**

Phase 01 General Education  
General Education

**Professional Personnel**

	<b>Hours</b>	<b>Rate</b>	<b>Amount</b>	
Spector, Diane	8.00	188.00	1,504.00	
Totals	8.00		1,504.00	
<b>Total Labor</b>				<b>1,504.00</b>
		<b>Phase Total</b>		<b>\$1,504.00</b>
		<b>Total Invoice Amount</b>		<b>\$1,504.00</b>

<b>Billing Summary</b>	<b>Current</b>	<b>Prior</b>	<b>Total</b>
	<b>1,504.00</b>	<b>1,955.80</b>	<b>3,459.80</b>

SC 752.00

WM 752.00

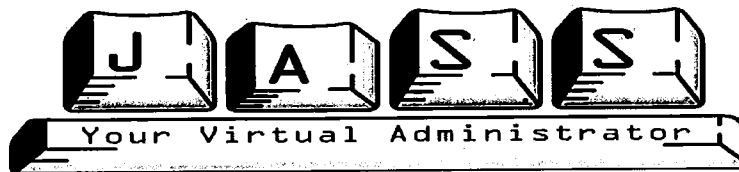

3235 Fernbrook Lane  
Plymouth MN 55447

Shingle Creek / West Mississippi Watershed Management Commissions  
3235 Fernbrook Lane  
Plymouth, MN 55447

March 11, 2019

	Share	G/L	Shingle Creek			West Mississippi			Total Project Area	
									SC	WM
Administrative		53001	55.00	-	0.50	55.00	27.50			
Administrative	70-30	53001	1.25	55.00	48.13	55.00	20.63			
Administrative		53001	9.25	60.00	555.00	2.17	60.00	130.20		
Administrative	70-30	53001	44.84	60.00	1,883.28	60.00	807.12			
Admin - Offsite	70-30	53001	4.50	70.00	220.50	70.00	94.50			
Office Support	70-30	53001	7.00	200.00	980.00	200.00	420.00			
Data Processing/File Mgmt		53001		55.00	-	55.00	-			
Admin Reimbursables			808.63	1.00	808.63	343.05	1.00	343.05	4,495.535	1,842.995
Bookkeeping	80-20	54022	0.75	55.00	33.00	55.00	8.25			
Bookkeeping	80-20	54022	0.42	60.00	20.16	60.00	5.04			
Bookkeeping		54022	8.41	60.00	504.60	3.41	60.00	204.60		
Audit Prep		54022		55.00	-	55.00	-			
Audit Prep		54022	0.50	60.00	30.00	0.50	60.00	30.00	587.760	247.890
Project / WCA Reviews - Secre		53002		55.00	-	55.00	-			
Project / WCA Reviews - Admin		53002	1.40	60.00	84.00	0.57	60.00	34.20		
Project Reviews - File Mgmt		53002		55.00	-	55.00	-			
Reimbursable Expenses		53002	139.86	1.00	139.86	3.72	1.00	3.72	223.860	37.920
Education - Admin	50-50	57008	1.50	60.00	45.00	60.00	45.00			
Education - Admin - Offsite	50-50	57008		70.00	-	70.00	-			
Education - NPDES	50-50	57008	7.55	60.00	226.50	60.00	226.50			
Website	50-50	57008		60.00	-	60.00	-			
Renew website domain	50-50	57008		1.00	-	50.00	1.00	50.00		
Education Reimbursables	50-50	57008	34.18	1.00	34.18	34.18	1.00	34.18	305.680	355.680
Engineering Support - Admin		53004	2.25	60.00	135.00	60.00	-			
Engineering Support - Offsite		53004		70.00	-	70.00	-			
Engineering Support - Secre	70-30	53004		55.00	-	50.00	-			
Engineering Support - Admin	70-30	53004	10.17	60.00	427.14	60.00	183.06			
Engineering Support - Offsite	70-30	53004		70.00	-	70.00	-			
Engineering Support Reimbursables		53004	249.56	1.00	249.56	106.95	1.00	106.95	811.700	290.010
									6,424.535	2,774.495

## SHINGLE CREEK WATERSHED MANAGEMENT COMMISSION

### **PROJECT REVIEW SC2019-003: Windsor Ridge**

**Owner:** Mike Kevitt  
SVK Development, LLC  
3335 Pennsylvania Avenue N  
Crystal, MN 55427

**Engineer:** Todd McLouth, PE  
**Company:** Loucks  
**Address:** 7200 Hemlock Lane #300  
Maple Grove, MN 55369

**Phone:** 763-496-6742  
**Fax:** 763-424-5822  
**Email:** tmclouth@loucksinc.com

**Purpose:** Construction of 32 single-family residential homes on 8.7 acres.

**Location:** 51<sup>st</sup> Avenue & Pennsylvania Avenue North, New Hope, MN (Figure 1).

- Exhibits:**
1. Project review application dated 2/14/19 and project review fee of \$2,200, dated 2/4/19, received 2/14/19.
  2. Site plan, preliminary plat, grading, utility, erosion control, and landscaping plans dated 2/8/19, received 2/14/19.
  3. Hydrologic calculations by Loucks, dated 2/6/19, received 2/14/19.

- Findings:**
1. The proposed project is the construction of 32 single-family residential homes on 8.7 acres. Following development, the site will be 36.6 percent impervious with 3.2 acres of impervious surface, an increase of 3.2 acres.
  2. The complete project application was received on 2/14/19. To comply with the 60-day review requirement, the Commission must approve or deny this project no later than the 4/11/19 meeting. Sixty calendar-days expires on 4/15/19.
  2. To comply with the Commission's water quality treatment requirement, the site must provide ponding designed to NURP standards with dead storage volume equal to or greater than the volume of runoff from a 2.5" storm event, or BMPs providing a similar level of treatment - 85% TSS removal and 60% TP removal. Infiltrating 1.3-inches of runoff, for example, is considered sufficient to provide a similar level of treatment. If a sump is used the MnDOT Road Sand particle size distribution is acceptable for 80% capture.

Runoff from the majority of the site (drainage area 1P, 7.1 acres) is proposed to be routed to a NURP pond connected to an infiltration basin (P1 and P1i, respectively; Figure 2). According to the MIDS calculator, this treatment pond removes 91% TSS and 87% TP. Stormwater entering this pond is pretreated with a 6 ft. diameter/6 ft. depth sump, which removes 85% TSS according to SHSAM. The applicant meets Commission water quality treatment requirements.



## SC2019-003: Windsor Ridge

- Commission rules require that site runoff is limited to predevelopment rates for the 2-, 10-, and 100-year storm events. Runoff from the majority of the site (drainage area 1P, 7.1 acres) is proposed to be routed to a NURP pond connected to an infiltration basin (P1 and P1i, respectively). The applicant meets Commission rate control requirements (Table 1).

**Table 1. Runoff from site (cfs).**

Drainage Area	2-year event		10-year event		100-year event	
	Pre-	Post-	Pre-	Post-	Pre-	Post-
Entire site	1.2	0.3	6.0	4.7	21.6	15.9

- Commission rules require the site to infiltrate 1.0 inch of runoff from new impervious area within 48 hours. The new impervious area on this site is 3.2 acres, requiring infiltration of 11,580 cubic feet within 48 hours. Runoff from the majority of the site (drainage area 1P, 7.1 acres) will be routed to a NURP pond connected to an infiltration basin (P1 and P1i, respectively; Figure 2). In addition, a small portion of the site (drainage area 2P, 1.05 acres) will be routed to a second infiltration basin (P2; Figure 2). Together these infiltration basins have the capacity to infiltrate the required volume within 48 hours. In fact, soils have measured infiltration rates of 31 inches per hour, which is higher than 8.3 inches per hour, the highest infiltration rate the Minnesota Stormwater Manual allows (for water quality purposes). The applicant proposes to amend in-place sandy soils with 1 ft. of topsoil to slow infiltration rates to 8.3 inches per hour. The applicant will test infiltration post-construction to confirm desired infiltration rates. The applicant meets Commission volume control requirements.
- The National Wetlands Inventory does not identify any wetlands on site. The applicant meets Commission wetland requirements.
- There are no Public Waters on this site. The applicant meets Commission Public Waters requirements.
- There is no FEMA-regulated floodplain on this site. The lowest opening elevations of houses are at least two feet higher than the high water elevation of the ponds according to Atlas 14 precipitation. The applicant meets Commission floodplain requirements.
- An erosion control plan was submitted with the project review, and includes rock construction entrances, perimeter silt fence, silt fence surrounding basins, inlet protection, rip rap at inlets, and native seed specified on the pond slopes. The erosion control plan meets Commission requirements.
- A public hearing on the project was conducted on 3/5/19 as part of Planning Commission and City Council review of this project, meeting Commission public notice requirements.
- The City plans to own Outlot A and maintain the pond within Outlot A (P1 and P1i). Therefore, an O&M agreement is not necessary.

**SC2019-003: Windsor Ridge**

11. A Project Review Fee of \$2,200 has been received.

**Recommendation:** Recommend approval subject to the following conditions:

1. Demonstrate by double ring infiltrometer or witness test that the site meets the design infiltration rate of 8.3 inches/hour.
2. Provide evidence that work within the railroad right of way is allowed.

Wenck Associates, Inc.  
Engineers for the Commission

---

Ed Matthiesen, P.E.

Date

SC2019-003: Windsor Ridge

Figure 1. Site location.

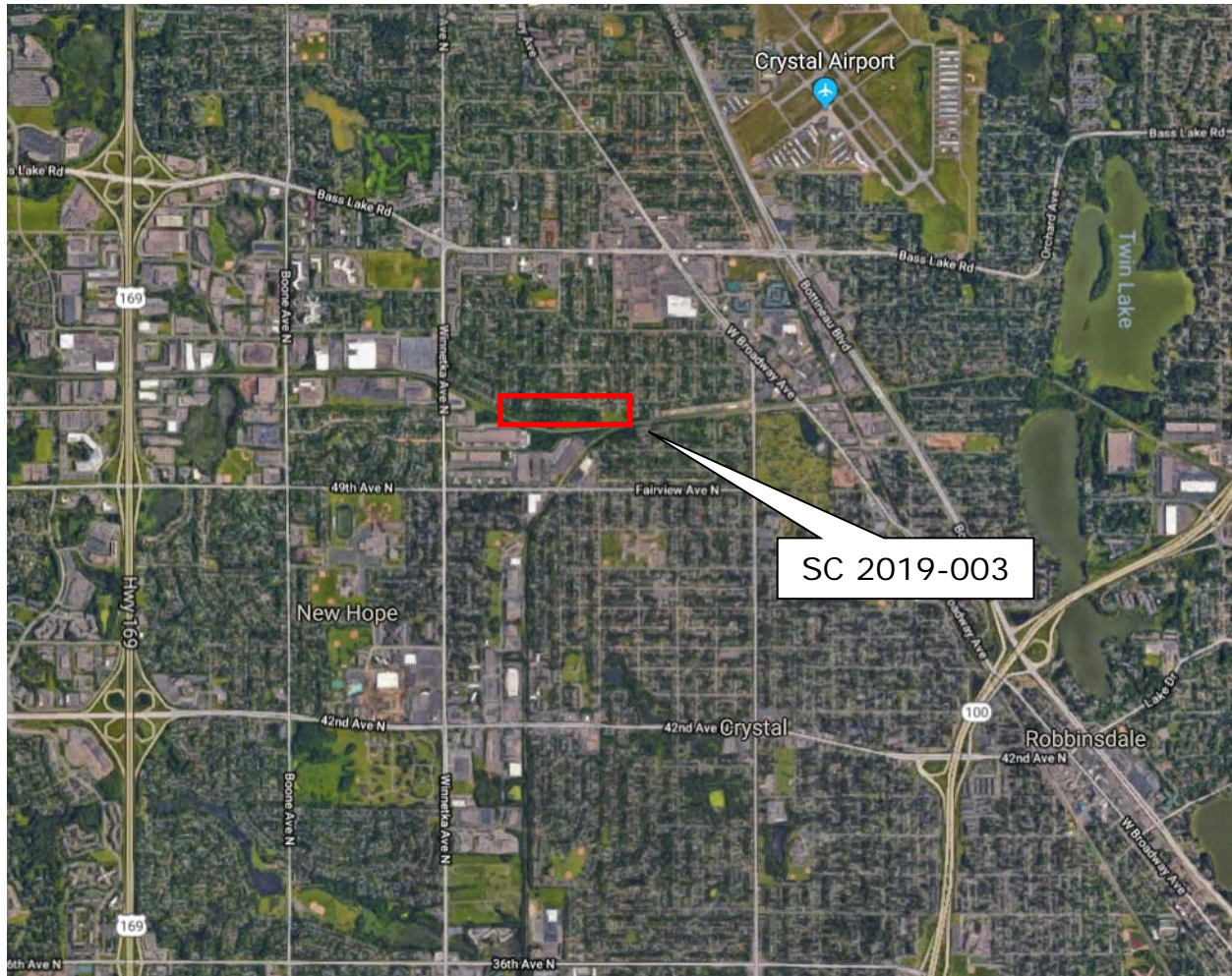

SC2019-003: Windsor Ridge

Figure 2. Site grading plan.

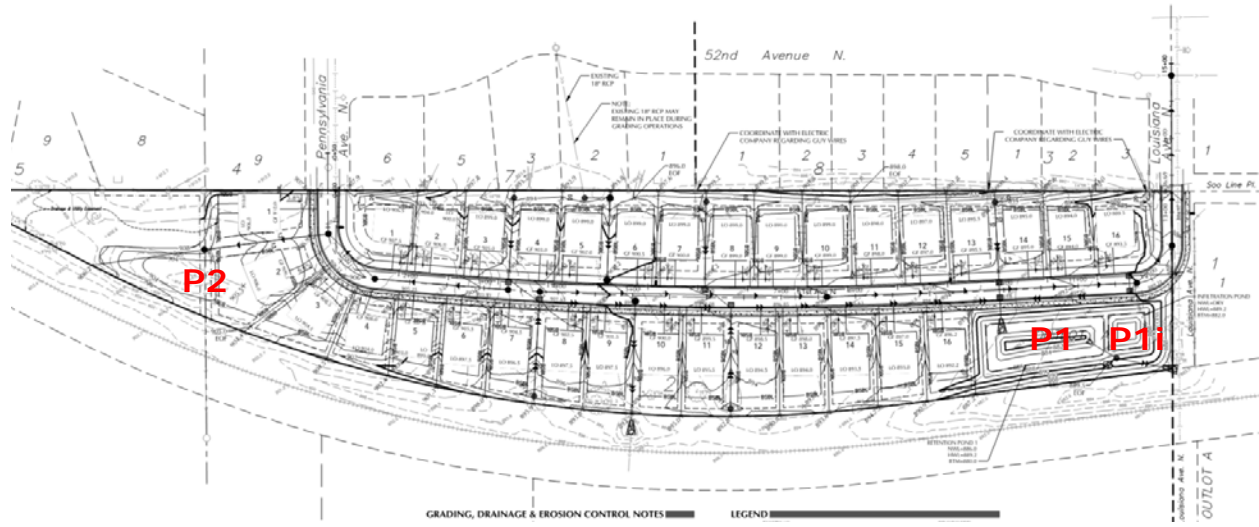

# Technical Memo



Responsive partner.  
Exceptional outcomes.

**To:** Shingle Creek/West Mississippi WMC Commissioners  
**From:** Diane Spector  
**Date:** March 13, 2019  
**Subject:** Education and Outreach Update

---

**WMWA.** WMWA met on Tuesday, March 12, 2019. The next meeting will be Tuesday, April 9, 2019 at Plymouth City Hall.

*Watershed PREP and Education and Outreach Events.* Educators are currently scheduling spring classroom visits. A reminder that the educators are available to table at city and school events, contact Amy Juntunen at [amy@jass.biz](mailto:amy@jass.biz). In 2019 the educators will be putting together some potential presentations for lake associations.

*Ten Things Brochure.* The brochure is in final edits and the group is working with Hennepin County to finalize the design and layout, and we expect that Hennepin County will print the brochure at no cost to the watersheds.

*Special Project Discussion.* Each year the four watersheds budget \$8,000 to undertake a larger project. The group discussed whether the watersheds should update the public opinion survey conducted in 2008. That was a professional, scientific phone survey that contacted 400 households in the four watersheds to obtain baseline information about the level of water and natural resources knowledge in the area and what barriers to implementing household practices might be. That survey was \$10,000 ten years ago, and would likely cost more today. It was the consensus of the group that while this information is helpful, updating the survey would not likely change the education and outreach being currently provided, and that the money would better be used to fund implementation practices. It was also the consensus that it would be useful to have a scientific survey done to see if awareness has been raised in the ensuing ten years. It was agreed that this should be done on a Metro scale, and that WMWA should request that Watershed Partners, a consortium of agencies, cities, and watersheds across the Metro, consider this.

The group also discussed purchasing educational displays and noted that the native plant root puller display is extremely popular among both adults and youth. The nonprofit Blue Thumb has these custom displays made for about \$3,500. The displays educate users about one of the many features of native plants, their root lengths compared to turf grass and ornamental plants. This makes them ideal for stabilizing streambanks and lakeshores and for promoting infiltration by creating deep root channels. The display allows the user to pull out a string that is as long as the roots are deep. The strings are spring-wound, which then automatically retracts the strings back into the display. It was the consensus



to get more information and a quote to be considered at the next WMWA meeting. The display can be used at booths and city events, and it was suggested that it could also be a movable display, set up at city halls or community centers for a few weeks rotating amongst cities. It would help support the Pledge to Plant campaign as well.

And just as a reminder, Blue Thumb is a valuable source of information, including educational materials, how-to guides, a plant finder tool, and more. <http://www.blue-thumb.org/public-resources/>



**Website/Social Media.** The website Google Analytics for January 2019 are attached, as are the Facebook insights for the last 28 days for both Shingle Creek and WMWA. As a reminder, Facebook Reach is the number of times a post was viewed in a feed, Engagement is an action – a click, comment, share, or reaction.







Left: Source: MCWD

Below: Source: Washington Conservation District



## Shingle Creek FB Metrics

Last 28 days: 134 total Likes (2 new), 171 Reaches, 84 Engagements.

Published	Post	Type	Targeting	Reach <sup>i</sup>	Engagement
03/12/2019 1:00 PM	 Right now is a great time to adopt your nearest storm drain! Drains			43 	3 3 
03/12/2019 12:38 PM	 Shingle Creek Watershed Management Organization			52 	16 2 
03/11/2019 4:44 PM	 The National Weather Service has issued an Areal Flood Watch, which			101 	3 5 
03/08/2019 1:42 PM	 It's looking good for Twin Lake carp harvesting on Monday, March 11.			93 	5 7 
03/01/2019 1:22 PM	 I'd like something like this on my driveway...			59 	10 2 
02/27/2019 12:12 PM	 Shingle Creek Watershed Management Organization			41 	9 1 
02/20/2019 12:38 PM	 Neither snow, slush nor sunken ice keeps these scientists from wetland			63 	9 8 
02/20/2019 10:35 AM	 France Becomes The First Country To Ban All Five Pesticides Linked To			73 	7 5 

**Shingle Creek Watershed Management Organization**  
Published by Amy Juntunen (?) · 23 hrs · 







**Mississippi Watershed Management Organization**  
Yesterday at 9:07 AM · 

Samples collected from local stormsewers yesterday. Notice how dark the water is. Pollutants that accumulated over the course of the winter are now being flush...  
[See More](#)

### Performance for Your Post

**52** People Reached

**2** Reactions, Comments & Shares <sup>i</sup>

<b>1</b> Like 	<b>1</b> On Post	<b>0</b> On Shares
<b>1</b> Sad 	<b>1</b> On Post	<b>0</b> On Shares
<b>0</b> Comments	<b>0</b> On Post	<b>0</b> On Shares
<b>0</b> Shares	<b>0</b> On Post	<b>0</b> On Shares

**16** Post Clicks

<b>2</b> Photo Views	<b>0</b> Link Clicks <sup>i</sup>	<b>14</b> Other Clicks <sup>i</sup>
----------------------	-----------------------------------	-------------------------------------

**NEGATIVE FEEDBACK**

<b>0</b> Hide Post	<b>0</b> Hide All Posts
<b>0</b> Report as Spam	<b>0</b> Unlike Page

Reported stats may be delayed from what appears on posts

## West Metro Water Alliance (WMWA) Metrics

Last 28 days: 147 total Likes (1 new), 687 Reaches, 203 Engagements

Published	Post	Type	Targeting	Reach	Engagement
03/13/2019 7:00 AM	Thank you, in advance, for doing your part in keeping water clean and reducing flooding.			41	0 0
03/12/2019 12:37 PM	West Metro Water Alliance			56	13 3
03/11/2019 11:33 PM	Right now is a great time to adopt your nearest storm drain! Drains clogged with ice can't drain the water from your roadway. With a quick warm up			69	13 4
03/11/2019 4:45 PM	West Metro Water Alliance			28	1 0
03/04/2019 8:10 AM	This is an interesting read! #PledgeToPlant <a href="http://www.westmetrowateralliance.org/">http://www.westmetrowateralliance.org/</a>			180	12 7
03/01/2019 2:03 PM	West Metro Water Alliance			36	4 1
02/28/2019 5:23 PM	Get ready to Adopt a Drain! <a href="https://www.minnehahacreek.org/blog/get-ready-%E2%80%9Cadopt-drain%E2%80%9D-your-">https://www.minnehahacreek.org/blog/get-ready-%E2%80%9Cadopt-drain%E2%80%9D-your-</a>			51	2 0
02/28/2019 5:21 PM	West Metro Water Alliance			24	1 1
02/28/2019 5:05 PM	Neither snow, slush nor sunken ice keeps these scientists from wetland restoration			100	7 7
02/28/2019 5:05 PM	GRACE's Water Footprint Calculator			38	4 1
02/28/2019 4:51 PM	The time to act is now. Please click, copy, paste, and send. Super easy and super important!			50	10 0
02/28/2019 4:50 PM	Do you know a commercial lawn service provider? Great free workshop available!			10	2 1
02/26/2019 12:29 PM	Climate scientists have been saying all along that one of the primary effects of climate change is the disruption of the water cycle. Since so			105	15 6
02/23/2019 3:01 PM	West Metro Water Alliance			74	3 7
02/20/2019 8:50 AM	On this snowy, snowy day it's nice to envision a garden of wildflowers free of chemicals. An option to avoid needing pesticides is planting flowers			451	14 26



Most engaging post:

 **West Metro Water Alliance**  
Published by Dawn Dubats Page [?] · February 20 at 8:50 AM · 🌐

On this snowy, snowy day it's nice to envision a garden of wildflowers free of chemicals. An option to avoid needing pesticides is planting flowers that are resilient on their own. Learn more at <http://www.westmetrowateralliance.org/> and make your Pledge to Plant for Pollinators AND Clean Water!



HERBS-INFO.COM  
**France Becomes The First Country To Ban All Five Pesticides Linked To Bee Deaths**

### Performance for Your Post

**451** People Reached

**26** Reactions, Comments & Shares <sup>?</sup>

<b>21</b> Like	<b>6</b> On Post	<b>15</b> On Shares
-------------------	---------------------	------------------------

<b>1</b> Love	<b>1</b> On Post	<b>0</b> On Shares
------------------	---------------------	-----------------------

<b>0</b> Comments	<b>0</b> On Post	<b>0</b> On Shares
----------------------	---------------------	-----------------------

<b>4</b> Shares	<b>4</b> On Post	<b>0</b> On Shares
--------------------	---------------------	-----------------------

**14** Post Clicks

<b>0</b> Photo Views	<b>3</b> Link Clicks <sup>?</sup>	<b>11</b> Other Clicks <sup>?</sup>
-------------------------	--------------------------------------	--

#### NEGATIVE FEEDBACK

**0** Hide Post      **0** Hide All Posts

**0** Report as Spam      **0** Unlike Page

Reported stats may be delayed from what appears on posts

SCWM

Feb 1, 2019 - Feb 28, 2019

 All Users  
100.00% Sessions

Users

**257**  
% of Total: 100.00% (257) 

Pageviews

**703**  
% of Total: 98.60% (713) 

Pageviews by Landing Page

Landing Page	Pageviews
/	476
/staff.html	51
/maps.html	31
/meetings.html	21
/tmdls.html	17
/technical-advisory-committee.html	15
/annual-reports.html	14
/minutes--meeting-packets.html	10
/twin-lake-carp-management.html	9
/tac-meetings.html	8

Pageviews and Unique Pageviews by Page

Page	Pageviews	Unique Pageviews
/	246	189
/minutes--meeting-packets.html	56	47
/staff.html	43	38
/application-materials.html	40	39
/maps.html	32	27
/contact-us.html	28	23
/twin-lake-carp-management.html	26	18
/tmdls.html	20	17
/water-quality.html	17	13
/meetings.html	14	10