

Shingle Creek Watershed Management Commission Treasurer's Report

	2022 Budget	November	December	%age YTD	2022 YTD
REVENUE					
Application Fees	20,000			80.00	16,000.00
Member Assessments	363,590			100.00	363,590.00
Interest and Dividends	5,000	7,647.83		621.78	31,089.02
Education Reimbursement	33,000	14,000.00		42.42	14,000.00
Rain Garden Workshops	0				-
<i>Transfer to (from) Grants (see following pages)</i>		40,581.56	-		333,528.55
<i>Transfer to (from) CIPs</i>					476,922.22
<i>Transfer to (from) Closed Projects Account</i>					-
TOTAL REVENUE	421,590	62,229.39	-		1,235,129.79
EXPENSES					
ADMINISTRATION					
Administrative Services	71,000	3,509.57	3,962.04	65.86	46,763.63
Engineering Support	17,000	825.87	1,450.00	70.65	12,009.77
Project Reviews	1,500	35.00	13.23	55.97	839.58
ENGINEERING					
Administration	75,000	4,839.95	4,916.67	104.04	78,033.51
Grant Application Writing	12,000	1,168.75	1,028.50	99.84	11,980.50
Project Reviews/WCA	43,000	4,083.25	8,352.78	83.66	35,971.82
TMDL 5 Year Reviews	5,000			99.52	4,976.00
LEGAL - Legal Services	5,500	394.10	366.45	83.06	4,568.50
MISCELLANEOUS					
Bookkeeping	8,000	315.00	203.70	72.74	5,819.10
Audit	6,500			95.38	6,200.00
Insurance & Bonding	3,200			104.22	3,335.00
Meeting Expense	5,000	235.89	258.99	58.15	2,907.69
PROGRAMS					
Stream Monitoring	35,000	261.36		99.16	34,707.44
Stream Monitoring (USGS)	4,200			180.95	7,600.00
Lake Monitoring	28,000	124.00		99.40	27,832.53
Citizen Assisted Lake Monitoring (CAMP)	4,800			40.63	1,950.25
Volunteer Wetland Monitoring (WHEP)	2,000			-	-
Volunteer Stream Monitoring (River Watch)	1,000			-	-
Annual Monitoring Report	16,000			100.28	16,045.16
Water Quality Education					
Education Program	16,500	1,187.45	1,324.62	81.52	13,450.69
WMWA General Programs	20,000	859.19	579.27	38.91	7,781.30
WMWA Implementation/Watershed Prep	24,500			74.78	18,321.82
Rain Garden Workshops	0				-
Management Plan/Amendments	1,000			100.79	1,007.94
4th Generation Plan		505.73	216.34		50,173.42
<i>Transfer to (from) Grants (see following pages)</i>		6,090.75	4,673.71		128,663.25
<i>Transfer to (from) CIPs</i>		64,444.50			154,545.65
<i>Transfer to (from) City Cost Share Fund</i>					-
<i>Transfer to (from) Partnership BMP Cost Share Fund</i>					-
<i>Transfer to (from) Closed Projects Account</i>					2,840.25
<i>To/From Reserves</i>	15,890				
TOTAL OPERATING EXPENSE	421,590	88,880.36	27,346.30		678,324.80
CASH SUMMARY					
4M Fund Balance at 12/31/21					2,196,273.66
Plus Revenue Received 2022 to date					1,260,374.17
Minus Claims Approved to Date					(786,117.20)
Minus Claims Presented Current Month					(27,346.30)
Fund Balance		2,670,530.63			2,643,184.33

Shingle Creek Watershed Management Commission Treasurer's Report

Claims Presented	General Ledger Acct No	November	December		Total
Kennedy & Graven					491.75
Legal - General	52001		366.45		
Legal - 4th Gen Plan	52008		61.50		
Legal - Education	57008		63.80		
State Register	53001		69.00		69.00
Stantec					20,397.54
General Engineering	51001		4,916.67		
Grant Writing	51005		1,028.50		
Project Reviews	51002		8,352.78		
TMDL 5-Year Reviews	56011				
4th Generation Plan	51010				
Legal Boundary Update (4th Gen Plan)	51010				
CAMP	56002				
Stream Monitoring	56004				
Lake Monitoring	56010				
Education	57008		1,238.88		
Education - WMWA	57009		187.00		
Annual Water Monitoring Report	58002				
Meadow Lake Mgt Plan Grant	70736				
Meadow Lake Mgt Plan Phase 2 Grant	70739		4,165.66		
Crystal Lake Management Plan Grant	70732		439.61		
SRP Channel Filter Project Grant	70738				
Humboldt Pond Filter-Creekview Park Area F	70504/CI Pr				
Bass Lake Vegetation Impv CPL Grant	70741		68.44		
Judie Anderson's Secretarial Service					392.27
WMWA General Expense	57009		392.27		
WMWA Educators/WS Prep	57011				
Judie Anderson's Secretarial Service					5,995.74
Administration	53001		3,893.04		
Project Review Support	53002		13.23		
Bookkeeping / Audit Prep	54002		203.70		
Meeting Expense	54001		258.99		
Education Programs	57008		21.94		
Engineering Support	53004		1,397.18		
Engineering Support - CIP General	53004		52.82		
Eng. Spt - 3rd Gen Plan Amendment	53007				
Engineering Support - 4th Gen Plan	53010		154.84		
Total Claims					27,346.30

Kennedy & Graven, Chartered

150 South Fifth Street, Suite 700
Minneapolis, MN 55402

(612) 337-9300

41-1225694

November 20, 2022

Statement No. 171133

Shingle Creek Watershed Management Commission

Judie Anderson

JASS - Watershed Administrators
3235 Fernbrook Lane
Plymouth, MN 55447

Through October 31, 2022

SH220-00001 General

491.75

Total Current Billing: 491.75

I declare, under penalty of law, that this account, claim or demand is just and correct and that no part of it has been paid.

DocuSigned by:

Troy J. Gilchrist

67F85C8FDF28444
Signature of Claimant

Kennedy & Graven, Chartered

150 South Fifth Street, Suite 700
Minneapolis, MN 55402

Shingle Creek Watershed
Judie Anderson

October 31, 2022

SH220-00001 General

Through October 31, 2022

For All Legal Services As Follows:

			Hours	Amount
10/4/2022	SMM	Work on Records Retention Policy; research; send to atty for review	0.70	79.80
10/6/2022	SMM	Make edits to records retention policy	0.10	11.40
10/7/2022	SMM	Revise Shingle Creek Education Professional Services Agreement for 2022-2023	0.20	22.80
10/10/2022	TJG	Review and revise education agreement; email same to Amy J for review; work on resolution to consent to boundary changes	0.50	102.50
10/13/2022	TJG	Prepare for, travel to, and attend meeting	1.30	266.50
Total Services:			\$	483.00

EDUCATION - 41.00
BOUNDARY CHANGES - 61.50

For All Disbursements As Follows:

10/13/2022	Troy J. Gilchrist - Mileage	8.75
Total Disbursements:		\$ 8.75

Total Services and Disbursements: \$ 491.75

SC EDUCATION - 22.80

SC EDUCATION - 20.50

WM EDUCATION - 20.50

SC 4th Gen Plan - 61.50

SC General 366.45

G0203 001
 DEPT OF ADMIN/PMD
 MINNESOTA'S BOOKSTORE
 50 SHERBURNE AVENUE, SUITE 309
 ST. PAUL MN 55155



Customer No: 7002130
 Payment Terms: Due in 30
 Due Date: December 31, 2022
 Invoice: 00000725550
 Invoice Date: December 1, 2022
 From Date: November 28, 2022 To Date: November 28, 2022
 Purchase Order:
 Page: 1 of 1

Bill To:
 SHINGLE CREEK WATERSHED
 ACCOUNTS PAYABLE
 3235 FERNBROOK LN
 PLYMOUTH MN 55447

AMOUNT DUE: 69.00

For billing questions, please call 651-201-3204

Original

Line	Identifier	Description	Qty	UOM	Unit Amt	Net Amount
1		State Register Vol. 47 #22	4.00	EA	13.50	54.00
		Request for Interest Proposals - Professional Services for Legal, Engineering and Technical, and Administrative Consulting				
2		Affidavit	1.00	EA	15.00	15.00
Subtotal:						<u>69.00</u>
Amount Due:						<u>69.00</u>

Bill To:
 SHINGLE CREEK WATERSHED
 ACCOUNTS PAYABLE
 3235 FERNBROOK LN
 PLYMOUTH MN 55447

Customer No: 7002130
 Payment Terms: Due in 30
 Due Date: December 31, 2022

Address Change? If yes, Check box. →
 Write correct address on back.

Please Remit To:
 DEPT OF ADMIN/PLANT MANAGEMENT
 MINNESOTA'S BOOKSTORE
 50 SHERBURNE AVENUE
 SUITE 309
 ST. PAUL MN 55155

Amount Due: 69.00

Amount Remitted

G0203 7002130ZZZZZZZ 0 00000725550ZZZZZZZZZZ 1 0000006900



INVOICE

Invoice Number 2012523
Invoice Date December 2, 2022
Purchase Order -
Customer Number 165842
Project Number 227704733

Bill To

Shingle Creek Watershed Management Commission
 Judie Anderson
 3235 Fernbrook Lane
 Plymouth MN 55447
 United States

Please Remit To

Stantec Consulting Services Inc. (SCSI)
 13980 Collections Center Drive
 Chicago IL 60693
 United States

Project	Shingle Creek 2022 General Engineering Services		
Project Manager	Spector, Diane F	Contract Upset	81,064.00
Current Invoice Total (USD)	4,916.67	Amount Billed to Date	78,033.51
		For Period Ending	November 25, 2022

Top Task 100 2022 General Engineering Services

Professional Services

Category/Employee	Current Hours	Rate	Current Amount
Kemmitt, Kathrine Lee (Katie)	13.25	135.00	1,788.75
Spector, Diane F	9.50	187.00	1,776.50
Shoemaker, Todd E	5.25	207.00	1,086.75
Matthiesen, Edward Armin (Ed)	0.25	210.00	52.50
Subtotal Professional Services	<u>28.25</u>		<u>4,704.50</u>

Disbursements

Usage - Vehicle	29.38
Direct - Printing	0.93
Direct - Testing & Lab Charges	181.86
Subtotal Disbursements	<u>212.17</u>

Top Task Subtotal	2022 General Engineering Services	4,916.67
Total Fees & Disbursements		<u>4,916.67</u>
INVOICE TOTAL (USD)		4,916.67

Due upon receipt or in accordance with terms of the contract



INVOICE

Invoice Number 2012520
Invoice Date December 2, 2022
Purchase Order --
Customer Number 165842
Project Number 227704716

Bill To

Shingle Creek Watershed Management Commission
 Judie Anderson
 3235 Fernbrook Lane
 Plymouth MN 55447
 United States

Please Remit To

Stantec Consulting Services Inc. (SCSI)
 13980 Collections Center Drive
 Chicago IL 60693
 United States

Project	Shingle Creek 2022 Grant Writing			
	Project Manager	Spector, Diane F	Contract Upset	12,000.00
	Current Invoice Total (USD)	1,028.50	Amount Billed to Date	11,980.50
			For Period Ending	November 25, 2022

Top Task 100 2022 Grant Writing

Professional Services

Category/Employee		Current Hours	Rate	Current Amount
	Spector, Diane F	5.50	187.00	1,028.50
	Subtotal Professional Services	<u>5.50</u>		<u>1,028.50</u>

Top Task Subtotal 2022 Grant Writing 1,028.50

Total Fees & Disbursements 1,028.50
INVOICE TOTAL (USD) 1,028.50

Due upon receipt or in accordance with terms of the contract



INVOICE

Invoice Number	2012521
Invoice Date	December 2, 2022
Purchase Order	--
Customer Number	165842
Project Number	227704718

Bill To

Shingle Creek Watershed Management Commission
 Judie Anderson
 3235 Fernbrook Lane
 Plymouth MN 55447
 United States

Please Remit To

Stantec Consulting Services Inc. (SCSI)
 13980 Collections Center Drive
 Chicago IL 60693
 United States

Project	Shingle Creek 2022 Project Reviews		
Project Manager	Spector, Diane F	Contract Upset	43,000.00
Current Invoice Total (USD)	8,352.78	Amount Billed to Date	35,971.82
		For Period Ending	November 25, 2022

Top Task	100	General			
Low Task	100	General			
<u>Professional Services</u>					
Category/Employee			Current Hours	Rate	Current Amount
		Clapp, Lucas W	11.75	120.00	1,410.00
		Spector, Diane F	6.25	187.00	1,168.75
		Shoemaker, Todd E	2.50	207.00	517.50
		Matthiesen, Edward Armin (Ed)	1.00	210.00	210.00
		Subtotal Professional Services	<u>21.50</u>		<u>3,306.25</u>
Disbursements					
		Direct - Printing			5.48
		Subtotal Disbursements			<u>5.48</u>
Low Task Subtotal	General				3,311.73

Top Task Subtotal	General				3,311.73
-------------------	---------	--	--	--	----------

Top Task	300	Project Reviews			
Low Task	300.005	SC2022-04 Arbor Lakes Phase 3			
<u>Professional Services</u>					
Category/Employee			Current Hours	Rate	Current Amount
		Clapp, Lucas W	0.50	120.00	60.00
		Subtotal Professional Services	<u>0.50</u>		<u>60.00</u>
Low Task Subtotal	SC2022-04 Arbor Lakes Phase 3				60.00

Low Task	300.006	SC2022-05 North 100 Business Park (Sears)			
-----------------	----------------	--	--	--	--



INVOICE

Invoice Number 2012521
Invoice Date December 2, 2022
Purchase Order --
Customer Number 165842
Project Number 227704718

Disbursements

Direct - Printing 1.56
Subtotal Disbursements 1.56

Low Task Subtotal **SC2022-05 North 100 Business Park (Sears)** 1.56

Low Task 300.007 **SC2022-06 Opportunity Site**

Professional Services

Category/Employee	Current Hours	Rate	Current Amount
Clapp, Lucas W	20.00	120.00	2,400.00
Wochenske, Jordan	1.00	124.00	124.00
Osterdyk, Eric J	1.25	141.00	176.25
Shoemaker, Todd E	7.00	207.00	1,449.00
Subtotal Professional Services	<u>29.25</u>		<u>4,149.25</u>

Disbursements

Direct - Printing 2.24
Subtotal Disbursements 2.24

Low Task Subtotal **SC2022-06 Opportunity Site** 4,151.49

Low Task 300.008 **SC2022-07 St. Therese**

Professional Services

Category/Employee	Current Hours	Rate	Current Amount
Shoemaker, Todd E	4.00	207.00	828.00
Subtotal Professional Services	<u>4.00</u>		<u>828.00</u>

Low Task Subtotal **SC2022-07 St. Therese** 828.00

Top Task Subtotal Project Reviews 5,041.05

Total Fees & Disbursements 8,352.78
INVOICE TOTAL (USD) **8,352.78**

Due upon receipt or in accordance with terms of the contract



INVOICE

Invoice Number 2012519
Invoice Date December 2, 2022
Purchase Order --
Customer Number 165842
Project Number 227701416

Bill To

Shingle Creek Watershed Management Commission
 Accounts Payable
 3235 Fernbrook Lane
 Plymouth MN 55447
 United States

Please Remit To

Stantec Consulting Services Inc. (SCSI)
 13980 Collections Center Drive
 Chicago IL 60693
 United States

Project	B001240-20-216: Crystal Lake Management Plan		
Project Manager	Spector, Diane F	Contract Upset	140,830.00
Current Invoice Total (USD)	439.61	Amount Billed to Date	124,559.68
		For Period Ending	November 25, 2022

Top Task	101B	Alum Application	
Disbursements			
		Usage - Vehicle	6.88
		Subtotal Disbursements	<u>6.88</u>
Top Task Subtotal	Alum Application		6.88

Top Task	101C	Water Quality Monitoring	
Disbursements			
		Direct - Testing & Lab Charges	91.48
		Subtotal Disbursements	<u>91.48</u>
Top Task Subtotal	Water Quality Monitoring		91.48

Top Task	102A	Carp Assessment & Tracking	
Professional Services			
Category/Employee		Current Hours	Current Rate
			Current Amount
	Krautmann, Kurt Thompson	2.00	120.00
	Kemmitt, Kathrine Lee (Katie)	0.75	135.00
	Subtotal Professional Services	<u>2.75</u>	<u>341.25</u>
Top Task Subtotal	Carp Assessment & Tracking		341.25

	Total Fees & Disbursements	<u>439.61</u>
	INVOICE TOTAL (USD)	439.61

Due upon receipt or in accordance with terms of the contract



INVOICE

Invoice Number 2012161
Invoice Date December 2, 2022
Purchase Order --
Customer Number 165842
Project Number 227705161

Bill To

Shingle Creek Watershed Management Commission
 Judie Anderson
 3235 Fernbrook Lane
 Plymouth MN 55447
 United States

Please Remit To

Stantec Consulting Services Inc. (SCSI)
 13980 Collections Center Drive
 Chicago IL 60693
 United States

Project	Bass Lake Vegetation Improvements		
Project Manager	Kemmitt, Katie	Contract Upset	24,780.00
Current Invoice Total (USD)	68.44	Amount Billed to Date	17,961.02
		For Period Ending	November 25, 2022

Top Task	100	Bass Lake Vegetation Improvement	
Low Task	100.002	Installation	
Disbursements		Direct - Printing	0.94
		Subtotal Disbursements	<u>0.94</u>
Low Task Subtotal	Installation		0.94

Low Task	100.004	Reporting		
Professional Services				
Category/Employee		Current Hours	Rate	Current Amount
	Kemmitt, Kathrine Lee (Katie)	0.50	135.00	67.50
	Subtotal Professional Services	<u>0.50</u>		<u>67.50</u>
Low Task Subtotal	Reporting			67.50

Top Task Subtotal	Bass Lake Vegetation Improvement		68.44
	Total Fees & Disbursements		<u>68.44</u>
	INVOICE TOTAL (USD)		68.44

Due upon receipt or in accordance with terms of the contract



INVOICE

Invoice Number 2012526
Invoice Date December 2, 2022
Purchase Order --
Customer Number 165842
Project Number 227705219

Bill To

Shingle Creek Watershed Management Commission
 Judie Anderson
 3235 Fernbrook Lane
 Plymouth MN 55447
 United States

Please Remit To

Stantec Consulting Services Inc. (SCSI)
 13980 Collections Center Drive
 Chicago IL 60693
 United States

Project	Meadow Lake Management Plan Phase 2				
	Project Manager	Spector, Diane F	Contract Upset		102,810.00
	Current Invoice Total (USD)	4,165.66	Amount Billed to Date		20,244.86
			For Period Ending		November 25, 2022
Top Task	100	Professional Services			
Low Task	100.101	Project Management and Reporting			
<u>Professional Services</u>					
Category/Employee			Current Hours	Rate	Current Amount
		Megow, Erik Robert	0.50	165.00	82.50
		Subtotal Professional Services	<u>0.50</u>		<u>82.50</u>
Low Task Subtotal	Project Management and Reporting				82.50
Low Task	100.102	Monitoring and Data Gathering			
<u>Professional Services</u>					
Category/Employee			Current Hours	Rate	Current Amount
		Krautmann, Kurt Thompson	10.50	120.00	1,260.00
		Kemmitt, Kathrine Lee (Katie)	3.00	135.00	405.00
		Subtotal Professional Services	<u>13.50</u>		<u>1,665.00</u>
Disbursements					
		Direct - Testing & Lab Charges			63.16
		Direct - Other Direct Expenses			2,355.00
		Subtotal Disbursements			<u>2,418.16</u>
Low Task Subtotal	Monitoring and Data Gathering				4,083.16
Top Task Subtotal	Professional Services				4,165.66
		Total Fees & Disbursements			<u>4,165.66</u>
		INVOICE TOTAL (USD)			4,165.66



Your Virtual Administrator

3235 Fernbrook Lane Plymouth MN 55447

Shingle Creek Watershed Management Commission
3235 Fernbrook Lane
Plymouth MN 55447

5-Dec-22

Re: 2022 WMWA General Expense and Watershed PREP

Description	Rate	Hours/ No.	Amount	Total
General Expense				
Secretarial	65.00		-	
Administrative	70.00	3.71	259.70	
Administrative - website, Facebook, Twitter	65.00		-	
Offsite, WMWA meetings, Blue Thumb, Watershed Partners, Home Expo, Henn County, city events	75.00	1.75	131.25	
Website hosting, Godaddy renewal	1.00		-	
Reimbursables	1.00	1.32	1.32	
Total General Expense				392.27
Watershed PREP				
Secretarial	60.00		-	
Administrative	65.00		-	
Offsite	70.00		-	
Reimbursables	1.00		-	
Total Watershed PREP				-
Total this invoice				392.27
Partner Share				98.07



3235 Fernbrook Lane
Plymouth MN 55447

Shingle Creek / West Mississippi Watershed Management Commissions
3235 Fernbrook Lane
Plymouth, MN 55447

December 5, 2022

	Share	G/L	Shingle Creek			West Mississippi			Total Project Area	
								SC	WM	
Administrative	70-30	53001	46.09	70.00	2,258.41	70.00	967.89			
Administrative		53001	0.25	70.00	17.50	0.25	70.00	17.50		
Admin - offsite	70-30	53001	2.50	75.00	131.25	75.00	56.25			
Annual Storage Rental - .14/.11		53001	1.00	50.54	50.54	1.00	39.71	39.71		
Office Support	70-30	53001	18.00	70.00	882.00	70.00	378.00			
Data Processing/File Mgmt	70-30	53001	1.50	70.00	73.50	70.00	31.50			
Admin Reimbursables		53001	479.84	1.00	479.84	211.58	1.00	211.58	3,893.040	1,702.430
Bookkeeping		54022		65.00	-	65.00	-			
Bookkeeping		54022	2.91	70.00	203.70	1.50	70.00	105.00		
Audit Prep		54022		70.00	-	70.00	-	203.700	105.000	
Meal Expense	70-30	54001	369.98	1.00	258.99	70.00	110.99	258.986	110.994	
Project / WCA Reviews - Admin		53002	0.17	70.00	11.90	0.58	70.00	40.60		
Project Reviews - File Mgmt		53002		60.00	-	60.00	-			
Reimbursable Expenses		53002	1.33	1.00	1.33	5.00	1.00	5.00	13.230	45.600
Education - Admin	50-50	57008	0.500	70.00	17.50	70.00	17.50			
Education Reimbursables	50-50	57008	4.44	1.00	4.44	4.44	1.00	4.44	21.940	21.940
Engrg Support 4G Plan - Secre	70-30	53004		65.00	-	65.00	-			
Engrg Support 4G Plan - Admin	70-30	53004	3.16	70.00	154.84	70.00	66.36			
Engrg Support 4G Plan - Offsite	70-30	53004		75.00	-	75.00	-			
Engrg Support 4G Plan Rembursab	70-31	53004		1.00	-	1.00	-	154.840	66.360	
Engineering Support - Secre	70-30	53004		65.00	-	65.00	-			
Engineering Support - Admin	70-30	53004	24.92	70.00	1,221.08	70.00	523.32			
Engineering Support -offsite	70-30	53004	1.65	75.00	86.63	75.00	37.13			
Engineering Support Rembursables		53004	89.48	1.00	89.48	1.00	-	1,397.185	560.445	
Engrg Support 3G Plan - Secre	70-30	53004		65.00	-	65.00	-			
Engrg Suppor3G Plan - Admin	70-30	53004		70.00	-	70.00	-			
Engrg Support3G Plan - Offsite	70-30	53004		75.00	-	75.00	-			
Engrg Suppor3G Plan Rembursable	70-31	53004		1.00	-	1.00	-	0.000	-	
Engineering Support - CIP -Secre	50-50	53004		50.00	-	50.00	-			
Engineering Support - CIP Admin		53004	0.81	65.00	52.65	65.00	-			
Engineering Support - CIP Admin	50-50	53004		70.00	-	70.00	-			
Engineering Support - CIP	50-50	53004		70.00	-	70.00	-			
Engineering Support - CIP Rembursables		53004	0.17	1.00	0.17	0.17	1.00	0.17	52.820	0.170
					5,995.74		2,612.94	5,995.741	2,612.939	

**West Mississippi Watershed Management Commission
Treasurer's Report**

	2022 Budget	November	December	%age YTD	2022 YTD
REVENUE					
Application Fees	18,000	2,800.00		83.33	15,000.00
Member Assessments	156,200			100.00	156,200.00
Interest & Dividend Income	2,500	2,858.84		457.99	11,449.64
Miscellaneous Income					-
<i>Transfer to (from) CIPs (see CIP Tracker page)</i>					79,799.57
<i>To (From) Reserve</i>	5,000				-
TOTAL REVENUE	181,700	5,658.84	-		262,449.21
EXPENSES					
ADMINISTRATION					
Administrative Services	32,000	1,618.73	1,771.43	65.28	20,889.87
Engineering Support	4,000	353.94	560.62	128.61	5,144.50
Project Reviews	1,500	14.12	45.60	28.03	420.46
ENGINEERING					
Administration	33,500	2,905.42	4,099.74	96.44	32,306.31
Grant Application Writing	500			93.50	467.50
Project Review	30,000	1,852.85	3,118.50	79.95	23,983.99
LEGAL					
Legal Services	4,500	394.10	366.45	76.51	3,442.80
MISCELLANEOUS					
Bookkeeping	3,300	169.40	105.00	96.92	3,198.30
Audit	5,000			94.00	4,700.00
Contingency	0				-
Insurance & Bonding	3,100			93.48	2,898.00
Meeting Expense	2,700	101.09	110.99	46.15	1,246.14
PROJECTS					
Macroinvertebrate Monitoring (River Watch)	0				-
Volunteer Wetland Monitoring (WHEP)	2,000			0.00	-
Outfall and Stream Monitoring	22,600	217.00	1,904.13	30.47	6,886.04
Annual Monitoring Report	8,000			98.79	7,902.84
Water Quality Education					
Education	16,500	1,187.45	1,281.31		13,407.37
Education Grants	0				-
WMWA General Programs	5,000		3,000.00	60.00	3,000.00
WMWA Implementation/Watershed Prep	6,500		4,000.00	61.54	4,000.00
Rain Garden Workshops	0				-
Management Plan/Amendments	1,000				230.53
4th Generation Plan		352.49	127.86		29,274.07
<i>Transfer to (from) CIPs</i>					293.60
<i>Transfer to (from) Grants</i>					-
<i>To (from) Reserves</i>					-
TOTAL OPERATING EXPENSE	181,700	9,166.59	20,491.63		163,692.32
CASH SUMMARY					
4M Fund Balance at 12/31/21					892,999.83
Plus Revenue Received to Date					264,493.55
Minus Claims Approved to Date					(196,156.20)
Minus Claims Presented Current Month					20,491.63
Fund Balance		1,002,320.44			981,828.81

**West Mississippi Watershed Management Commission
Treasurer's Report**

Claims Presented	General Ledger Acct No.	November	December		
					Total
Kennedy & Graven					448.45
Legal - General	52001		366.45		
Legal - 4th Gen Plan	52008		61.50		
Legal - Education	57008		20.50		
Shingle Creek WMWA					7,000.00
SC - WMWA General	57009		3,000.00		
SC - WMWA Eds/WS PREP	57009		2,000.00		
SC - WMWA Special Projects	57009		2,000.00		
State Register - Request interest proposals	53001		69.00		69.00
Stantec					10,361.24
General Engineering	51001		4,099.74		
Project Reviews	51002		3,118.50		
Grant Applica/Research	51005				
4th Generation Plan	51008				
Legal Boundary Update (4th Gen Plan)	51008				
Education Program	57008		1,238.87		
Water Monitoring Program	58011		1,904.13		
Annual Water Monitoring Report	58002				
Judie Anderson's Secretarial Service					2,612.94
Administration	53001		1,702.43		
Bookkeeping / Audit Prep	54002		105.00		
Project Review Support	53002		45.60		
Meeting Expense - Previous Mo. Meal	54001		110.99		
Education Programs	57008		21.94		
Engineering Support	53004		560.45		
Eng Support - 3rd Gen Plan Amendment	53007				
Engineering Support - 4th Gen Plan	53008		66.36		
Engineering Support - CIPs	53004		0.17		
Total Claims					20,491.63

Kennedy & Graven, Chartered

150 South Fifth Street, Suite 700
Minneapolis, MN 55402

Shingle Creek Watershed
Judie Anderson

October 31, 2022

SH220-00001 General

Through October 31, 2022

For All Legal Services As Follows:

			Hours	Amount
10/4/2022	SMM	Work on Records Retention Policy; research; send to atty for review	0.70	79.80
10/6/2022	SMM	Make edits to records retention policy	0.10	11.40
10/7/2022	SMM	Revise Shingle Creek Education Professional Services Agreement for 2022-2023	0.20	22.80
10/10/2022	TJG	Review and revise education agreement; email same to Amy J for review; work on resolution to consent to boundary changes	0.50	102.50
10/13/2022	TJG	Prepare for, travel to, and attend meeting	1.30	266.50
Total Services:			\$	483.00

EDUCATION - 41.00
BOUNDARY CHANGES - 61.50

For All Disbursements As Follows:

10/13/2022	Troy J. Gilchrist - Mileage		8.75
Total Disbursements:			\$ 8.75

Total Services and Disbursements: \$ 491.75

→ SC EDUCATION - 22.80

→ SC EDUCATION - 20.50

WM EDUCATION - 20.50

SC 4th Gen Plan - 61.50

Kennedy & Graven, Chartered

150 South Fifth Street, Suite 700
Minneapolis, MN 55402

(612) 337-9300
41-1225694

November 20, 2022
Statement No. 171142

West Mississippi Watershed Management Commission

JASS - Watershed Administrators
3235 Fernbrook Lane
Plymouth, MN 55447

Through October 31, 2022

WE405-00001 General

427.95

Total Current Billing: 427.95

I declare, under penalty of law, that this account, claim or demand is just and correct and that no part of it has been paid.

DocuSigned by:

Troy J. Gilchrist

07P85C6P0P20444

Signature of Claimant

General - 366.45
4th Gen Plan - 61.50

Kennedy & Graven, Chartered

150 South Fifth Street, Suite 700
Minneapolis, MN 55402

West Mississippi Watershed

October 31, 2022

WE405-00001 General

Through October 31, 2022

For All Legal Services As Follows:

			Hours	Amount
10/4/2022	SMM	Work on Records Retention Policy; conduct research	0.70	79.80
10/6/2022	SMM	Make edits to records retention policy	0.10	11.40
10/10/2022	TJG	Work on resolution to consent to boundary changes	0.30	61.50
10/13/2022	TJG	Prepare for, travel to, and attend meeting	1.30	266.50
Total Services:			\$	419.20

For All Disbursements As Follows:

10/13/2022	Troy J. Gilchrist - Mileage	8.75
Total Disbursements:		\$ 8.75

Total Services and Disbursements: \$ 427.95

→ Wm 4th Gen Plan 61.50

G0203 001
 DEPT OF ADMIN/PMD
 MINNESOTA'S BOOKSTORE
 50 SHERBURNE AVENUE, SUITE 309
 ST. PAUL MN 55155



Customer No: 7002132
 Payment Terms: Due in 30
 Due Date: December 31, 2022
 Invoice: 00000725551
 Invoice Date: December 1, 2022
 From Date: November 28, 2022 To Date: November 28, 2022
 Purchase Order:
 Page: 1 of 1

Bill To:
 W MISSISSIPPI WATERSHED
 ACCOUNTS PAYABLE
 3235 Fernbrook Ln.
 Plymouth MN 55447

AMOUNT DUE: 69.00

For billing questions, please call 651-201-3204

Original

Line	Identifier	Description	Qty	UOM	Unit Amt	Net Amount
1		State Register Vol. 47 #22	4.00	EA	13.50	54.00
		Request for Interest Proposals - Professional Services for Legal, Engineering and Technical, and Administrative Consulting				
2		Affidavit	1.00	EA	15.00	15.00
					Subtotal:	69.00
					Amount Due:	69.00

Bill To:
 W MISSISSIPPI WATERSHED
 ACCOUNTS PAYABLE
 3235 Fernbrook Ln.
 Plymouth MN 55447

Customer No: 7002132
 Payment Terms: Due in 30
 Due Date: December 31, 2022

Address Change? If yes, Check box. →
 Write correct address on back.

Please Remit To:
 DEPT OF ADMIN/PLANT MANAGEMENT
 MINNESOTA'S BOOKSTORE
 50 SHERBURNE AVENUE
 SUITE 309
 ST. PAUL MN 55155

Amount Due: 69.00

Amount Remitted

G0203 7002132ZZZZZZZZ 0 00000725551ZZZZZZZZZZ 9 0000006900



INVOICE

Invoice Number 2012524
Invoice Date December 2, 2022
Purchase Order —
Customer Number 165866
Project Number 227704735

Bill To

West Mississippi Watershed Management Commission
 Judie Anderson
 3235 Fernbrook Lane
 Plymouth MN 55447
 United States

Please Remit To

Stantec Consulting Services Inc. (SCSI)
 13980 Collections Center Drive
 Chicago IL 60693
 United States

Project	WMWD 2022 General Engineering Services			
Project Manager	Spector, Diane F	Contract Upset		33,500.00
Current Invoice Total (USD)	4,099.74	Amount Billed to Date		32,306.31
		For Period Ending		November 25, 2022

Top Task	100	2022 General Engineering		
<u>Professional Services</u>				
Category/Employee		Current Hours	Rate	Current Amount
	Clapp, Lucas W	2.00	120.00	240.00
	Kemmitt, Kathrine Lee (Katie)	8.25	135.00	1,113.75
	Spector, Diane F	10.00	187.00	1,870.00
	Shoemaker, Todd E	4.00	207.00	828.00
	Subtotal Professional Services	<u>24.25</u>		<u>4,051.75</u>
Disbursements				
	Direct - Vehicle (mileage)			45.00
	Direct - Printing			2.99
	Subtotal Disbursements			<u>47.99</u>
Top Task Subtotal	2022 General Engineering			4,099.74
Total Fees & Disbursements				<u>4,099.74</u>
INVOICE TOTAL (USD)				4,099.74

Due upon receipt or in accordance with terms of the contract



INVOICE

Invoice Number	2012202
Invoice Date	December 2, 2022
Purchase Order	-
Customer Number	165866
Project Number	227704739

Bill To

West Mississippi Watershed Management Commission
 Judie Anderson
 3235 Fernbrook Lane
 Plymouth MN 55447
 United States

Please Remit To

Stantec Consulting Services Inc. (SCSI)
 13980 Collections Center Drive
 Chicago IL 60693
 United States

Project	WMWD 2022 Project Reviews			
	Project Manager	Shoemaker, Todd E	Contract Upset	30,000.00
	Current Invoice Total (USD)	3,118.50	Amount Billed to Date	23,983.99
			For Period Ending	November 25, 2022

Top Task	100	General		
Low Task	100	General		
Professional Services				
Category/Employee			Current Hours	Rate
		Spector, Diane F	3.00	187.00
		Subtotal Professional Services	<u>3.00</u>	<u>561.00</u>
Low Task Subtotal	General			561.00
Top Task Subtotal	General			561.00

Top Task	200	WCA		
Low Task	200	WCA		
Professional Services				
Category/Employee			Current Hours	Rate
		Kaster, Anthony R (Tony)	11.25	181.00
		Subtotal Professional Services	<u>11.25</u>	<u>2,036.25</u>
Low Task Subtotal	WCA			2,036.25
Top Task Subtotal	WCA			2,036.25

Top Task	300	Project Reviews		
Low Task	300.006	WM2022-06 Gateway Regional Park		
Professional Services				
Category/Employee			Current Hours	Rate
		Clapp, Lucas W	3.50	120.00
		Gartman, Cody	0.75	135.00



INVOICE

Invoice Number 2012202
Invoice Date December 2, 2022
Purchase Order
Customer Number 165866
Project Number 227704739

Subtotal Professional Services 4.25 521.25

Low Task Subtotal **WM2022-06 Gateway Regional Park** 521.25

Top Task Subtotal Project Reviews 521.25

Total Fees & Disbursements 3,118.50
INVOICE TOTAL (USD) **3,118.50**

Due upon receipt or in accordance with terms of the contract



INVOICE

Invoice Number 2012160
Invoice Date December 2, 2022
Purchase Order —
Customer Number 165866
Project Number 227704740

Bill To

West Mississippi Watershed Management Commission
 Judie Anderson
 3235 Fernbrook Lane
 Plymouth MN 55447
 United States

Please Remit To

Stantec Consulting Services Inc. (SCSI)
 13980 Collections Center Drive
 Chicago IL 60693
 United States

Project	WMWD 2022 Stream and Outfall Monitoring		
Project Manager	Kemmitt, Katie	Contract Upset	22,600.00
Current Invoice Total (USD)	1,904.13	Amount Billed to Date	6,886.04
		For Period Ending	November 25, 2022

Top Task	100	2022 Stream and Outfall Monitoring		
<u>Professional Services</u>				
Category/Employee		Current Hours	Rate	Current Amount
	Stone, Alicia L (Ali)	15.25	124.00	1,891.00
	Subtotal Professional Services	<u>15.25</u>		<u>1,891.00</u>
Disbursements				
	Usage - Vehicle			13.13
	Subtotal Disbursements			<u>13.13</u>
Top Task Subtotal	2022 Stream and Outfall Monitoring			1,904.13
	Total Fees & Disbursements			<u>1,904.13</u>
	INVOICE TOTAL (USD)			1,904.13

Due upon receipt or in accordance with terms of the contract



3235 Fernbrook Lane
Plymouth MN 55447

Shingle Creek / West Mississippi Watershed Management Commissions
3235 Fernbrook Lane
Plymouth, MN 55447

December 5, 2022

	Share	G/L	Shingle Creek			West Mississippi			Total Project Area		
			SC	WM		SC	WM	SC	WM		
Administrative	70-30	53001	46.09	70.00	2,258.41	70.00	967.89				
Administrative		53001	0.25	70.00	17.50	0.25	70.00	17.50			
Admin - offsite	70-30	53001	2.50	75.00	131.25		75.00	56.25			
Annual Storage Rental - .14/.11		53001	1.00	50.54	50.54	1.00	39.71	39.71			
Office Support	70-30	53001	18.00	70.00	882.00		70.00	378.00			
Data Processing/File Mgmt	70-30	53001	1.50	70.00	73.50		70.00	31.50			
Admin Reimbursables		53001	479.84	1.00	479.84	211.58	1.00	211.58	3,893.040	1,702.430	
Bookkeeping		54022		65.00	-		65.00	-			
Bookkeeping		54022	2.91	70.00	203.70	1.50	70.00	105.00			
Audit Prep		54022		70.00	-		70.00	-	203.700	105.000	
Meal Expense	70-30	54001	369.98	1.00	258.99		70.00	110.99	258.986	110.994	
Project / WCA Reviews - Admin		53002	0.17	70.00	11.90	0.58	70.00	40.60			
Project Reviews - File Mgmt		53002		60.00	-		60.00	-			
Reimbursable Expenses		53002	1.33	1.00	1.33	5.00	1.00	5.00	13.230	45.600	
Education - Admin	50-50	57008	0.500	70.00	17.50		70.00	17.50			
Education Reimbursables	50-50	57008	4.44	1.00	4.44	4.44	1.00	4.44	21.940	21.940	
Engrg Support 4G Plan - Secre	70-30	53004		65.00	-		65.00	-			
Engrg Support 4G Plan - Admin	70-30	53004	3.16	70.00	154.84		70.00	66.36			
Engrg Support 4G Plan - Offsite	70-30	53004		75.00	-		75.00	-			
Engrg Support 4G Plan Rembursab	70-31	53004		1.00	-		1.00	-	154.840	66.360	
Engineering Support - Secre	70-30	53004		65.00	-		65.00	-			
Engineering Support - Admin	70-30	53004	24.92	70.00	1,221.08		70.00	523.32			
Engineering Support -offsite	70-30	53004	1.65	75.00	86.63		75.00	37.13			
Engineering Support Rembursables		53004	89.48	1.00	89.48		1.00	-	1,397.185	560.445	
Engrg Support 3G Plan - Secre	70-30	53004		65.00	-		65.00	-			
Engrg Suppor3G Plan - Admin	70-30	53004		70.00	-		70.00	-			
Engrg Support3G Plan - Offsite	70-30	53004		75.00	-		75.00	-			
Engrg Suppor3G Plan Rembursable	70-31	53004		1.00	-		1.00	-	0.000	-	
Engineering Support - CIP -Secre	50-50	53004		50.00	-		50.00	-			
Engineering Support - CIP Admin		53004	0.81	65.00	52.65		65.00	-			
Engineering Support - CIP Admin	50-50	53004		70.00	-		70.00	-			
Engineering Support - CIP	50-50	53004		70.00	-		70.00	-			
Engineering Support - CIP Rembursables		53004	0.17	1.00	0.17	0.17	1.00	0.17	52.820	0.170	
					5,995.74			2,612.94	5,995.741	2,612.939	

Highland Gables: Clean Water and Connection

December 8, 2023

Shingle Creek Watershed Management Commission



by Maggie Wiebe

DWELL MANAGEMENT GROUP



Current

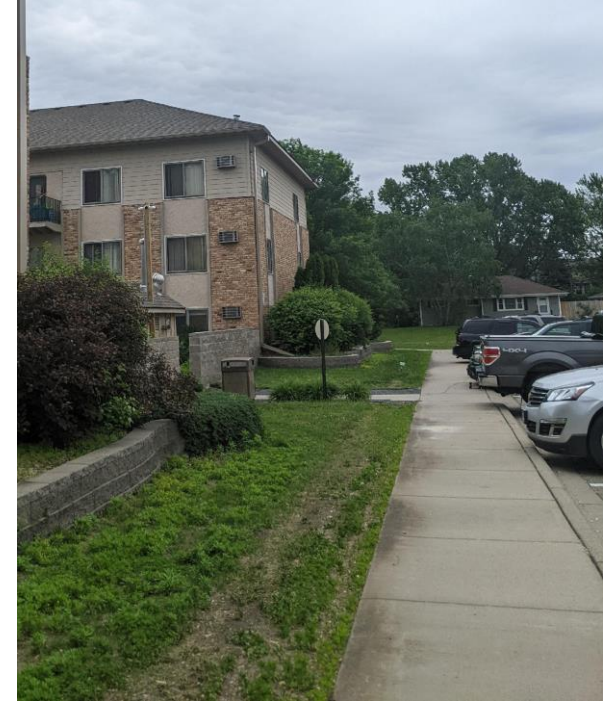

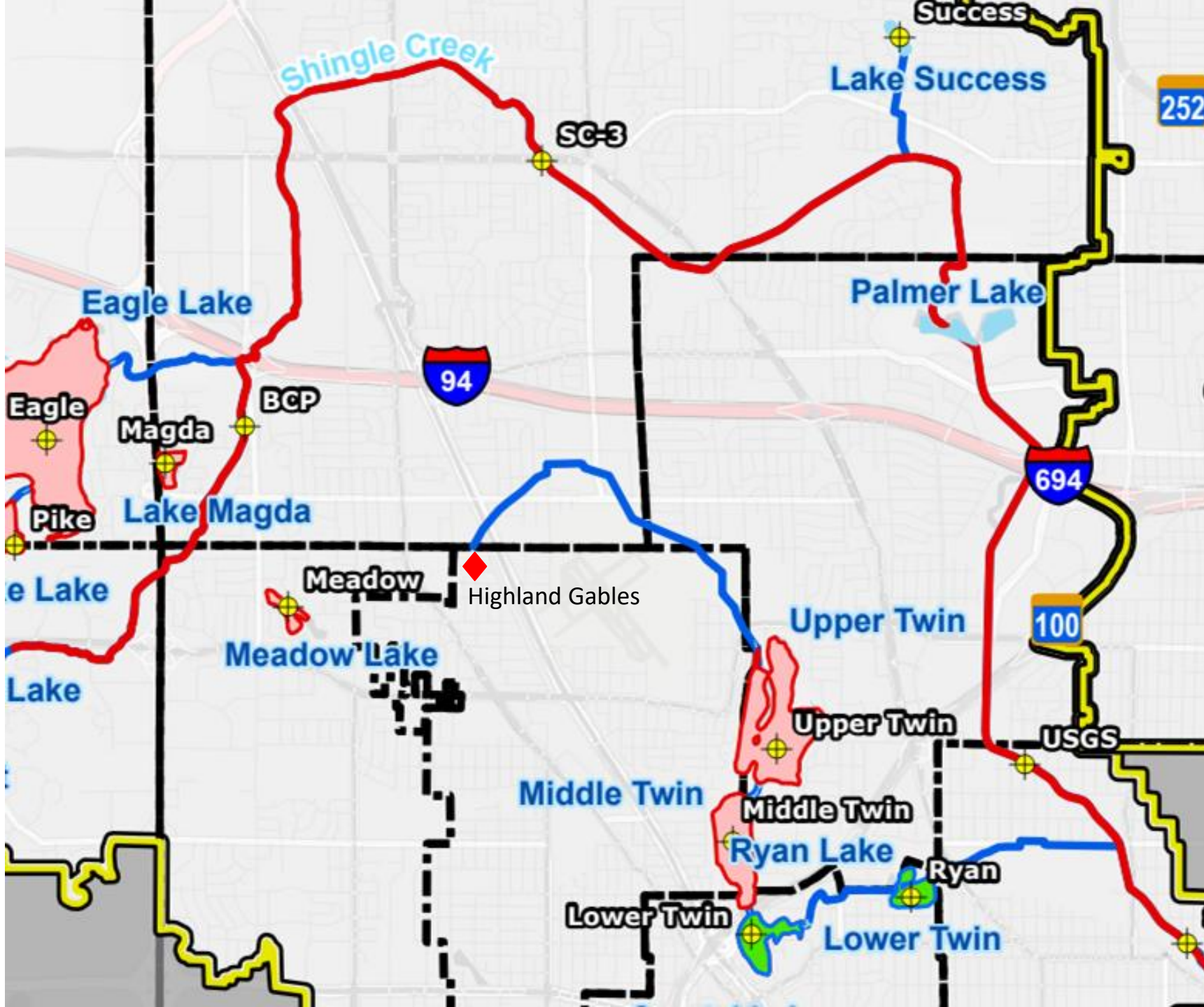

Equitable Engagement



Design Co-Creation

CIRCULATION/ SURFACE/MATERIAL



LANDSCAPE ELEMENTS



RAIN GARDEN DETAIL

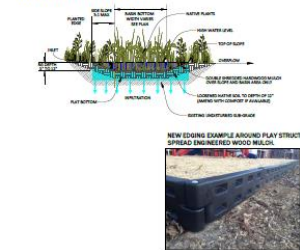

COMMUNITY AMENITIES



NEW PLAY ELEMENTS



LEGEND

- New Concrete
- Decomposed granite
- Native Plantings
- Fescue mix
- Rain garden Basin Bottom
- Channel Drain
- Drainage Arrow
- 6-foot Bench without back
- Trash Can
- Security Camera
- New Pedestrian Light - Shoe Box Style / 10' Ht.
- Remove existing Ash trees, stumps and roots to 18" depth
- Existing Security Camera
- 6-foot Bench without back
- DOWNSPOUT EXTENSION ALUMINUM EDGING: XXX LF
- Existing trees
- New Shade trees



Metro Blooms
Design+Build
www.metroblooms.org

Highland Gables
6289 N Louisiana Avenue
Brooklyn, MN, 55428

ENVIRONMENTAL FEATURES



PARKING LOT STORMWATER



REVISION LOG		
NO.	DATE	DESCRIPTION

10-19-2022
Doc Set, ie: Construction Docs
Site Plan
L1



Phase 1: 2023 CONCEPT PLAN

CIRCULATION/ SURFACE/MATERIAL



LANDSCAPE ELEMENTS



RAIN GARDEN DETAIL



COMMUNITY AMENITIES



COMMUNITY GARDENS



LEGEND

- New Concrete
- Decomposed granite
- Native Plantings
- Fescue mix
- Rain Garden Basin Bottom
- Channel Drain
- Drainage Arrow
- 6-foot Bench without back
- Trash Can
- Security Camera
- New Pedestrian Light - Shoe Box Style / 10' H
- Remove existing Ash trees, stumps and roots to 18" depth
- Existing Security Camera
- 6-foot Bench without back
- DOWNSPOUT EXTENSION PHASE 1
- Existing trees
- New Shade trees

ENVIRONMENTAL FEATURES



POLLINATOR PLANTINGS AND RAINGARDENS



PARKING LOT STORMWATER



CHANNEL DRAIN

PRETREATMENT STRUCTURE

NEW PLAY ELEMENTS



NATURE PLAY



COVERED SEATING AREA / PROCA



BBQ STATIONS

Capture

STORMWATER REDUCTION CALCULATIONS

RAINGARDEN A:
 Area of Raingarden - 2171 sf
 Basin Area - 1534 sf
 Raingarden depth - 12"

31.44" Annual Precipitation - 95% Capture
 Runoff - 50843cu ft (380,332.08 gal.)
 Total Suspended Solids - 724.77 lbs
 Total Phosphorus - 1.787lbs

RAINGARDEN E:
 Area of Raingarden - 191 sf
 Basin Area - 111 sf
 Raingarden depth - 6"

31.44" Annual Precipitation - 93.35% Capture
 Runoff - 3631.2cu ft (28,564.81gal)
 Total Suspended Solids - 18.10 lbs
 Total Phosphorus - 0.028lbs

TOTAL PHASE 1
 31.44" Annual Precipitation - 95.28% Capture
 Runoff - 54474.2cu ft (407,495.34gal)
 Total Suspended Solids - 742.87 lbs
 Total Phosphorus - 1.814 lbs

MODELED WITH WinsLMM VERSION 10.5.77
 SANDY LOAM - 1.0 IN/HR

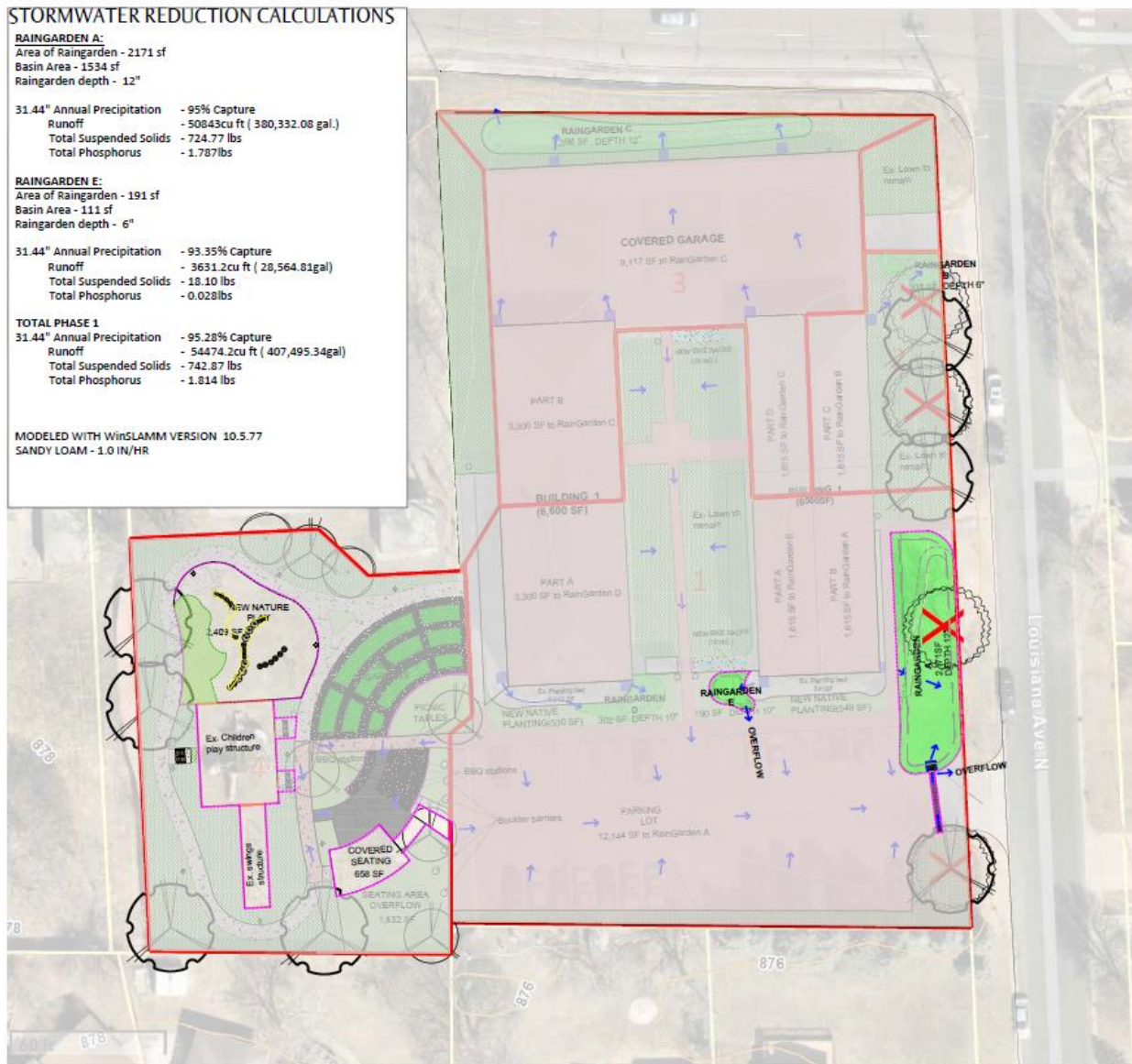

LEGEND

- New Concrete
- Decomposed granite
- Native Plantings
- Fescue mix
- Raingarden Basin Bottom
- Channel Drain
- Drainage Arrow
- 6-foot Bench with back
- Trash Can
- Security Camera
- New Pedestrian Light - Shoe Box Style / 10' ht.
- Remove existing Ash trees, stumps and roots to 18' depth
- Existing Security Camera
- 6-foot Bench without back
- DOWNSPOUT EXTENSION PHASE 1

AREA CALCULATIONS

TOTAL PROPERTY - 79,951sq ft / 1.84 acre
TOTAL IMPERVIOUS - 41,048 sq ft (51.34%)
Building - 22,217 sq ft
Parking / drive - 12,144 sq ft
Sidewalk/other impervious - 3,152 sq ft
New impervious surface - 3,535sq ft
TOTAL PERVIOUS
Lawn + Plant beds + Basins - 39,167sq ft(48.99%)
IMPERVIOUS to BMPs in Phase 1 Catchment :
24,604 sq ft
Building - 6,530 sq ft
Sidewalk - 2,510 sq ft
Parking Lot - 12,144 sq ft
BMPs - Rain Garden A and E
TOTAL IMPERVIOUS TREATED IN PHASE 1
sq ft 24,604 (100%)

Our modeling shows these proposed stormwater best management practices will lead to the annual capture of:

- 1.81 Total pounds of Phosphorus
- 742.87 lbs of solids
- 407,495.34 gallons of runoff annually

Funding Request: \$49,992.67

Match:

- **Brooklyn Park Community Grant: \$20,000**
- **Dwell Management: \$11,709.49**
- **Hennepin County Good Steward grant: \$24,955.00**
- **Lawns to Legumes Grant \$2,300**

Total Project Cost Estimate: \$ 108,957.16

Alex Brainard
Owner of Dwell Management
alex@dwellrochester.com

Chris Ototo
Landscape Designer, MLA
Chris@metroblooms.org

Laura Scholl
Executive Director
laura@metroblooms.org

Erin Bogle
Community Relations
erin@metroblooms.org

